

GOLD™ NA Catalog

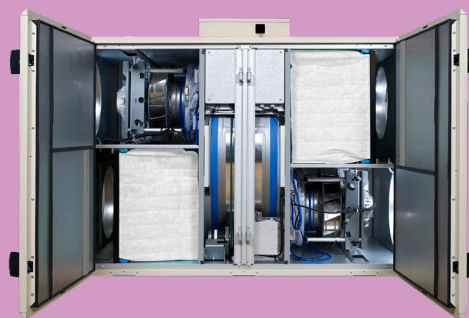

Application and Unit Selections

GOLD NA Air handling units with unbeatable advantages



RX Model

The GOLD RX (above) is our standard all-in-one air handling unit with direct-driven supply air and return air fans, supply air and return air filters and a rotary heat exchanger.

PX Model

The GOLD PX model has all the same features found in our RX model but utilizes a plate type heat exchanger for a more complete separation of supply and exhaust airstreams. Swegon's advanced controls optimize heat recovery while avoiding frost issues.

SD Model

The GOLD SD model includes a run around coil for heat recovery. It allows the designer to ensure complete separation of supply and return airflows. It also allows multiple supply and exhaust airstreams to be connected with the AHUs in different locations in the building.

GOLD NA Air handling units with unbeatable advantages

**GOLD is no ordinary air handling unit.
In fact, there's nothing else like it.**

GOLD enables designers to re-think system design to significantly improve comfort, reduce operating costs, and maximize usable space. Its extra small footprint and ultra-low sound levels make it possible to place air handling units in non-traditional spaces such as in close proximity to occupied rooms. With GOLD, designers can reap the full benefits of decentralized system design. In addition to maximizing usable space, decentralized design also allows smaller plenums and shafts (smaller ducts), individual tenant metering, flexible tenant time scheduling and reduced sound and energy consumption. Combining both unit and controls optimization, GOLD provides unparalleled energy efficiency levels, reliable operation, and fast commissioning.

This state-of-the-art technology is widely recognized in Europe and is now here in North America.

*GOLD RX is now Passive House certified. To learn more about Passive House, visit www.phius.org or www.passivehouse.ca

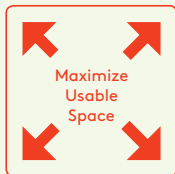

Smallest Footprint

The GOLD Dedicated Outdoor Air System unit has the smallest footprint in the market. Up to 40 ft² per unit can be saved and converted to leasable area. There will be no problem getting GOLD to fit.



Optimum operating economy

Energy-saving fans, efficient heat recovery and full control of temperatures, airflows and operating times provide optimum operating economy.



Sound Criteria and Comfort

GOLD has the lowest overall sound power levels of any unit in its class, achieving NC 35. By improving IAQ and thermal comfort, it also helps improve employee effectiveness and attendance.



Integrated Controls

The GOLD comes with integrated controls which have been installed in thousands of buildings across the globe. The controls are the brains behind the best-in-class efficiencies, providing unbeatable value of ease of specification, reliability, and total project cost.

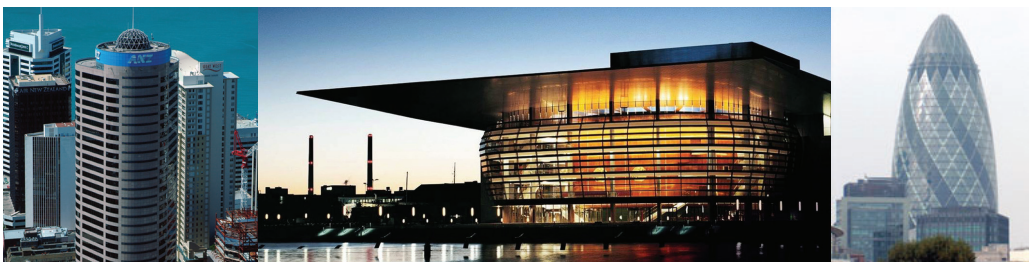

GOLD has been revolutionizing system design since 1992

Left to Right: ANZ Building Auckland, New Zealand, Copenhagen Opera House, 30 St. Mary Axe London

Application of this Guide

How to use this guide to help your customers

Application Example

A customer contacts you and wants to know;

Do you have an indoor DOAS unit for:

- Supply air 5000 cfm
- Exhaust air 5000 cfm
- Enthalpy wheel
- Inlet and exhaust air dampers
- Chilled water and hot water coils

If we can do this, what are the dimensions, the electrical and the weight?

Solution

The GOLD model with enthalpy wheel is a RX. On page RX 6, the size 30 has the correct airflow range both for ERV only and if the cooling coils are added. (A model can manage a larger airflow as just an ERV than when a cooling coil is added due to coil face velocity.)

From the table on RX 6, the core ERV unit is;

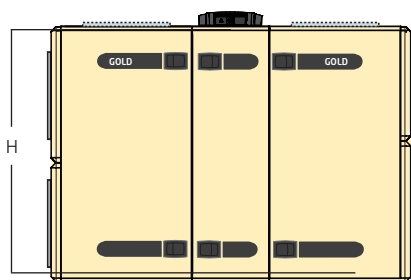

Model	Length (in)*	Width (in)	Height (in)	Weight (lbs)
RX 30	87.4	63	$62.8 + 4 + 4 = 70.8$	1740

* Note the length includes end panels for each end (2 inch thick each). The height is 4 inches for the control cabinet and 4 inches for the base rail (see drawing).



Model ACSA cased dampers can be found on page Ac 6. On page Ac 7, the dimensions for a size 30 ACSA are;

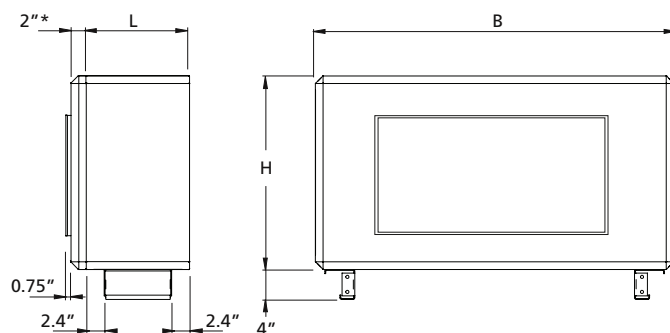

Model	Length (in)*	Width (in)	Height (in)	Weight (lbs)
RX 30	87.4	63	$62.8 + 4 + 4 = 70.8$	1740
ACSA 30 OA**	$13.9 + 2 = 15.9$	63	27.2	145
ACSA 30 EA	$13.9 + 2 = 15.9$	63	35.7	163

** For sizes 14 to 40, the filter height is taller than the fan height. Assuming the OA enters at the bottom, the damper is the smaller and lighter cabinet. The length includes 2" for the end panel.

Application of this Guide

Solution

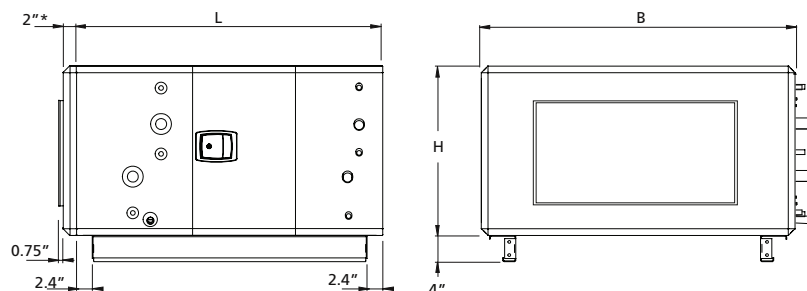

Model ACLK cased combination heating and cooling coil section can be found on page Ac 22.
On page Ac 23, the dimensions for a size 30 ACLK are;

Model	Length (inches)*	Width (inches)	Height (inches)	Weight (lbs)
RX 30	87.4	63	$62.8 + 4 + 4 = 70.8$	1740
ACSA 30 OA**	$13.9 + 2 = 15.9$	63	27.2	145
ACSA 30 EA**	$13.9 + 2 = 15.9$	63	35.7	163
ACLK 30***	$57.3 + 2" = 59.3$	63	35.7	860

*** The ACLK casing section comes in two lengths. The shorter length is for 4 and 6 row cooling coils while the longer length is for 8 and 10 row coils. To be safe, use the longer length at this early stage of the project. The length includes 2" for the end panel.

Overall Dimensions

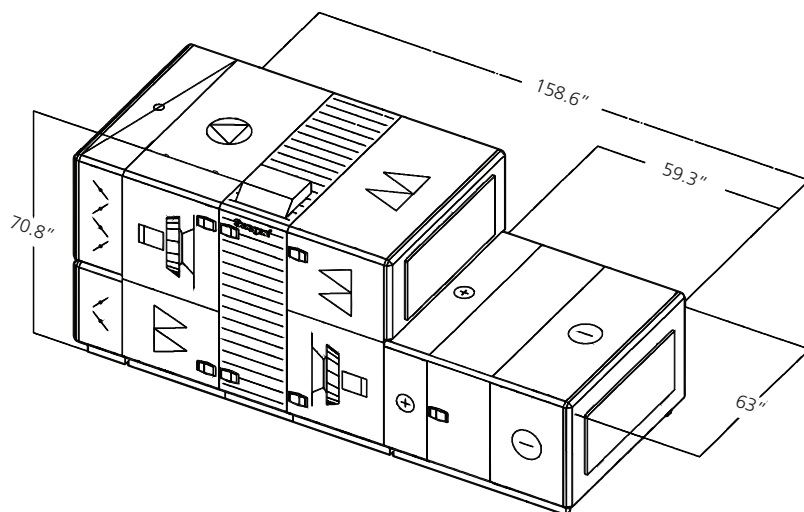

The unit dimensions are shown in the above figure.
The approximate weight is 2908 lbs.

On page RX 6, the electrical data for 460/3/60 power is;

Full Load Amps (FLA) = 15.6A

Minimum Circuit ampacity (MCA) = 17.4 A

Recommended Fuse Size (RFS) = 20 A

Model	Length (inches)*	Width (inches)	Height (inches)	Weight (lbs)
RX 30	87.4	63	$62.8 + 4 + 4 = 70.8$	1740
ACSA 30 OA**	$13.9 + 2 = 15.9$	63	27.2	145
ACSA 30 EA**	$13.9 + 2 = 15.9$	63	35.7	163
ACLK 30***	$57.3 + 2" = 59.3$	63	35.7	860
Total****	$87.4 + 13.9 + 57.3 = 158.6$	63	70.8	2908

**** Note the length for the RX 30 includes the 2 inches for the end panels. When an accessory such as the cased dampers or combination coil section are added, the end panel is removed and the section bolted directly to the cabinet.

Components and Accessories

Unit Sections

ACBR Air recirculation section

The ACBR consists of an extra unit section that has a motor-driven damper (on/off or modulated) in its intermediate deck.

The ACBR air recirculation section is available for the size 11 and larger GOLD RX and PX units. The GOLD PX cannot be used for the ReCO₂ function.

The following is included in the supply:

Air recirculation section. Mounted actuator for damper. Necessary extension wiring for the supply air fan.

Requirement for additional equipment:

Depending on how the air recirculation section is to be used, it may also be necessary to install extra sensors for reading the pressure, room temperature, CO₂ content, heating and/or cooling coil temperatures and the status of shut-off dampers for exhaust air and outdoor air.

Operation:

Recirculation, on/off: Can be used if you want to heat an unoccupied room with recirculated air – an economic solution for factory buildings, shopping centres, etc. for instance.

The intermittent night-time heating function stops the return air fan and heat recovery, closes the shut-off dampers for outdoor air and exhaust air and opens the damper in the air recirculation section. See also the section "Control functions".

Recirculation, modulating: Can be used for the demand-controlled and economical operation of fans, heating and cooling, especially in buildings in which the load varies.

The patent-pending ReCO₂ function adjusts the air quality (in response to signals from CO₂ sensors) and temperature by steplessly controlling the shut-off dampers and the damper in the air recirculation section as well as the speed of the fans. See also the section "Control functions".

The ReCO₂ function requires the accessory: ABLZ-2-51 Complete set of components for controlling the function for mixing (ReCO₂). Pressure sensors and the IQlogic⁺ are included. Air quality sensor must be ordered separately.

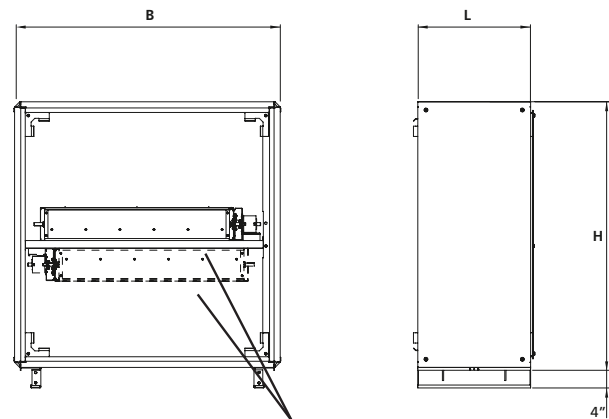
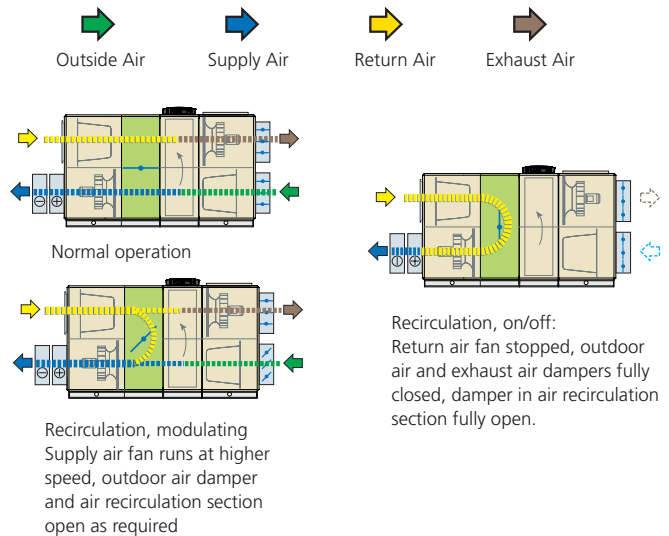
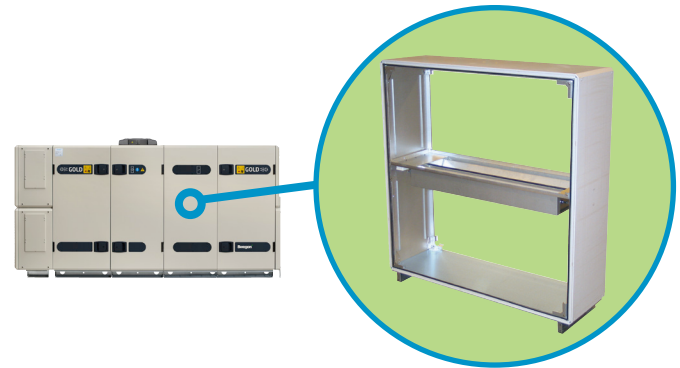

Depending on the version, the damper can be mounted in the upper or lower level.

GOLD	B	H	L	lbs
11/12	47.3	51	21.7	197
14/20	55.1	54.9	21.7	215
25/30	63	62.8	21.7	241
35/40	78.3	78	21.7	295
50/60	91.3	88.7	22.4	456
70/80	103.8	104	22.4	480

Components and Accessories

Duct Accessories, in insulated casing

Common for duct accessories in an insulated casing

The duct accessories are to be positioned outside the GOLD unit. The unique Wing+ fans in the GOLD air handling unit also make it possible to connect duct accessories directly to the duct connection of the GOLD air handling unit without pressure losses or non-uniform air distribution.

Duct accessories in an insulated casing must be used if the unit is installed outdoors.

Duct accessories for the GOLD are equipped with bolt joints and/or expansion-type locking devices for docking them to the air handling unit and/or other duct accessories.

One duct accessory can be mounted on top of another duct accessory.



Components and Accessories

Duct Accessories, in insulated casing

ACSA Damper section

ACSA dampers are used as shut-off dampers or forced airflow dampers. Sizes 12–80 can also be used for other applications, such as outdoor air dampers for the ReCO2 control function. Shut-off dampers are normally used if the air handling unit is idle during some period, for example at night, or if an air heater for hot water without anti-frost burst protection is used.

To be installed for horizontal airflow.

Complete with damper actuator for 24 V. The actuator can be selected with two position spring return. ACSA sizes 12–80 are also available with modulating type actuator with spring return.

Technical data

Insulated casing. The outer skin is made of galvanized sheet steel painted in a beige colour tone. The inner skin is made of galvanized sheet steel. Environmental class C4. Tightness class 3 to EN 1751.

Installation

The damper section should be mounted directly against the air handling unit or insulated duct accessory.

Wire the control and power supply cables to the appropriate wiring terminal on the air handling unit.



Components and Accessories

Duct Accessories, in insulated casing

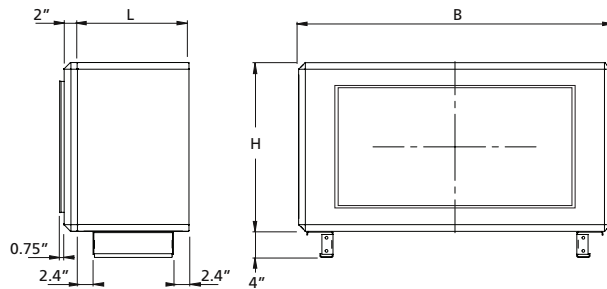

Size	ACSA	B	H	L	lbs	End connection Panel, if required. Lbs
05	1-05	32.4	18.1	13.9	73	15
07/08	1-08	39.2	21.3	13.9	84	22
11/12	1-12	47.3	25.5	16.9	120	29
14/20	1-20	55.1	30.6/24.4	13.9	145/134	42/33
25/30	1-30	63	35.7/27.2	13.9	163/145	51/38
35/40	1-40	78.3	42.5/35.7	16.9	203/190	68/58

The base frame is always supplied in assembled condition. If the duct accessory is fitted to the upper ductwork, above the duct accessory fitted to the lower ductwork, remove the base beams to the extent necessary, at the building site.

* If several duct accessories are arranged in succession, the end connection panel is supplied only on the duct accessory farthest out facing the ductwork.

Connection dimensions to duct:

ACSA 05	12" x 18"
ACSA 08	14" x 24"
ACSA 12	18" x 32"
ACSA 20	16" x 40"
ACSA 30	20" x 48"
ACSA 40	24" x 56"

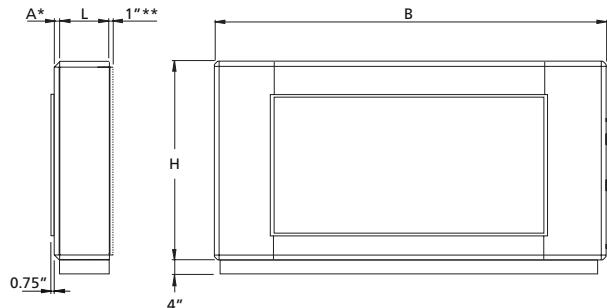

Size	ACSA	B	H	L	A	lbs	End connection Panel, if required. Lbs
50/60	1-60	91.3	44.4	21.3	1.1	312	70
70/80	1-80	103.8	52	21.3	2	420	84

The base frame is always supplied in assembled condition. If the duct accessory is fitted to the upper ductwork, above the duct accessory fitted to the lower ductwork, remove the base beams to the extent necessary, at the building site.

* If several duct accessories are arranged in succession, the end connection panel is supplied only on the duct accessory farthest out facing the ductwork.

** Size 60 only

Connection dimensions to duct:

ACSA 60	32" x 64"
ACSA 80	40" x 72"

Components and Accessories

Duct Accessories, in insulated casing

ACLA Hot Water Coil Section

The ACLA is used for reheating the supply air. The heater uses hot water as the heating medium.

In many applications it is possible to omit the air heater for reheat if the air handling unit control system is operated in the temperature regulation mode according to the ERS model and when the efficient rotary heat exchanger is in use.

To be installed for horizontal airflow.

Technical data

Insulated casing. The outer skin is made of galvanized sheet steel painted in a beige colour tone. The inner skin is made of galvanized sheet steel.

Finned-tube heat exchangers fabricated of copper tubes and profiled aluminium fins. The headers and the pipework to the water connections are made of copper. The male threaded pipe connections are made of steel.

All the air heaters are equipped with individual plugs for venting and drainage.

Valve set

The ABVL valve set with 2-way valve, actuator, anti-frost protection sensor and connection cable can be ordered.

Installation

The air heater should be mounted directly against the air handling unit or insulated duct accessory.



Basic Installation Diagram

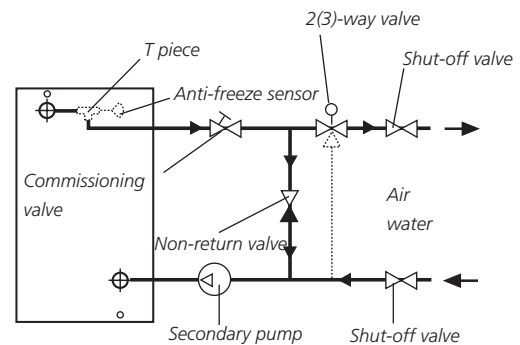

1) The anti-frost protection sensor for the size 05-12 ACLA should be installed in the T-piece on the return pipework and for the size 14-120 ACLA in the connection on the air heater.

Components and Accessories

Duct Accessories, in insulated casing

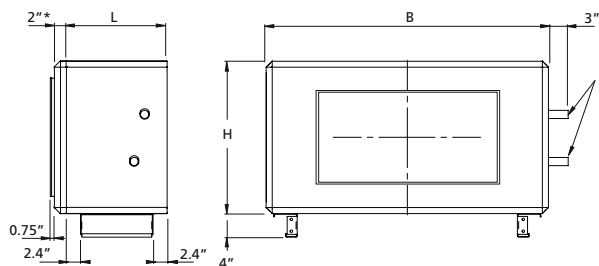

Conn. R male threads. Vents and drain mounted on inlet/outlet connections.

The base frame is always supplied in assembled condition. If the duct accessory is fitted to the upper ductwork, above the duct accessory fitted to the lower ductwork, remove the base beams to the extent necessary, at the building site.

* If several duct accessories are arranged in succession, the end connection panel is supplied only on the duct accessory farthest out facing the ductwork.

Size	ACLA	B	H	L	lbs	End connection Panel, if required. Lbs
05	1-05	32.4	18.1	13.9	59	15
08	1-08	39.2	21.3	13.9	75	22
11/12	1-12	47.3	25.5	16.9	123	29

Connection dimensions to duct:

ACLA 05 12" x 18"

ACLA 08 14" x 24"

ACLA 12 18" x 32"

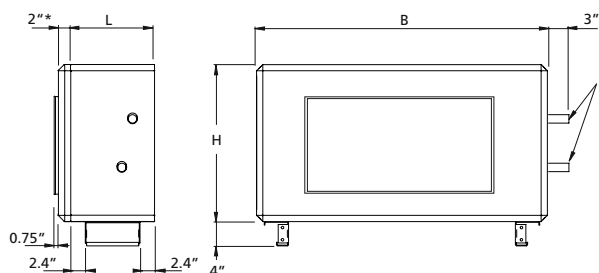

Conn. R male threads. Vents and drain mounted on inlet/outlet connections.

The base frame is always supplied in assembled condition. If the duct accessory is fitted to the upper ductwork, above the duct accessory fitted to the lower ductwork, remove the base beams to the extent necessary, at the building site.

* If several duct accessories are arranged in succession, the end connection panel is supplied only on the duct accessory farthest out facing the ductwork.

Size	ACLA	B	H	L	lbs	End connection Panel, if required. Lbs
14/20	1-20	55.1	30.6	13.9	137	42
25/30	1-30	63	35.7	13.9	170	51
35/40	1-40	78.3	42.5	16.9	250	68

Connection dimensions to duct:

ACLA 20 16" x 40"

ACLA 30 20" x 48"

ACLA 40 24" x 56"

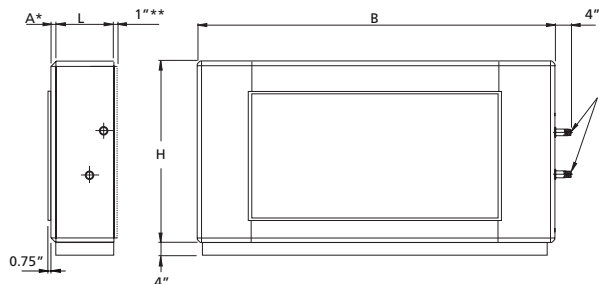

Conn. R male threads. Vents and drain mounted on inlet/outlet connections.

The base frame is always supplied in assembled condition. If the duct accessory is fitted to the upper ductwork, above the duct accessory fitted to the lower ductwork, remove the base beams to the extent necessary, at the building site.

* If several duct accessories are arranged in succession, the end connection panel is supplied only on the duct accessory farthest out facing the ductwork.

** Size 60 only

Size	ACIA	B	H	L	A	lbs	End connection Panel, if required. Lbs
50/60	1-60	91.3	44.4	21.3	1.1	250	70
70/80	1-80	103.8	52	21.3	2	300	84

Connection dimensions to duct:

ACLA 60 32" x 64"

ACLA 80 40" x 72"

Components and Accessories

Duct Accessories, in insulated casing

ACLF Hot Water Preheat Coil Section

The ACLF is used for preheating the supply air. The heater uses hot water as the heating medium. Install the ACLF against the outdoor air duct.

Comes with 2" MERV 8 pleated pre-filter for protection of the coil and optional internal mounting of outdoor air damper.

When it is cold outside and the humidity is high, preheating the incoming outdoor air will prevent condensation in the air filters. The function can also be utilised when it is extremely cold outdoors and it is desirable to heat the air up to -4°F, for instance.

In combination with the plate heat exchanger, it can also be of interest to preheat the air to be spared having to let it bypass the heat exchanger.

To be installed for horizontal airflow.

Technical data

Insulated casing. The outer skin is made of galvanized sheet steel painted in a beige colour tone. The inner skin is made of galvanized sheet steel.

Finned-tube heat exchangers fabricated of copper tubes and profiled aluminium fins. The headers and the pipework to the water connections are made of copper. The male threaded pipe connections are made of steel.

Valve set

The ABVL valve set with 2-way valve actuator, freeze protection sensor and connection cable can be ordered.

Extra accessories

Control system, including temperature sensor for duct and IQlogic+ with or without frost guard sensor.

Installation

The air heater should be mounted directly against the air handling unit or insulated duct accessory.

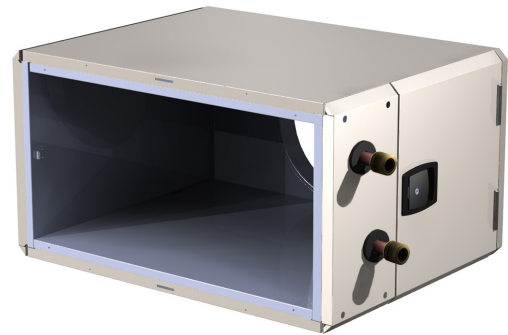

Components and Accessories

Duct Accessories, in insulated casing

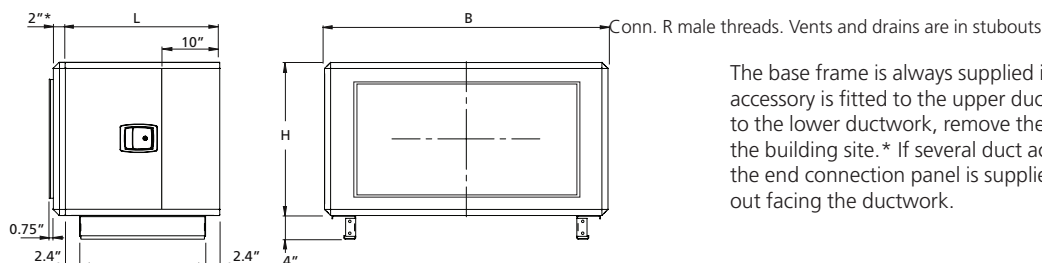

The base frame is always supplied in assembled condition. If the duct accessory is fitted to the upper ductwork, above the duct accessory fitted to the lower ductwork, remove the base beams to the extent necessary, at the building site. * If several duct accessories are arranged in succession, the end connection panel is supplied only on the duct accessory farthest out facing the ductwork.

Size	ALCF	B	H	L	lbs	End connection Panel, if required. Lbs
05	1-05	32.4	18.1	28.5	53	15
08	1-08	39.2	21.3	28.5	66	22
11/12	1-12	47.3	25.5	16.9	123	29

Connection dimensions to duct:

ACLF 05	12" x 18"
ACLF 08	14" x 24"
ACLF 12	18" x 32"

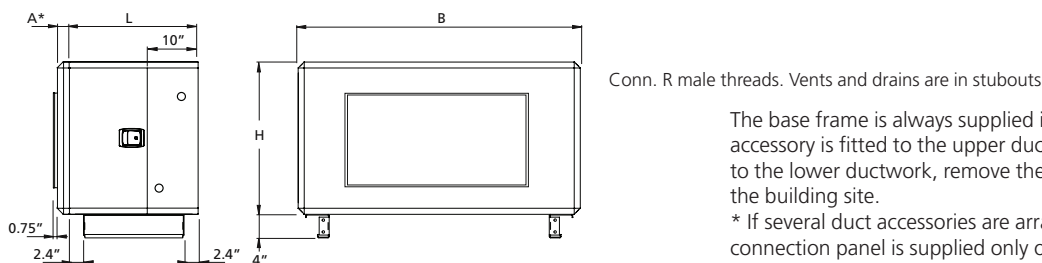

The base frame is always supplied in assembled condition. If the duct accessory is fitted to the upper ductwork, above the duct accessory fitted to the lower ductwork, remove the base beams to the extent necessary, at the building site.

* If several duct accessories are arranged in succession, the end connection panel is supplied only on the duct accessory farthest out facing the ductwork.

Size	ALCF	B	H	L	A	lbs	End connection Panel, if required. Lbs
14/20	1-20	55.1	30.6	28.5	2	137	42
25/30	1-30	63	35.7	28.5	2	170	51
35/40	1-40	78.3	42.5	28.5	2	250	68
50/60	1-60	91.3	44.4	21.3	1.1	250	70
70/80	1-80	103.8	52	21.3	2	300	84

Connection dimensions to duct:

ACLF 20	16" x 40"
ACLF 30	20" x 48"
ACLF 40	24" x 56"
ACLF 60	32" x 64"
ACLF 80	40" x 72"

Components and Accessories

Duct Accessories, in insulated casing

ACKA Chilled Water Coil Section

ACKC DX Coil Section

The ACKA/ACKC air coolers are used for cooling the supply air with chilled water or evaporative refrigerant as the cooling medium.

To be installed for horizontal airflow.

Technical data

Insulated casing. The outer skin is made of galvanized sheet steel painted in a beige colour tone. The inner skin is made of galvanized sheet steel.

The ACKA/ACKC air coolers are composed of copper tubes and profiled aluminium fins. The ACKA has headers and water connections made of copper, with male connection threads. The ACKC has headers and distributor tubes made of copper. The connections are designed for brazed joints.

All cooling coils come standard with a double sloped stainless steel drain pan with a ½" NPT drain pipe stubout. There is also the option for mist eliminator, where applicable.

Valve set

The ABVL valve set with 2-way valve actuator, freeze protection sensor (for readings only) and connection cable can be ordered.

Installation

The air cooler should be mounted directly against the air handling unit or insulated duct accessory.

Connect the drainage pipework.



Components and Accessories

Duct Accessories, in insulated casing

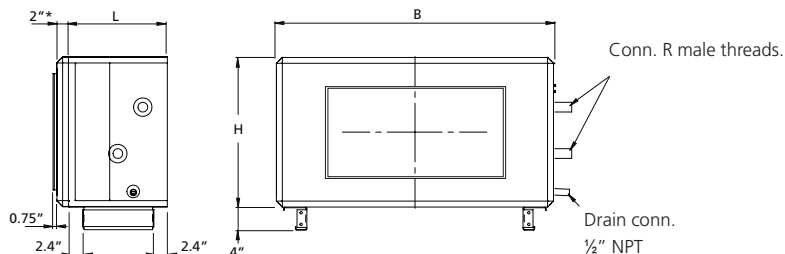

The base frame is always supplied in assembled condition. If the duct accessory is fitted to the upper ductwork, above the duct accessory fitted to the lower ductwork, remove the base beams to the extent necessary, at the building site.

* If several duct accessories are arranged in succession, the end connection panel is supplied only on the duct accessory farthest out facing the ductwork.

Size	ACKA	B	H	L (4,6 Row)	L (8, 10 Row)	lbs ¹⁾	End connection Panel, if required. Lbs
05	3-05	32.4	18.1	16.9	23.4	121	15
07/08	3-08	39.2	21.3	16.9	23.4	176	22
11/12	3-12	47.3	25.5	16.9	23.4	220	29
14/20	4-20	55.1	30.6	18.4	23.4	137	42
25/30	4-30	63	35.7	18.4	23.4	170	51
35/40	4-40	78.3	42.5	18.4	23.4	250	68

Connection dimensions to duct:

ACKA 05	12" × 18"
ACKA 08	14" × 24"
ACKA 12	18" × 32"
ACKA 20	16" × 40"
ACKA 30	20" × 48"
ACKA 40	24" × 56"

¹⁾ Excl. cooling medium

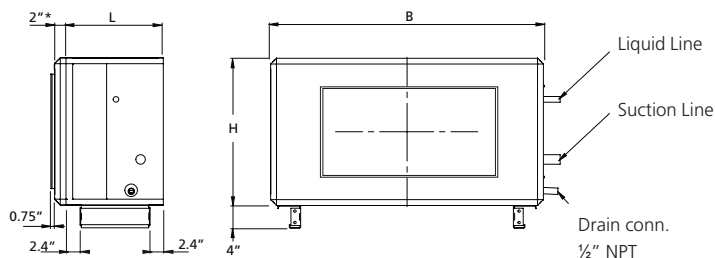

The base frame is always supplied in assembled condition. If the duct accessory is fitted to the upper ductwork, above the duct accessory fitted to the lower ductwork, remove the base beams to the extent necessary, at the building site.

* If several duct accessories are arranged in succession, the end connection panel is supplied only on the duct accessory farthest out facing the ductwork.

Size	ACKC	B	H	L (4,6 Row)	L (8, 10 Row)	lbs ¹⁾	End connection Panel, if required. Lbs
05	3-05	32.4	18.1	16.9	23.4	121	15
08	3-08	39.2	21.3	16.9	23.4	176	22
11/12	3-12	47.3	25.5	16.9	23.4	220	29
14/20	4-20	55.1	30.6	18.4	23.4	137	42
25/30	4-30	63	35.7	18.4	23.4	170	51
35/40	4-40	78.3	42.5	18.4	23.4	250	68

Connection dimensions to duct:

ACKC 05	12" × 18"
ACKC 08	14" × 24"
ACKC 12	18" × 32"
ACKC 20	16" × 40"
ACKC 30	20" × 48"
ACKC 40	24" × 56"

¹⁾ Excl. cooling medium

Components and Accessories

Duct Accessories, in insulated casing

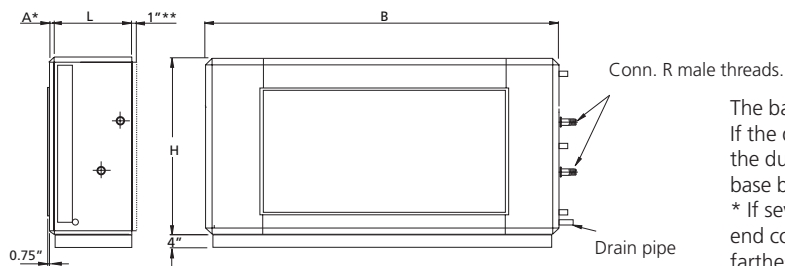

The base frame is always supplied in assembled condition. If the duct accessory is fitted to the upper ductwork, above the duct accessory fitted to the lower ductwork, remove the base beams to the extent necessary, at the building site.

* If several duct accessories are arranged in succession, the end connection panel is supplied only on the duct accessory farthest out facing the ductwork.

** Size 60 only

ACKA	B	H	L (4,6 Row)	L (8, 10 Row)	lbs ¹	End connection Panel, if required. Lbs
3-60	91.3	44.4	21.3	1.1	250	70
3-80	103.8	52	21.3	2	300	84

¹) Excl. cooling medium

Connection dimensions to duct:

ACKA 60 32" x 64"

ACKA 80 40" x 72"

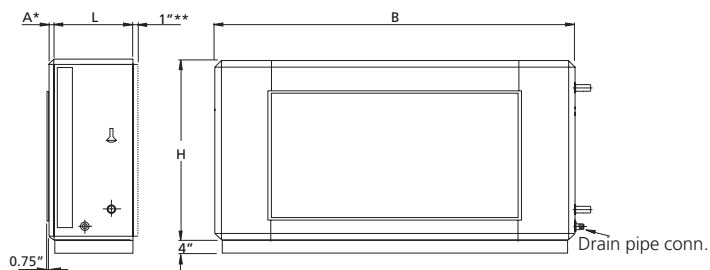

The base frame is always supplied in assembled condition. If the duct accessory is fitted to the upper ductwork, above the duct accessory fitted to the lower ductwork, remove the base beams to the extent necessary, at the building site.

* If several duct accessories are arranged in succession, the end connection panel is supplied only on the duct accessory farthest out facing the ductwork.

** Size 60 only

ACKC	B	H	L (4,6 Row)	L (8, 10 Row)	lbs ¹	End connection Panel, if required. Lbs
4-60	91.3	44.4	21.3	1.1	250	70
4-80	103.8	52	21.3	2	300	84

¹) Excl. cooling medium

Connection dimensions to duct:

ACKC 60 32" x 64"

ACKC 80 40" x 72"

Components and Accessories

Duct Accessories, in insulated casing

ACLE Electric Air Heater

The ACLE electric air heater is used for reheating the supply air.

In many applications it is possible to omit the air heater for reheat if the air handling unit control system is operated in the temperature regulation mode according to the ERS model and when the efficient rotary heat exchanger is in use.

To be installed for horizontal airflow.

The integrated thyristor is controlled via signals from the GOLD air handling unit. A wiring harness for communication and overheat protection is provided.

Technical data

Insulated casing. The outer skin is made of galvanized sheet steel painted in a beige colour tone. The inner skin is made of galvanized sheet steel.

The ACLE air heater is available in several capacity variants.

Available in both indoor and outdoor NEMA rated enclosures.

Installation

The air heater should be mounted directly against the air handling unit or insulated duct accessory. The space necessary for obtaining a uniform air stream is provided inside the ACLE. Therefore other duct accessories can be fitted downstream of the ACLE without risk of overheating.

Electrical connection. **Electrical heaters require a separate dedicated power supply. Consult factory for single point power options.**

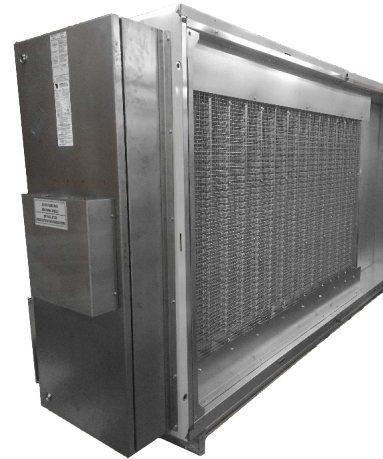

Components and Accessories

Duct Accessories, in insulated casing

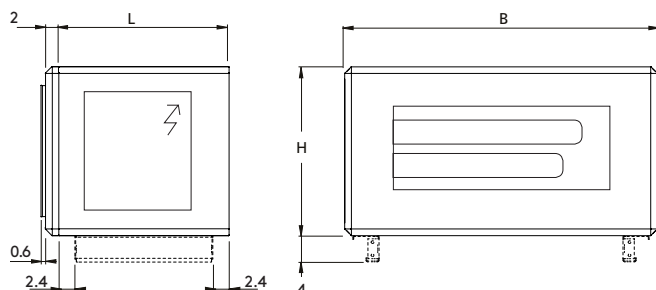

Connection dimensions to duct:

ACLE 05 12" × 18"

ACLE 08 14" × 24"

Base beams are options.

* If several duct accessories are arranged in succession, the end connection panel is supplied only on the duct accessory farthest out facing the ductwork.

ACLE	B	H	L	lbs	End connection panel, if required lbs
1-05	32.5	18.1	23.4	123	15
1-08	39.2	21.3	23.4	156	22

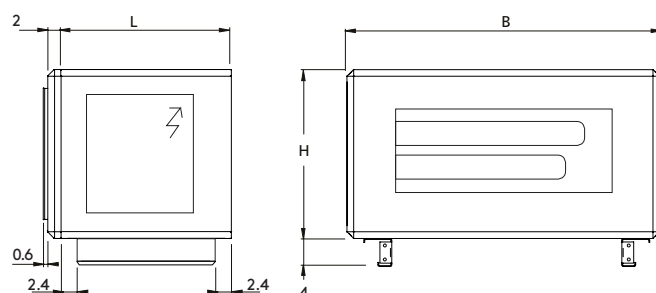

Connection dimensions to duct:

ACLE 12 18" × 32"

The base frame is always supplied in assembled condition. If the duct accessory is fitted to the upper ductwork, above the duct accessory fitted to the lower ductwork, remove the base beams to the extent necessary, at the building site.

* If several duct accessories are arranged in succession, in the end connection panel is supplied only on the duct accessory farthest out facing ductwork.

ACLE	B	H	L ¹⁾	lbs	End connection panel, if required lbs
1-12	47.2	25.5	23.4	257	29

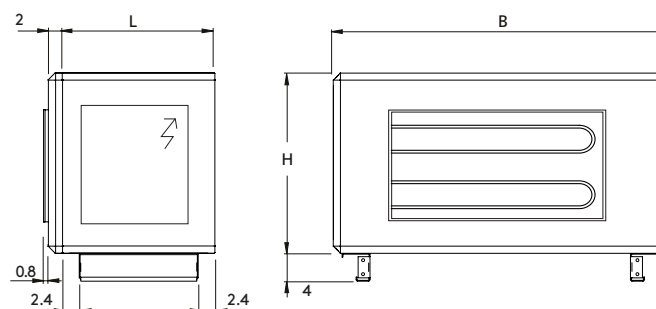

Connection dimensions to duct:

ACLE 20 16" × 40"

ACLE 30 20" × 48"

ACLE 40 24" × 56"

The base frame is always supplied in assembled condition. If the duct accessory is fitted to the upper ductwork, above the duct accessory fitted to the lower ductwork, remove the base beams to the extent necessary, at the building site.

* If several duct accessories are arranged in succession, in the end connection panel is supplied only on the duct accessory farthest out facing ductwork.

ACLE	B	H	L	lbs	End connection panel, if required lbs
1-20	55.1	30.6	23.4	323	42
1-30	63.0	35.7	23.4	343	51
1-40	78.3	42.5	23.4	415	68

Components and Accessories

Duct Accessories, in insulated casing

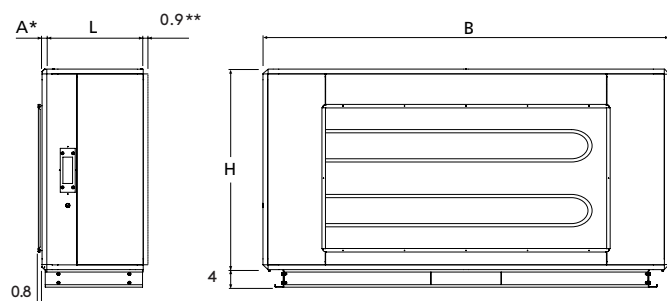

Connection dimensions to duct:

ACLE 60 32" × 64"

ACLE 80 40" × 72"

The base frame is always supplied in assembled condition. If the duct accessory is fitted to the upper ductwork, above the duct accessory fitted to the lower ductwork, remove the base beams to the extent necessary, at the building site.

* If several duct accessories are arranged in succession, in the end connection panel is supplied only on the duct accessory farthest out facing ductwork.

** Size 60

ACLE	B	H	L	A	lbs	End connection panel, if required lbs
1-60	91.3	44.4	21.3	1.1	620	68
1-80	103.8	51.9	21.3	2	805	84

Components and Accessories

Duct Accessories, in insulated casing

ACEK Coil section

Electric heating and water-borne cooling

The ACEK coil section is used for heating/cooling the supply air. The air heater runs on electric power and its type designation is ACLE. The cooling coil is a type ACKA air cooler for chilled water or a type ACKC air cooler for evaporative refrigerant.

To be installed for horizontal airflow.

The integrated thyristor is controlled via signals from the GOLD air handling unit. A wiring harness for communication and overheat protection is provided.

Technical data

Insulated casing. The outer skin is made of galvanized sheet steel painted in a beige colour tone (NCS S2005- =Y30R). The inner skin is made of galvanized sheet steel. Environmental class C4.

The electric air heater is available in several capacity variants. Available in both indoor and outdoor NEMA rated enclosures.

The air cooler is composed of copper tubes and profiled aluminium fins. The air cooler for chilled water has headers and water connections made of copper/brass, with male connection threads.

The air cooler for evaporative refrigerant has headers and distributor tubes made of copper. The connections are designed for brazed joints.

The air cooler is available in several capacity variants that cover existing needs for each size of GOLD unit.

Valve set

The ABVL valve set with 2(3)-way valve, valve actuator, freeze protection sensor (for readings only) and connection cable can be ordered for the air cooler for water.

Installation

The coil section should be mounted directly against the air handling unit or insulated duct accessory. Provision for inspection and cleaning must be guaranteed.

Electrical connection. **Electrical heaters require a separate dedicated power supply. Consult factory for single point power options.**



Components and Accessories

Duct Accessories, in insulated casing

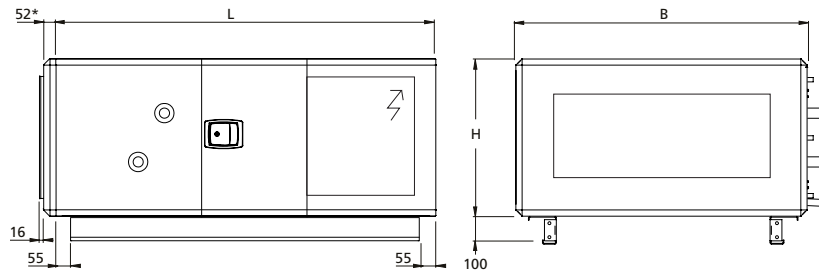

Connection dimensions to duct:

ACEK 05 12" × 18"

ACEK 08 14" × 24"

Base beams are options.

* If several duct accessories are arranged in succession, the end connection panel is supplied only on the duct accessory farthest out facing the ductwork.

Size	ACEK	B	H	L (4,6 Row)	L (8, 10 Row)	lbs	End connection Panel, if required. Lbs
05	3-05	32.5	181	43.2	43.2	257	15
08	3-08	39.2	21.3	43.2	43.2	343	22

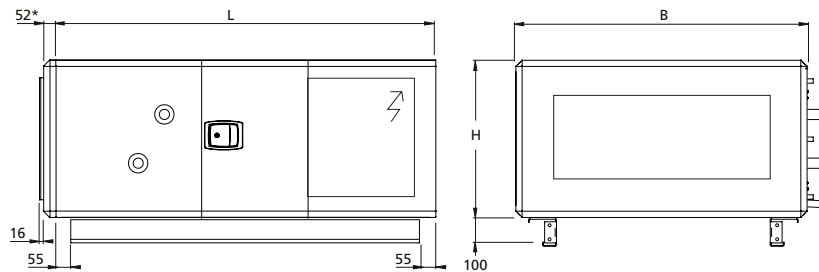

Connection dimensions to duct:

ACEK 12 18" × 32"

The base frame is always supplied in assembled condition. If the duct accessory is fitted to the upper ductwork, above the duct accessory fitted to the lower ductwork, remove the base beams to the extent necessary, at the building site. * If several duct accessories are arranged in succession, the end connection panel is supplied only on the duct accessory farthest out facing the ductwork.

Size	ACEK	B	H	L (4,6 Row)	L (8, 10 Row)	lbs	End connection Panel, if required. Lbs
12	1-12	47.3	25.5	45.2	45.2	257	29

Components and Accessories

Duct Accessories, in insulated casing

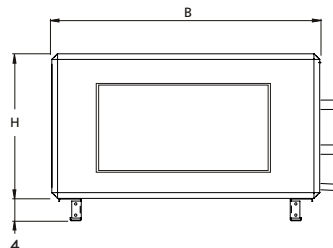
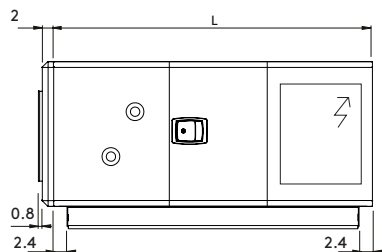

Connection dimensions to duct:

ACEK 20 16" × 40"

ACEK 30 20" × 48"

ACEK 40 24" × 56"

The base frame is always supplied in assembled condition. If the duct accessory is fitted to the upper ductwork, above the duct accessory fitted to the lower ductwork, remove the base beams to the extent necessary, at the building site.

* If several duct accessories are arranged in succession, in the end connection panel is supplied only on the duct accessory farthest out facing ductwork.

Size	ACEK	B	H	L (4,6 Row)	L (8, 10 Row)	lbs	End connection panel, if required kg
20	3-20	55.1	30.5	63.6	68.5	568	41.8
30	3-30	63	35.6	63.6	68.5	584	50.7
40	4-40	78.3	42.5	63.6	68.5	817	68.3

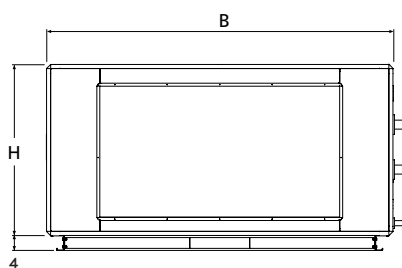
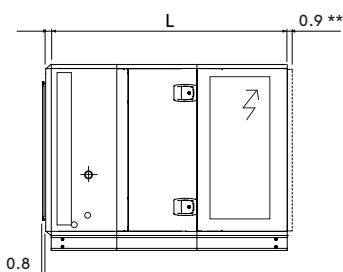

Connection dimensions to duct:

ACEK 60 32" × 64"

ACEK 80 40" × 72"

The base frame is always supplied in assembled condition. If the duct accessory is fitted to the upper ductwork, above the duct accessory fitted to the lower ductwork, remove the base beams to the extent necessary, at the building site.

* If several duct accessories are arranged in succession, in the end connection panel is supplied only on the duct accessory farthest out facing ductwork. ** Size 60 only.

Size	ACEK	B	H	L (4,6 Row)	L (8, 10 Row)	A	lbs	End connection panel, if required lbs
60	4-60	91.2	44.3	66.5	75.1	28	853.1	68.3
80	4-80	103.8	51.9	66.9	75.6	52	967.8	83.7

¹⁾ Casing only.

²⁾ Including casing, not charged with refrigerant.

Components and Accessories

Duct Accessories, in insulated casing

Coil Section, ACLK

Combination Heating and Cooling Casing

The ACLK coil section is used for heating/cooling the supply air. The air heater is for hot water and its type designation is ACLA. The air cooler is of type ACKA for chilled water or of type ACKC for evaporative refrigerant.

To be installed for horizontal airflow.

Technical data

Insulated casing. The outer skin is made of galvanized sheet steel painted in a beige colour tone. The inner skin is made of galvanized sheet steel.

The air heater is a finned-tube heat exchanger fabricated of copper tubes and profiled aluminium fins. The headers and the pipework to the water connections are made of copper. The male threaded pipe connections are made of steel.

The air cooler is composed of copper tubes and profiled aluminium fins. The air cooler for chilled water has headers and water connections made of copper, with male connection threads.

The air cooler for evaporative refrigerant has headers and distributor tubes made of copper. The connections are designed for brazed joints.

The air cooler is available in several capacity variants that cover existing needs for each size of GOLD unit.

All cooling coils come standard with a double sloped stainless steel drain pan with a ½" NPT drain pipe stubout. There is also the option for mist eliminators, where applicable.

Valve set

The ABVL valve set with 2-way valve, valve actuator, freeze protection sensor (for readings only) and connection cable can be ordered.

Installation

The coil section should be mounted directly against the air handling unit or insulated duct accessory.

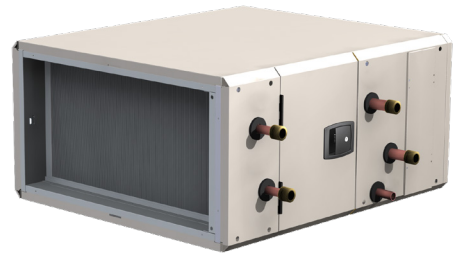

Components and Accessories

Duct Accessories, in insulated casing

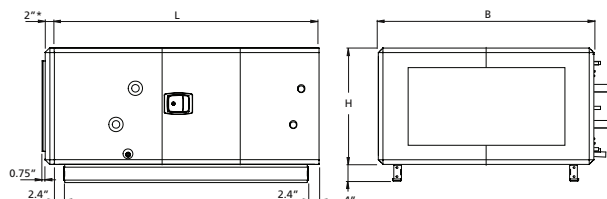

The base frame is always supplied in assembled condition. If the duct accessory is fitted to the upper ductwork, above the duct accessory fitted to the lower ductwork, remove the base beams to the extent necessary, at the building site.

* If several duct accessories are arranged in succession, the end connection panel is supplied only on the duct accessory farthest out facing the ductwork.

Size	ACLK	B	H	L (4,6 Row)	L (8, 10 Row)	lbs ¹⁾	End connection Panel, if required. Lbs
05	3-05	32.4	18.1	43.2	43.2	180	15
07/08	3-08	39.2	21.3	43.2	43.2	249	22
11/12	3-12	47.3	25.5	45.2	45.2	356	29

¹⁾ Not filled with water/not charged with refrigerant

Connection dimensions to duct:

ACLK 05	12" x 18"
ACLK 08	14" x 24"
ACLK 12	18" x 32"
ACLK 20	16" x 40"
ACLK 30	20" x 48"
ACLK 40	24" x 56"

Size	ACLK	B	H	L (4,6 Row)	L (8, 10 Row)	lbs ¹⁾	End connection Panel, if required. Lbs
14/20	4-20	55.1	30.6	52.4	57.3	400-515	42
25/30	4-30	63	35.7	52.4	57.3	480-645	51
35/40	4-40	78.3	42.5	52.4	57.3	614-860	68

¹⁾ Including casing: Not filled with water/not charged with refrigerant

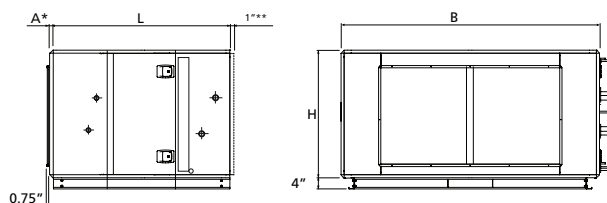

The base frame is always supplied in assembled condition. If the duct accessory is fitted to the upper ductwork, above the duct accessory fitted to the lower ductwork, remove the base beams to the extent necessary, at the building site.

* If several duct accessories are arranged in succession, the end connection panel is supplied only on the duct accessory farthest out facing the ductwork.

** Size 60 only

Size	ACLK	B	H	L (4,6 Row)	L (8, 10 Row)	A	lbs ¹⁾	End connection Panel, if required. Lbs
50/60	4-60	91.3	44.4	64.0	72.7	1.1	1067-1285	70
70/80	4-80	103.8	52	64.0	72.7	2	1225-1540	84

Connection dimensions to duct:

ACLK 60	32" x 64"
ACLK 80	40" x 72"

¹⁾ Including casing: Not filled with water/not charged with refrigerant

Components and Accessories

Outdoor installation

GOLD units equipped with the roof, air intake section and exhaust air hood accessories can be installed outdoors.

The roof cannot be used on GOLD air handling units with the fan outlet/inlet positioned on the top of the unit.

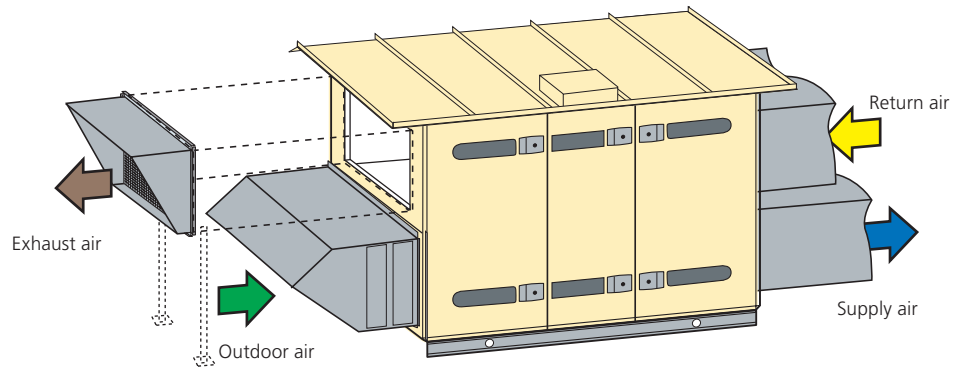

General

The GOLD air handling units, including ACBR air recirculation section can be installed outdoors. This presupposes that the roof, outdoor air and exhaust air weather hoods and accessories are used. GOLD air handling units cannot be installed outdoors in applications that call for the fan outlet/inlet to be positioned on the top of the unit.

ABTB Roof

The roof is supplied in kit form, complete with the necessary assembly parts and sealing strips. The cover plates for all the door handles are included as standard.

The visible components are made of sheet metal painted in a shade of beige (NCS S2005-Y30R).

Dimensions

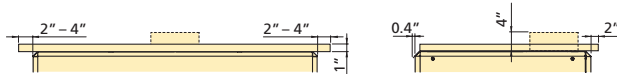

Duct Accessories

Select duct accessories housed in insulated casings if they are to be installed outdoors. They can be located outdoors, however the enclosure classes and permissible ambient temperatures of any actuators included must be taken into consideration. See the instructions for the corresponding accessory. If necessary, see to it that required protection is arranged.

Weather Hoods

Exhaust and outdoor air weather hoods are of aluminum welded construction including a bird screen.

Exhaust and outdoor hood lengths come staggered to reduce short circuiting, however adding straight duct length to increase stagger, as shown in the picture above, is recommended.

Weather hoods are always shipped loose.

Installation Tips

GOLD Air handling units should if possible be installed where the most favourable conditions exist from a weather point of view.

The ductwork for supply air and return air must be insulated in accordance with local standards.

The hand-held micro terminal of the GOLD unit is sensitive to cold and must always be kept in a heated space. If required, use an extension cable or also an extension cable kit (see accessories for electrical and control equipment).

Swegon recommends moving the exhaust air hood a distance from the air handling unit by fitting a straight length of duct between them, especially if the exhaust air leaves the air handling unit from its lower level. This will prevent the risk of exhaust air short-circuiting to the outdoor air and the risk of water entering the ventilation system.

Components and Accessories

Communication

Communication unit, ABLZ

Communication via TCP/IP, EIA 485 and EIA 232 as well as via internal web server is standard in the GOLD. The ABLZ extra communication unit is required for communication via LON FTT-10 - Lon Works. The communication unit must be connected to the communication port of the GOLD unit. Power can be supplied from appropriate terminal connections on the GOLD unit.

The scope available for communication is conditional on the software and its programming. The GOLD unit in itself provides potential for comprehensive communication of readings, settings and functions.

Modem

Analogue or GSM. Can be used when direct connection cannot be made to a network or communication system.

Several units can be connected to the same modem.



Components and Accessories

Electrical and Control Equipment

Occupant detection sensor

Instead of using a timer for controlling the fans to operate in the high speed or low speed mode, ABLZ occupant detection sensors can carry out this control. As soon as the sensor registers the presence of an occupant in the room, it transmits a signal to the control unit to switch the unit to the high speed operating mode. When no occupant is registered in the room, the unit returns to the normal flow mode.

Connect via appropriate terminal connections on the control circuit card.

Pressure transducer

For use in conjunction with the VAV pressure control function, when constant pressure must be kept in the ductwork. Also for use in conjunction with the heat exchanger defrosting function, when the pressure across the heat exchanger must be controlled. The connection cable is included. 3 – 50 ft. long cable can be selected.

Connect via appropriate terminal connections on the control circuit card.

Air quality sensor

For use in conjunction with the demand-controlled VAV function, when the airflow of the air handling unit must be variably controlled by means of an air quality sensor. Available for duct or room.

Connect via appropriate terminal connections on the control circuit card.

VOC sensor

For use in connection with Wise Apartment or demand control of the GOLD. To be mounted inside an air duct. Wiring is to be done on the control circuit card's communication bus.

Room sensor, outdoor/room sensor

Used in conjunction with functions that require temperature readings from outdoors or from rooms. The sensor is designed for wall-mounting and is available for degree of protection IP 20 or IP 43.

Connect via appropriate terminal connections on the control circuit card.

Internal duct temperature sensor

Used in connection with the return air regulation function or as a temperature monitor/alarm for the GOLD RX. The sensor is supplied with the length of cable specified by the client in the purchase order, 3 – 33 ft.

Return air duct, temperature sensor

This can be used in conjunction with the evaporative cooling and Xzone return air regulation functions, for example. The sensor is supplied with a 25 ft. long cable.

Timer

The ALQZ timer is used for overtime operation in conjunction with the external high speed and external low speed functions. For strap-on mounting.

Connect via appropriate terminal connections on the control circuit card.

Timer, electronic

The ABLZ electronic timer can be used for overtime operation in conjunction with the external high speed and external low speed functions. For strap-on mounting.

Connect communication cable leads to appropriate terminal connections on the control circuit card. Separate power supply.

Push button

The ALQZ push button can be used for overtime operation in conjunction with the external high speed and external low speed functions. For strap-on mounting. Can be selected with or without indication.

Connect via appropriate terminal connections on the control circuit card.

Extension cables

18 ft. long for air heater, water and electric 25 ft. long for hand-held micro terminal, supply air temperature sensor, pressure sensor and IQlogic+.

Extension kit for pressure sensor or external temperature sensor

For lengthening the cable, 18.5 ft. - 180 ft.

IQnavigator hand-held micro terminal with WLAN

IQnavigator hand-held micro terminal with WLAN for wireless connection to the IQlogic control card. Net adapter for hand-held micro terminal.

Strap-on sensor

Temperature sensor for mounting against the surface where readings are to be taken.

Fire and smoke protection

The fire and smoke protection function consists of three separate units:

- ABLZ cubicle
- ABLZ smoke detector
- ALQZ* damper actuator.

The cubicle contains the control unit and connections. The smoke detector stops the air handling unit and controls the damper actuators to close the dampers. An alarm is presented in the hand-held micro terminal of the GOLD air handling unit.

SD card

Multi-media circuit card for program transmissions and logging.

IQlogic+

The IQlogic+ functional module is used for extra functions for which the inputs and outputs are not included as standard in which the control unit of the GOLD air handling unit. 3 – 50 ft. long connection cable.

Temperature sensor, IQlogic+

Temperature sensor, for the IQlogic+ module

Humidity sensor, IQlogic+

Temperature sensor, for the IQlogic+ module for dehumidification and dew point control.

Xzone Control box

Control box for controlling one extra temp. zone, max.

Components and Accessories

Electrical and Control Equipment

ReCO₂

Complete set of components for controlling the function for mixing. The pressure sensor and the IQlogic+ are included. Air quality sensor to be ordered separately. The outdoor air damper must be of modulating type.

Control of the air heater for preheating

Includes temperature sensor for installation in a duct and the IQlogic.

All Year Comfort

Electrical equipment cubicle for controlling the primary water circuit for cooling and /or heating. For climate beams, perimeter climate systems, etc.

Sizing, Installation, Dimensions and Weight

GOLD RX, rotary heat exchanger, size 05

DELIVERY AND TRANSPORT WITHIN THE SITE

The GOLD RX 05 is produced in one single variant, in which all the components are arranged at their given physical locations inside the air handling unit. The air handling unit is supplied on a wooden pallet.

BASE BEAMS/STAND/FOUNDATION

The design makes it necessary to mount the GOLD RX 05 on base beams, a stand or some other form of foundation. Otherwise it will not be possible to open the inspection doors. Prefitted base beams are obtainable as optional equipment; a separately supplied stand is available as an accessory.

DUCT CONNECTION OPTIONS

A: Specify right-hand or left-hand version when ordering. If the air handling unit is supplied with all the end connection panels, the version can be changed at the building site by selecting the appropriate version in the hand-held micro terminal.

B: The air handling unit can be installed up ended (does not apply to units installed outdoors).

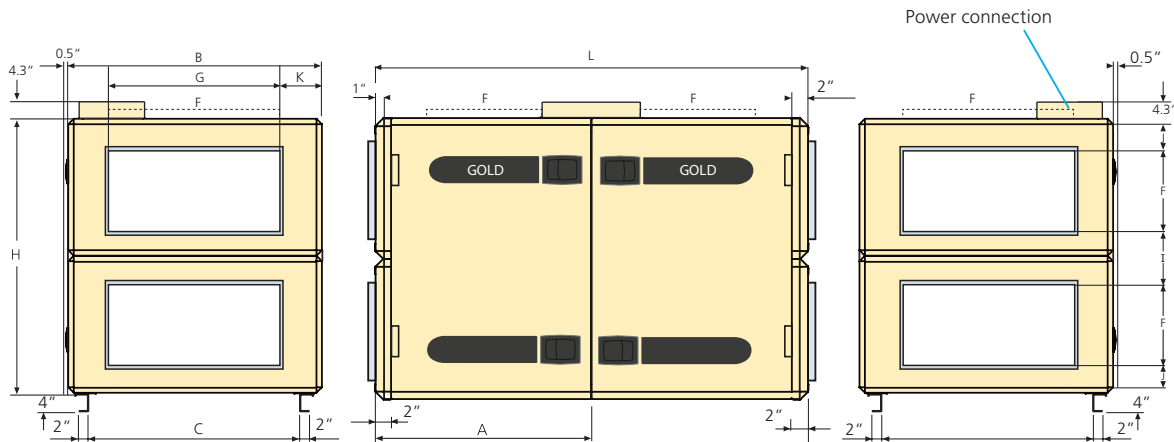
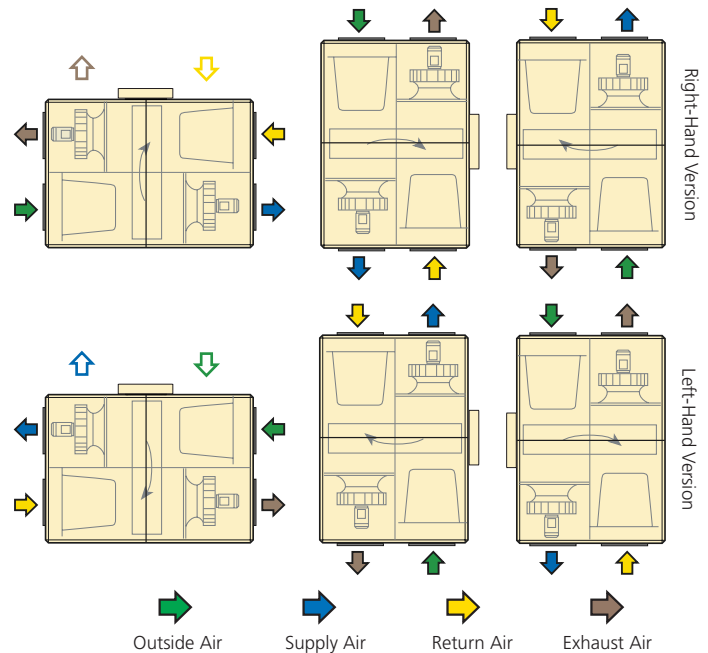

The dimension print shows the connection configuration for fan arrangement 1. For fan arrangement 2 the connections are mirror-inverted.

The air handling unit is supplied without end connection panel if a duct accessory housed in an insulated casing will be connected.

Size	A	B	C	F	G	H	I	J	K	L	Wgt (lb)	Airflow ERV	Airflow CWC
RX 05	29.5	33	22.1	12	18	36.2	6.1	3.1	7.2	59.1	470-540	1300 cfm	920 cfm*

*based on 550 fpm

CLEAR SPACE FOR INSPECTION

A clear space of 36 inches should be provided in front of the unit and at least 8 inches should be provided above the junction hood.

Power Connection	
	230/1/60
FLA	11.43
MCA	12.81
RFS	15

Sizing, Installation, Dimensions and Weight

GOLD RX, rotary heat exchanger, size 07

DELIVERY AND TRANSPORT WITHIN THE SITE

The GOLD RX 07 is produced in one single variant. All of its components are arranged at their given physical location inside the air handling unit. The air handling unit is supplied on a wooden pallet.

BASE BEAMS/STAND/FOUNDATION

The design makes it necessary to mount the GOLD RX 07 on base beams, a stand or some other form of foundation. Otherwise it will not be possible to open the inspection doors. Prefitted base beams are obtainable as optional equipment; a separately supplied stand is available as an accessory.

DUCT CONNECTION OPTIONS

A: Specify right-hand or left-hand version when ordering. If the air handling unit is supplied with all the end connection panels, the version can be changed at the building site by selecting the appropriate version in the hand-held micro terminal.

B: The air handling unit can be installed up ended (does not apply to units installed outdoors).

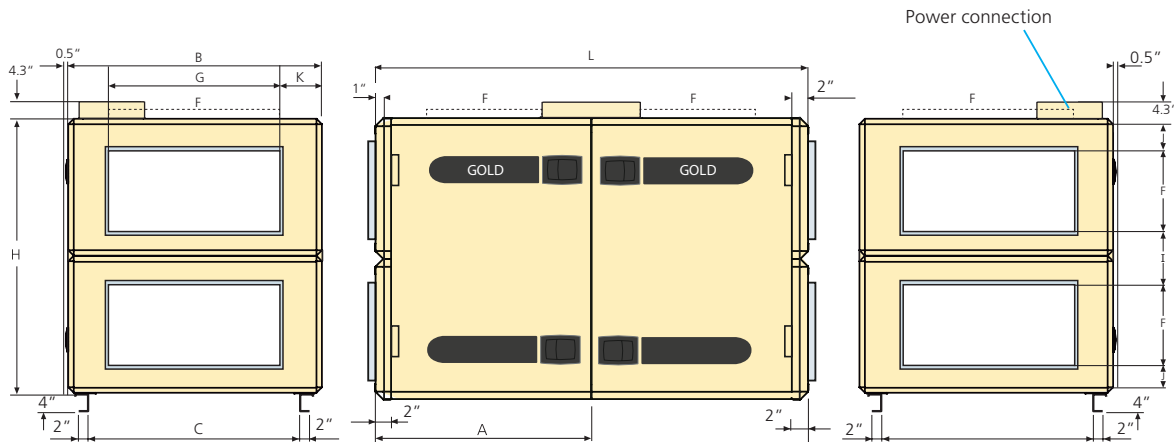
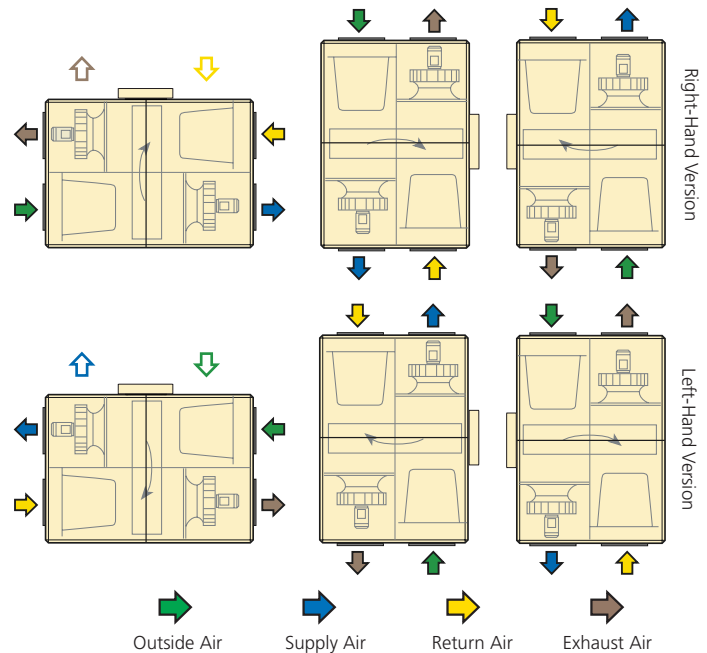

The dimension print shows the connection configuration for fan arrangement 1. For fan arrangement 2 the connections are mirror-inverted.

The air handling unit is supplied without end connection panel if a duct accessory housed in an insulated casing will be connected.

Size	A	B	C	F	G	H	I	J	K	L	Wgt (lb)	Airflow ERV	Airflow CWC
RX 07	31.5	39.2	28.8	14	24	42.7	7.4	3.7	7.6	63	580–660	1500 cfm	1420 cfm*

*based on 550 fpm

CLEAR SPACE FOR INSPECTION

A clear space of 36 inches should be provided in front of the unit and at least 8 inches should be provided above the junction hood.

Power Connection	
	230/1/60
FLA	11.43
MCA	12.81
RFS	15

Sizing, Installation, Dimensions and Weight

GOLD RX, rotary heat exchanger, size 08

DELIVERY AND TRANSPORT WITHIN THE SITE

The GOLD RX 08 is produced in one single variant, in which all the components are arranged at their given physical locations inside the air handling unit. The air handling unit is supplied on a wooden pallet.

BASE BEAMS/STAND/FOUNDATION

The design makes it necessary to mount the GOLD RX 08 on base beams, a stand or some other form of foundation. Otherwise it will not be possible to open the inspection doors. Prefitted base beams are obtainable as optional equipment; a separately supplied stand is available as an accessory.

DUCT CONNECTION OPTIONS

A: Specify right-hand or left-hand version when ordering. If the air handling unit is supplied with all the end connection panels, the version can be changed at the building site by selecting the appropriate version in the hand-held micro terminal.

B: The air handling unit can be installed up ended (does not apply to units installed outdoors).

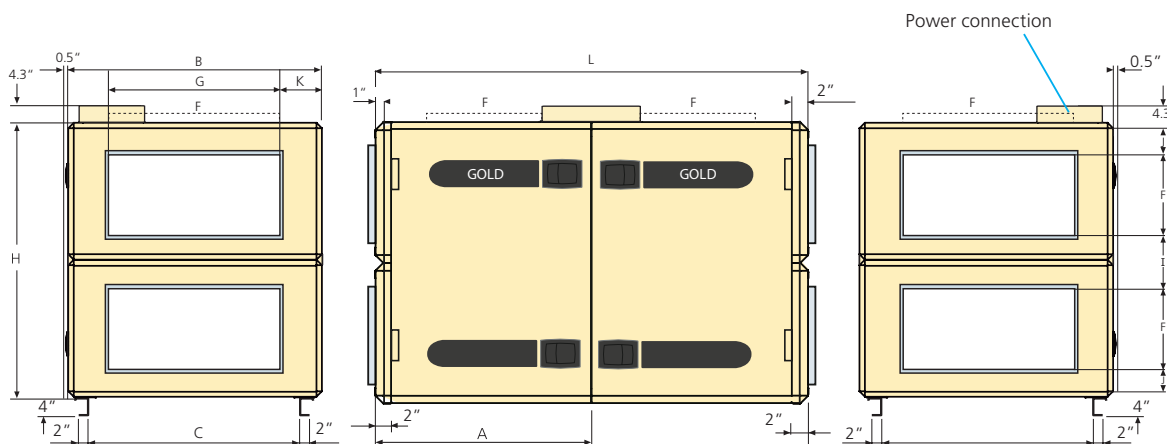
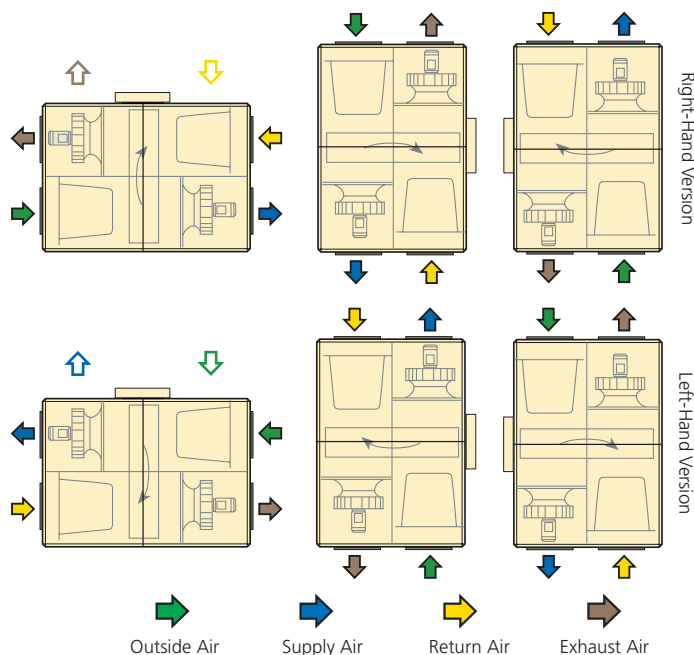

The dimension print shows the connection configuration for fan arrangement 1. For fan arrangement 2 the connections are mirror-inverted.

The air handling unit is supplied without end connection panel if a duct accessory housed in an insulated casing will be connected.

Size	A	B	C	F	G	H	I	J	K	L	Wgt (lb)	Airflow ERV	Airflow CWC
RX 08	31.5	39.2	28.8	14	24	42.7	7.4	3.7	7.6	63	580–660	2000 cfm	1420 cfm*

*based on 550 fpm

CLEAR SPACE FOR INSPECTION

A clear space of 36 inches should be provided in front of the unit and at least 8 inches should be provided above the junction hood.

Power Connection	
	230/1/60
FLA	11.43
MCA	12.81
RFS	15

Sizing, Installation, Dimensions and Weight

GOLD RX, rotary heat exchanger, size 11

DELIVERY AND TRANSPORT WITHIN THE SITE

The GOLD RX 11 is always supplied as one unit. The air handling unit can be split into three sections to facilitate transporting it within the building site.

The three sections are joined together by bolts and the electrical and control cables between the sections have quick-fit connectors.

The air handling unit is delivered on wooden pallets.

DUCT CONNECTION OPTIONS

A: Specify right-hand or left-hand version when ordering. If the air handling unit is supplied with all the end connection panels, the version can be changed at the building site by selecting the appropriate version in the hand-held micro terminal.

B: The arrangement of the functional sections can be vertically reversed. Specify this by selecting fan arrangement 1 or 2 when placing orders.

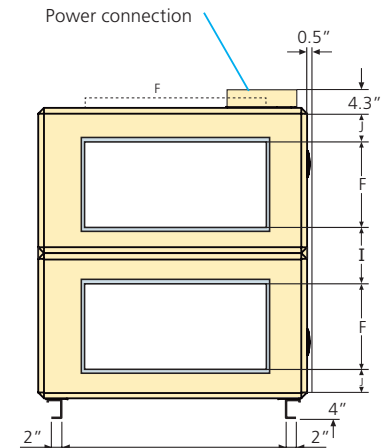
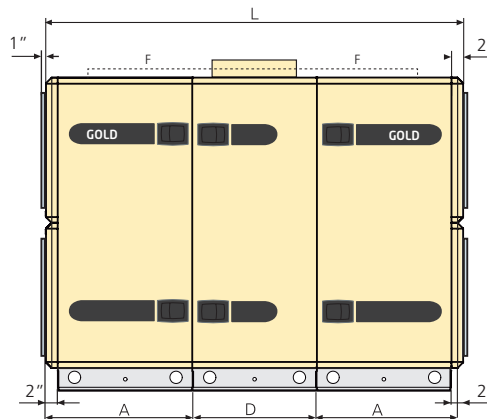
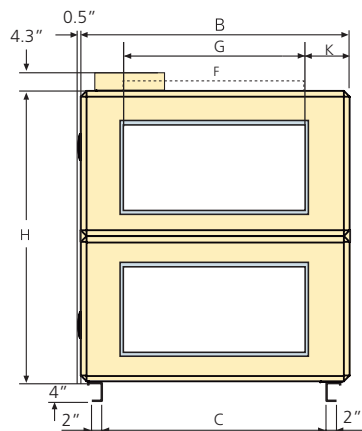
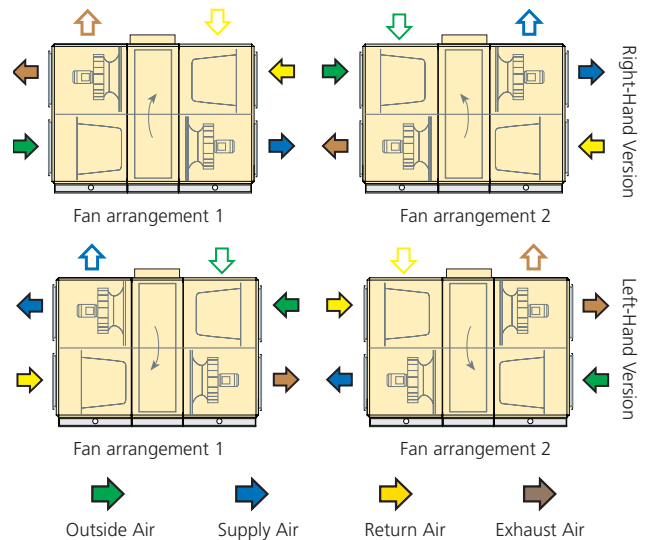

The dimension print shows the connection configuration for fan arrangement 1. For fan arrangement 2 the connections are mirror-inverted.
The air handling unit is supplied without end connection panel if a duct accessory housed in an insulated casing will be connected.

Size	A	B	C	D	F	G	H	I	J	K	L	Wgt (lb)	Airflow ERV	Airflow CWC
RX 11	25.8	47.3	36.8	21.7	18	32	51	7.5	3.8	7.6	73.2	980-1090	2300 cfm	2300 cfm*

*based on 550 fpm

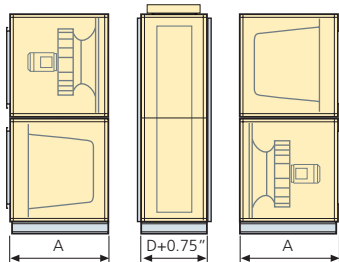

DIVISION INTO SECTIONS FOR TRANSPORT

The unit can be divided into three sections at the building site.

Dimensions: See A and D in the table above.

Weight: A = 310–370 lbs, D = 355 lbs.

CLEAR SPACE FOR INSPECTION

A clear space of 36 inches should be provided in front of the unit and at least 8 inches should be provided above the junction hood.

Power Connection	
	230/1/60
FLA	11.43
MCA	12.81
RFS	15

Sizing, Installation, Dimensions and Weight

GOLD RX, rotary heat exchanger, size 12

DELIVERY AND TRANSPORT WITHIN THE SITE

The GOLD RX 12 is always supplied as one unit. The air handling unit can be split into three sections to facilitate transporting it within the building site.

The three sections are joined together by bolts and the electrical and control cables have quick connectors.

The air handling unit is delivered on wooden pallets.

DUCT CONNECTION OPTIONS

A: Specify right-hand or left-hand version when ordering. If the air handling unit is supplied with all the end connection panels, the version can be changed at the building site by selecting the appropriate version in the hand-held micro terminal.

B: The arrangement of the functional sections can be vertically reversed. Specify this by selecting fan arrangement 1 or 2 when placing orders.

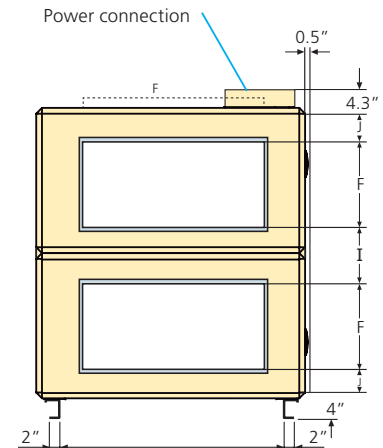
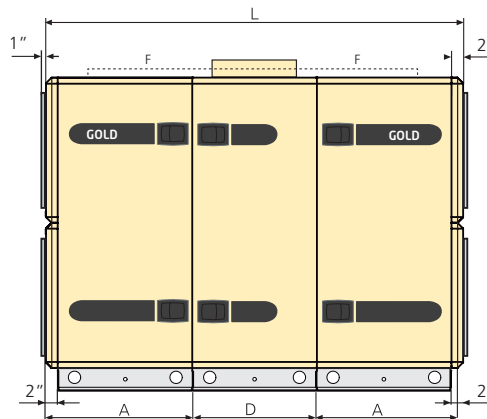
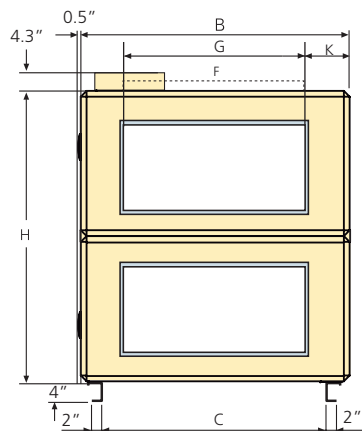
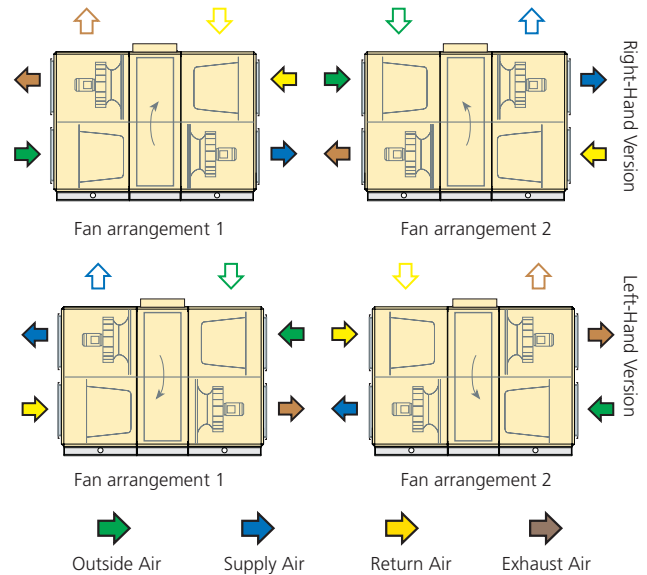

The dimension print shows the connection configuration for fan arrangement 1. For fan arrangement 2 the connections are mirror-inverted.
The air handling unit is supplied without end connection panel if a duct accessory housed in an insulated casing will be connected.

Size	A	B	C	D	F	G	H	I	J	K	L	Wgt (lb)	Airflow ERV	Airflow CWC
RX 12	25.8	47.3	36.8	21.7	18	32	51	7.5	3.8	7.6	73.2	980-1090	2850 cfm	2480 cfm*

*based on 550 fpm

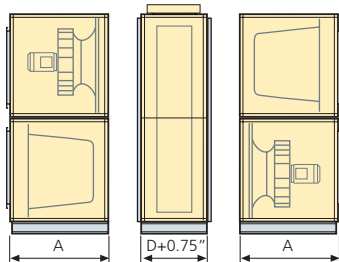

DIVISION INTO SECTIONS FOR TRANSPORT

The unit can be divided into three sections at the building site.

Dimensions: See A and D in the table above.

Weight: A = 335–393 lbs, D = 360 lbs.

CLEAR SPACE FOR INSPECTION

A clear space of 36 inches should be provided in front of the unit and at least 8 inches should be provided above the junction hood.

Power Connection		
	460/3/60	575/3/60
FLA	7.8	6.2
MCA	8.7	6.9
RFS	15	15

Sizing, Installation, Dimensions and Weight

GOLD RX, rotary heat exchanger, size 14

DELIVERY AND TRANSPORT WITHIN THE SITE

The GOLD RX 14 is always supplied as one unit. The air handling unit can be split into three sections to facilitate transporting it within the building site.

The three sections are joined together by bolts and the electrical and control cables have quick connectors.

The air handling unit is delivered on wooden pallets.

DUCT CONNECTION OPTIONS

A: Specify right-hand or left-hand version when ordering. If the air handling unit is supplied with all the end connection panels, the version can be changed at the building site by selecting the appropriate version in the hand-held micro terminal.

B: The arrangement of the functional sections can be vertically reversed. Specify this by selecting fan arrangement 1 or 2 when placing orders

C: Specify upper fan outlet for upward air discharge when placing orders (not for outdoor units).

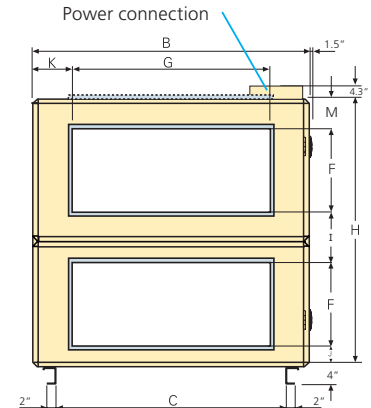
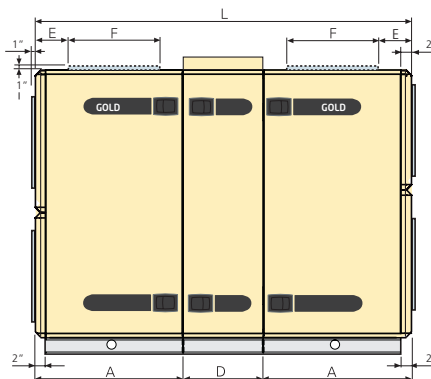
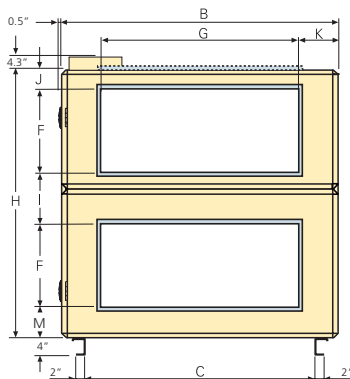
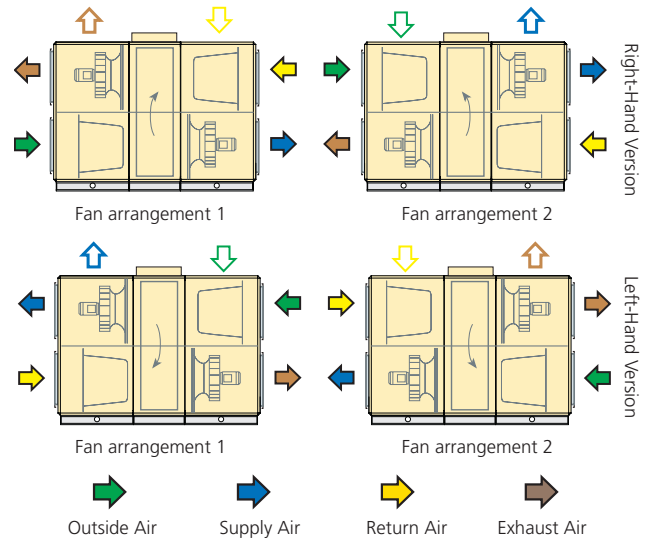

The dimension print shows the connection configuration for fan arrangement 1. For fan arrangement 2 the connections are mirror-inverted.
The air handling unit is supplied without end connection panel if a duct accessory housed in an insulated casing will be connected.

Size	A	B	C	D	E	F	G	H	I	J	K	L	M	Wgt (lb)	Airflow ERV	Airflow CWC
RX 14	30.1	55.1	44.7	21.8	8.2	16	40	54.9	11.5	4.2	7.6	82	7.3	1150-1300	3150 cfm	3150 cfm*

*based on 550 fpm

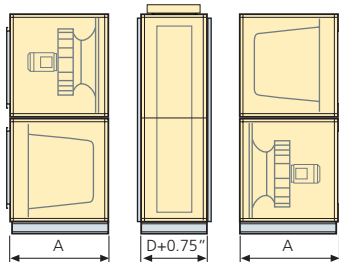

DIVISION INTO SECTIONS FOR TRANSPORT

The unit can be divided into three sections at the building site.

Dimensions: See A and D in the table above.

Weight: A = 385–460 lbs, D = 380 lbs

CLEAR SPACE FOR INSPECTION

A clear space of 36 inches should be provided in front of the unit and at least 8 inches should be provided above the junction hood.

Power Connection		
	460/3/60	575/3/60
FLA	7.8	6.2
MCA	8.7	6.9
RFS	15	15

Sizing, Installation, Dimensions and Weight

GOLD RX, rotary heat exchanger, size 20

DELIVERY AND TRANSPORT WITHIN THE SITE

The GOLD RX 20 is always supplied as one unit. The air handling unit can be split into three sections to facilitate transporting it within the building site.

The three sections are joined together by bolts and the electrical and control cables have quick connectors.

The air handling unit is delivered on wooden pallets.

DUCT CONNECTION OPTIONS

A: Specify right-hand or left-hand version when ordering. If the air handling unit is supplied with all the end connection panels, the version can be changed at the building site by selecting the appropriate version in the hand-held micro terminal.

B: The arrangement of the functional sections can be vertically reversed. Specify this by selecting fan arrangement 1 or 2 when placing orders.

C: Specify upper fan outlet for upward air discharge when placing orders (not for outdoor units).

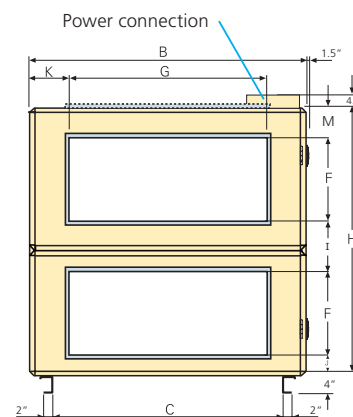
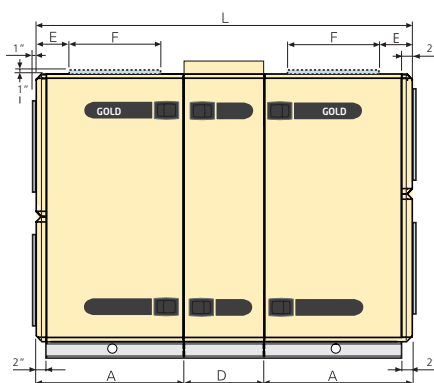
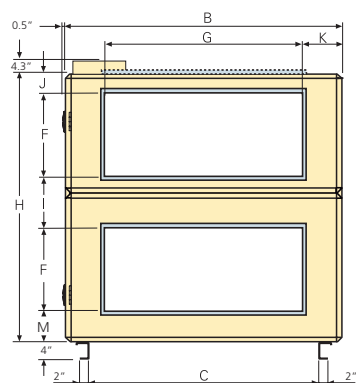
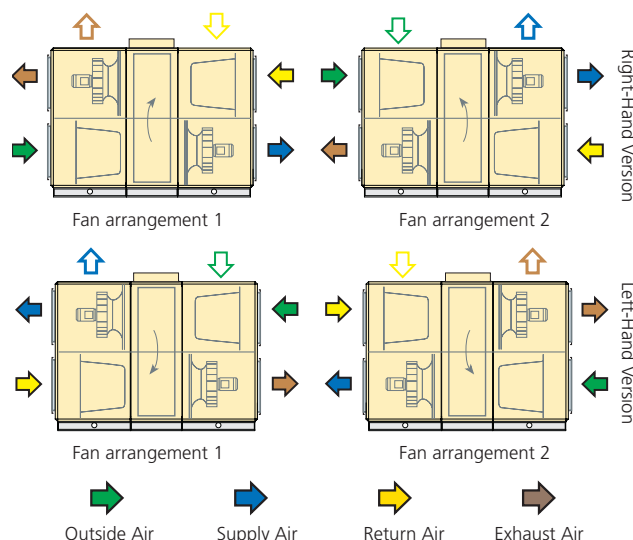

The dimension print shows the connection configuration for fan arrangement 1. For fan arrangement 2 the connections are mirror-inverted.

The air handling unit is supplied without end connection panel if a duct accessory housed in an insulated casing will be connected.

Size	A	B	C	D	E	F	G	H	I	J	K	L	M	Wgt (lb)	Airflow ERV	Airflow CWC
RX 20	30.1	55.1	44.7	21.8	8.2	16	40	54.9	11.4	4.2	7.6	82	7.3	1150-1300	4200 cfm	3700 cfm*

*based on 550 fpm

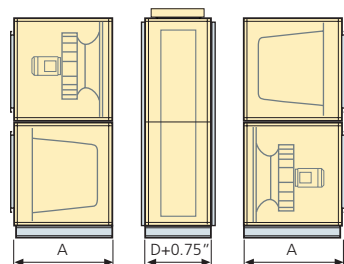

DIVISION INTO SECTIONS FOR TRANSPORT

The unit can be divided into three sections at the building site.

Dimensions: See A and D in the table above.

Weight: A = 425–500 lbs, D = 380 lbs.

CLEAR SPACE FOR INSPECTION

A clear space of 36 inches should be provided in front of the unit and at least 8 inches should be provided above the junction hood.

Power Connection		
	460/3/60	575/3/60
FLA	10.9	8.6
MCA	12.2	9.6
RFS	15	15

Sizing, Installation, Dimensions and Weight

GOLD RX, rotary heat exchanger, size 25

DELIVERY AND TRANSPORT WITHIN THE SITE

The GOLD RX 25 is always supplied as one unit. The air handling unit can be split into three sections to facilitate transporting it within the building site.

The three sections are joined together by bolts and the electrical and control cables have quick connectors.

The air handling unit is delivered on wooden pallets.

DUCT CONNECTION OPTIONS

A: Specify right-hand or left-hand version when ordering. If the air handling unit is supplied with all the end connection panels, the version can be changed at the building site by selecting the appropriate version in the hand-held micro terminal.

B: The arrangement of the functional sections can be vertically reversed. Specify this by selecting fan arrangement 1 or 2 when placing orders.

C: Specify upper fan outlet for upward air discharge when placing orders (not for outdoor units).

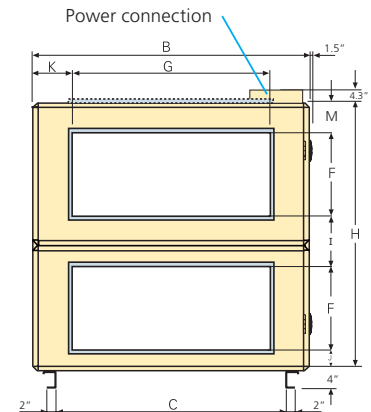
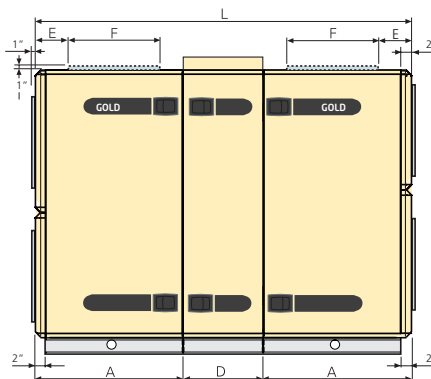
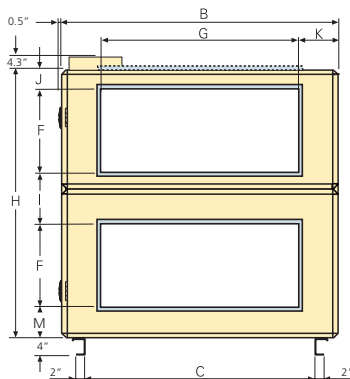
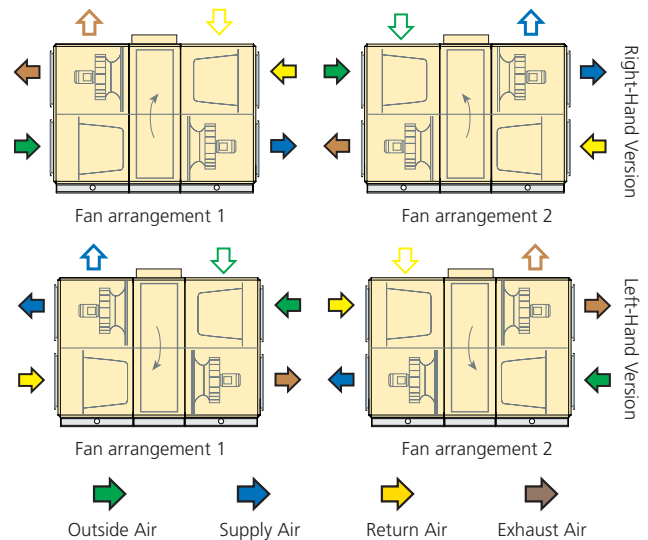

The dimension print shows the connection configuration for fan arrangement 1. For fan arrangement 2 the connections are mirror-inverted.
The air handling unit is supplied without end connection panel if a duct accessory housed in an insulated casing will be connected.

Size	A	B	C	D	E	F	G	H	I	J	K	L	M	Wgt (lb)	Airflow ERV	Airflow CWC
RX 25	32.9	63	52.6	21.7	7.5	20	48	62.8	11.5	3.6	7.5	87.4	7.8	1470-1650	4750 cfm	4750 cfm*

*based on 550 fpm

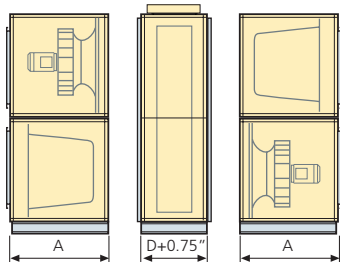

DIVISION INTO SECTIONS FOR TRANSPORT

The unit can be divided into three sections at the building site.

Dimensions: See A and D in the table above.

Weight: A = 500–585 lbs, D = 475 lbs.

CLEAR SPACE FOR INSPECTION

A clear space of 36 inches should be provided in front of the unit and at least 8 inches should be provided above the junction hood.

Power Connection		
	460/3/60	575/3/60
FLA	10.9	8.6
MCA	12.2	9.6
RFS	15	15

Sizing, Installation, Dimensions and Weight

GOLD RX, rotary heat exchanger, size 30

DELIVERY AND TRANSPORT WITHIN THE SITE

The GOLD RX 30 is always supplied as one unit. The air handling unit can be split into three sections to facilitate transporting it within the building site.

The three sections are joined together by bolts and the electrical and control cables have quick connectors.

The air handling unit is delivered on wooden pallets.

DUCT CONNECTION OPTIONS

A: Specify right-hand or left-hand version when ordering. If the air handling unit is supplied with all the end connection panels, the version can be changed at the building site by selecting the appropriate version in the hand-held micro terminal.

B: The arrangement of the functional sections can be vertically reversed. Specify this by selecting fan arrangement 1 or 2 when placing orders.

C: Specify upper fan outlet for upward air discharge when placing orders (not for outdoor units).

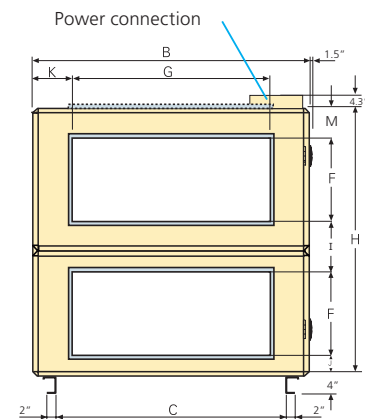
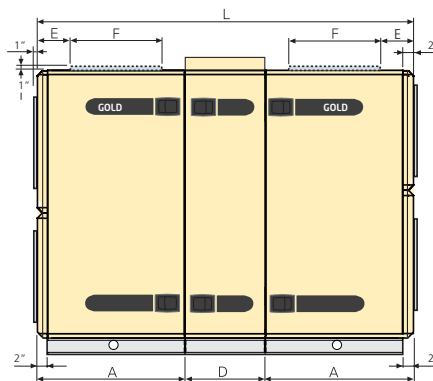
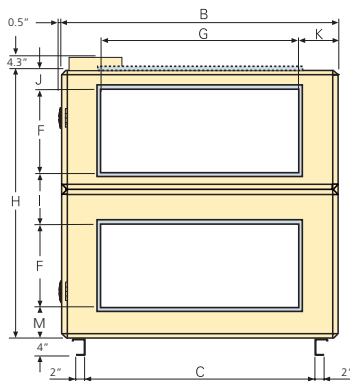
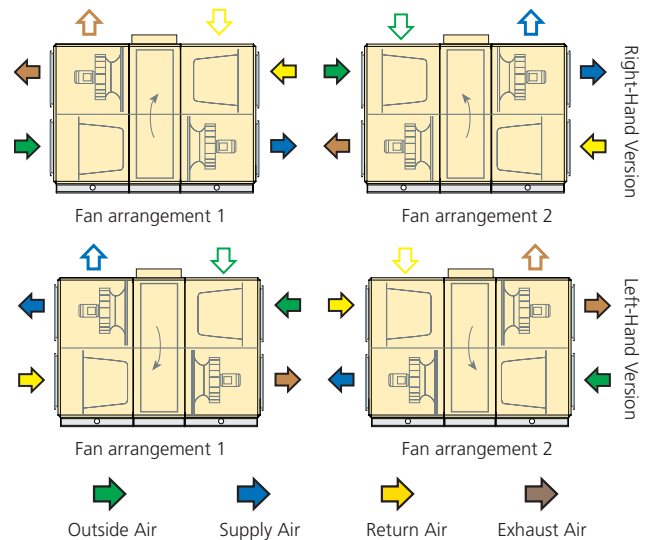

The dimension print shows the connection configuration for fan arrangement 1. For fan arrangement 2 the connections are mirror-inverted.

The air handling unit is supplied without end connection panel if a duct accessory housed in an insulated casing will be connected.

Size	A	B	C	D	E	F	G	H	I	J	K	L	M	Wgt (lb)	Airflow ERV	Airflow CWC
RX 30	32.9	63	52.6	21.7	7.5	20	48	62.8	11.4	3.6	7.5	87.4	7.8	1560-1740	5800 cfm	5260 cfm*

*based on 550 fpm

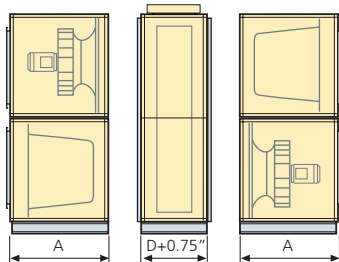

DIVISION INTO SECTIONS FOR TRANSPORT

The unit can be divided into three sections at the building site.

Dimensions: See A and D in the table above.

Weight: A = 540–630 lbs, D = 475 lbs.

CLEAR SPACE FOR INSPECTION

A clear space of 36 inches should be provided in front of the unit and at least 8 inches should be provided above the junction hood.

Power Connection		
	460/3/60	575/3/60
FLA	15.6	12.3
MCA	17.4	13.7
RFS	20	15

Sizing, Installation, Dimensions and Weight

GOLD RX, rotary heat exchanger, size 35

DELIVERY AND TRANSPORT WITHIN THE SITE

The GOLD RX 35 is always supplied as one unit. The air handling unit can be split into three sections to facilitate transporting it within the building site.

The three sections are joined together by bolts and the electrical and control cables have quick connectors.

The air handling unit is delivered on wooden pallets.

DUCT CONNECTION OPTIONS

A: Specify right-hand or left-hand version when ordering. If the air handling unit is supplied with all the end connection panels, the version can be changed at the building site by selecting the appropriate version in the hand-held micro terminal.

B: The arrangement of the functional sections can be vertically reversed. Specify this by selecting fan arrangement 1 or 2 when placing orders.

C: Specify upper fan outlet for upward air discharge when placing orders (not for outdoor units).

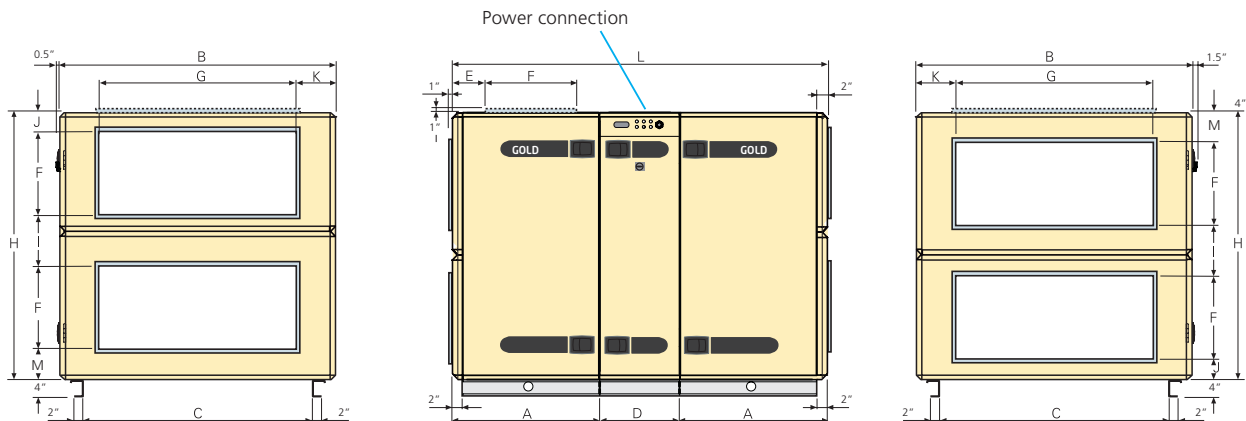
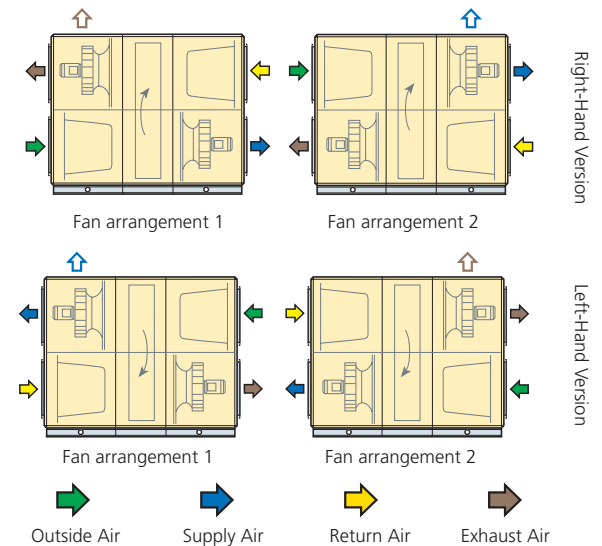

The dimension print shows the connection configuration for fan arrangement 1. For fan arrangement 2 the connections are mirror-inverted.
The air handling unit is supplied without end connection panel if a duct accessory housed in an insulated casing will be connected.

Size	A	B	C	D	E	F	G	H	I	J	K	L	M	Wgt (lb)	Airflow ERV	Airflow CWC
RX 35	37.3	78.3	70	21.7	7.7	24	56	78.2	15	5.9	11.2	96.3	9.3	2110-2360	7000 cfm	7000 cfm*

*based on 550 fpm

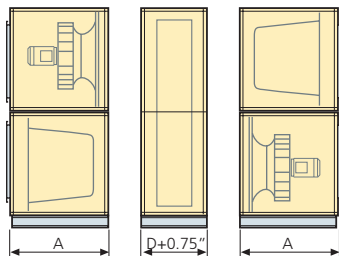

DIVISION INTO SECTIONS FOR TRANSPORT

The unit can be divided into three sections at the building site.

Dimensions: See A and D in the table above.

Weight: A = 730–840 lbs, D = 690 lbs.

CLEAR SPACE FOR INSPECTION

A clear space of 36 inches should be provided in front of the unit and at least 8 inches should be provided above the junction hood.

Power Connection		
	460/3/60	575/3/60
FLA	15.6	12.3
MCA	17.4	13.7
RFS	20	15

Sizing, Installation, Dimensions and Weight

GOLD RX, rotary heat exchanger, size 40

DELIVERY AND TRANSPORT WITHIN THE SITE

The GOLD RX 40 is always supplied as one unit. The air handling unit can be split into three sections to facilitate transporting it within the building site.

The three sections are joined together by bolts and the electrical and control cables have quick connectors.

The air handling unit is delivered on wooden pallets.

DUCT CONNECTION OPTIONS

A: Specify right-hand or left-hand version when ordering. If the air handling unit is supplied with all the end connection panels, the version can be changed at the building site by selecting the appropriate version in the hand-held micro terminal.

B: The arrangement of the functional sections can be vertically reversed. Specify this by selecting fan arrangement 1 or 2 when placing orders.

C: Specify upper fan outlet for upward air discharge when placing orders (not for outdoor units).

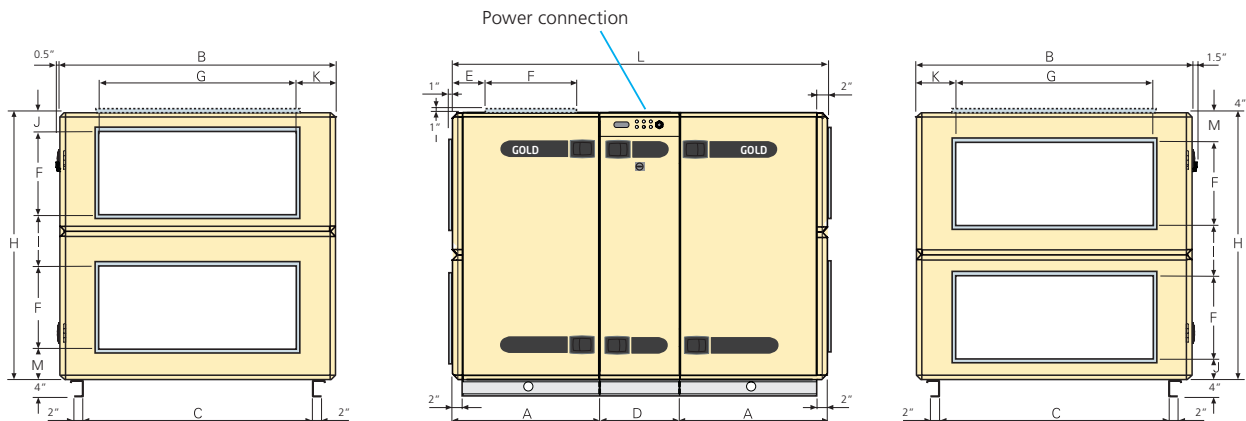
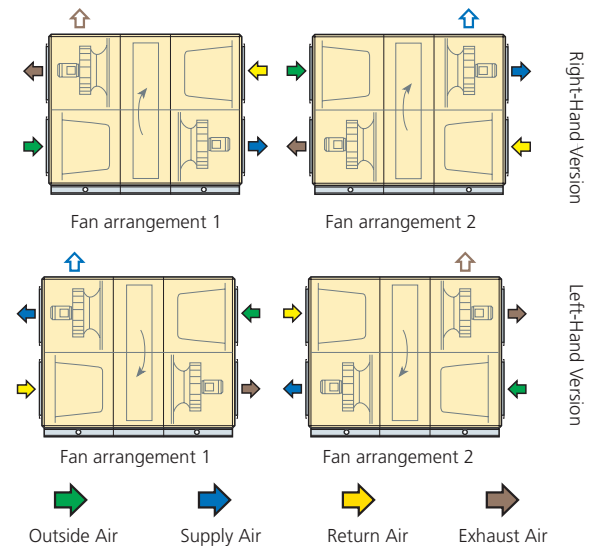

The dimension print shows the connection configuration for fan arrangement 1. For fan arrangement 2 the connections are mirror-inverted.
The air handling unit is supplied without end connection panel if a duct accessory housed in an insulated casing will be connected.

Size	A	B	C	D	E	F	G	H	I	J	K	L	M	Wgt (lb)	Airflow ERV	Airflow CWC
RX 40	37.3	78.3	70	21.7	7.7	24	56	78.2	15	5.9	11.2	96.3	9.3	2220-2470	8400 cfm	8400 cfm*

*based on 550 fpm

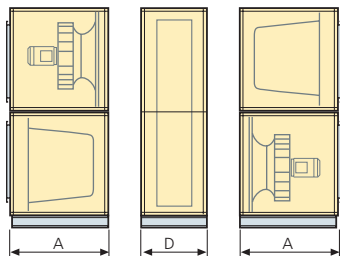

DIVISION INTO SECTIONS FOR TRANSPORT

The unit can be divided into three sections at the building site.

Dimensions: See A and D in the table above.

Weight: A = 765–890 lbs, D = 690 lbs.

CLEAR SPACE FOR INSPECTION

A clear space of 36 inches should be provided in front of the unit and at least 8 inches should be provided above the junction hood.

Power Connection		
	460/3/60	575/3/60
FLA	19.8	15.6
MCA	22.2	17.4
RFS	30	20

Sizing, Installation, Dimensions and Weight

GOLD RX, rotary heat exchanger, size 50

DELIVERY AND TRANSPORT WITHIN THE SITE

The GOLD RX 50 is supplied as two units. The one unit consists of the centre section with heat exchanger and the fan/filter section where the fan is mounted in the upper level. The other unit consists of a fan/filter section in which the fan is placed in the lower level.

The air handling unit can be split into three sections to facilitate transporting it within the building site.

The three sections are joined together by bolts and the electrical and control cables have quick connectors.

The unit is supplied on 4 inch high support feet made of steel.

DUCT CONNECTION OPTIONS

A: Specify right-hand or left-hand version when ordering

B: The arrangement of the functional sections can be vertically reversed. Specify this by selecting fan arrangement 1 or 2 when placing orders

C: Specify upper fan outlet for upward air discharge when ordering. (not for units installed outdoors)

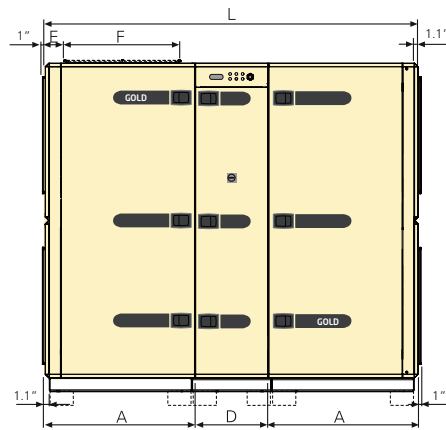
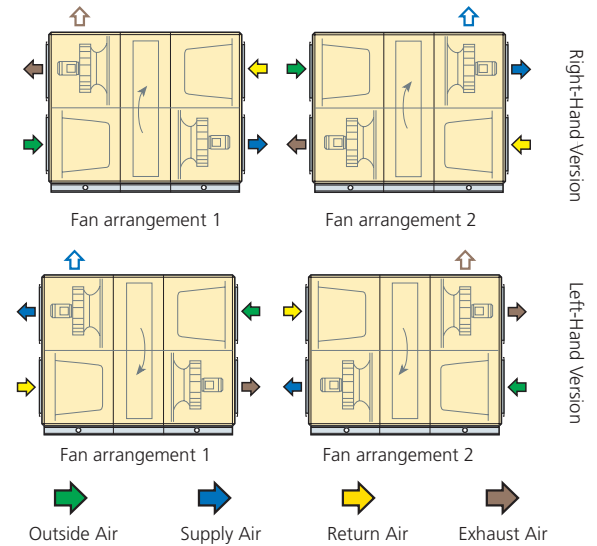

The air handling unit is supplied without end connection panel if a duct accessory housed in an insulated casing will be connected.

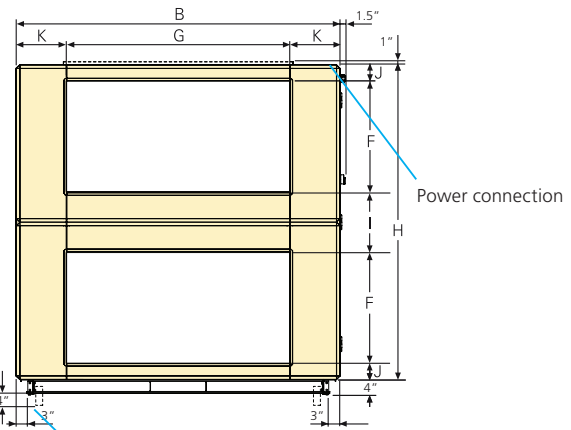

Supplied on 4 inch high support feet. They can be removed or kept as they are when the unit is in place. The unit has provision for fitting the adjustable support feet.

Size	A	B	D	E	F	G	H	I	J	K	L	Wgt (lbs)	Airflow ERV	Airflow CWC
RX 50	42	91.3	21	5.9	32	64	88.7	15.6	4.5	13.6	105	2850-3130	9700 cfm	9700 cfm*

*based on 550 fpm

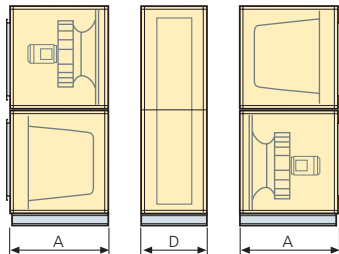

DIVISION INTO SECTIONS FOR TRANSPORT

The unit can be divided into three sections at the building site.

Dimensions: See A and D in the table above.

Weight: A = 970-1110 lbs, D = 915 lbs.

CLEAR SPACE FOR INSPECTION

A clear space of 44 inches should be provided in front of the unit.

Power Connection		
	460/3/60	575/3/60
FLA	24.3	19.9
MCA	25.6	20.9
RFS	30	20

Sizing, Installation, Dimensions and Weight

GOLD RX, rotary heat exchanger, size 60

DELIVERY AND TRANSPORT WITHIN THE SITE

The GOLD RX 60 is supplied as two units. The one unit consists of the centre section with heat exchanger and the fan/filter section where the fan is mounted in the upper level. The other unit consists of a fan/filter section in which the fan is placed in the lower level.

The air handling unit can be split into three sections to facilitate transporting it within the building site.

The three sections are joined together by bolts and the electrical and control cables have quick connectors.

The unit is supplied on 4 inch high support feet made of steel.

DUCT CONNECTION OPTIONS

A: Specify right-hand or left-hand version when ordering.

B: The arrangement of the functional sections can be vertically reversed. Specify this by selecting fan arrangement 1 or 2 when placing orders.

C: Specify upper fan outlet for upward air discharge when ordering. (not for units installed outdoors).

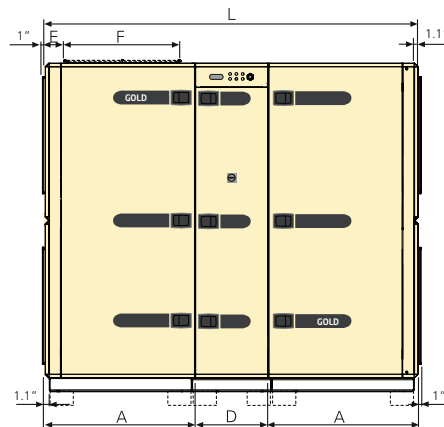
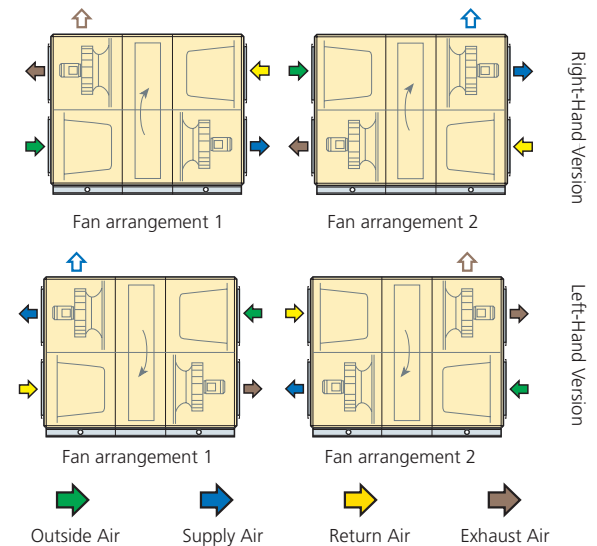

The air handling unit is supplied without end connection panel if a duct accessory housed in an insulated casing will be connected.

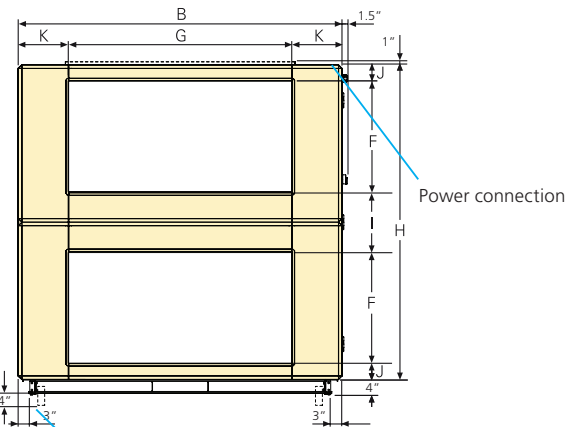

Supplied on 4 inch high support feet. They can be removed or kept as they are when the unit is in place. The unit has provision for fitting the adjustable support feet.

Size	A	B	D	E	F	G	H	I	J	K	L	Wgt (lbs)	Airflow ERV	Airflow CWC
RX 60	42	91.3	21	5.9	32	64	88.7	15.6	4.5	13.6	105	2850-3130	13700 cfm	10800 cfm*

*based on 550 fpm

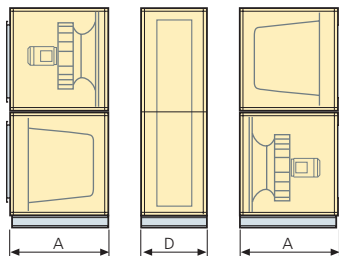

DIVISION INTO SECTIONS FOR TRANSPORT

The unit can be divided into three sections at the building site.

Dimensions: See A and D in the table above.

Weight: A = 970–1110 lbs, D = 915 lbs.

CLEAR SPACE FOR INSPECTION

A clear space of 44 inches should be provided in front of the unit.

Power Connection		
	460/3/60	575/3/60
FLA	42.1	33.9
MCA	44.5	35.7
RFS	50	40

Sizing, Installation, Dimensions and Weight

GOLD RX, rotary heat exchanger, size 70

DELIVERY AND TRANSPORT WITHIN THE SITE

The GOLD RX 70 is supplied as two units. The one unit consists of the centre section with heat exchanger and the fan/filter section where the fan is mounted in the upper level. The other unit consists of a fan/filter section in which the fan is placed in the lower level.

The air handling unit can be split into three sections to facilitate transporting it within the building site.

The three sections are joined together by bolts and the electrical and control cables have quick connectors.

The unit is supplied on 4 inch high support feet made of steel.

DUCT CONNECTION OPTIONS

A: Specify right-hand or left-hand version when ordering.

B: The arrangement of the functional sections can be vertically reversed. Specify this by selecting fan arrangement 1 or 2 when placing orders.

C: Specify upper fan outlet for upward air discharge when ordering. (not for units installed outdoors)

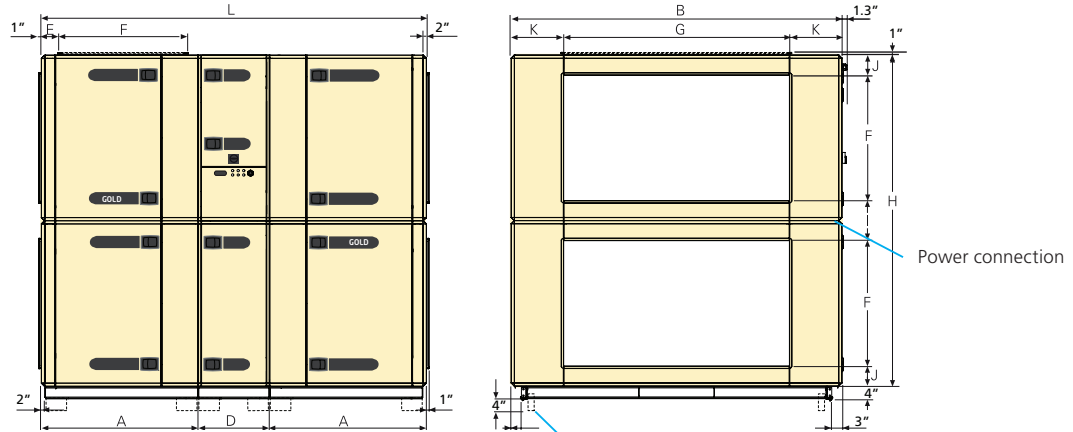
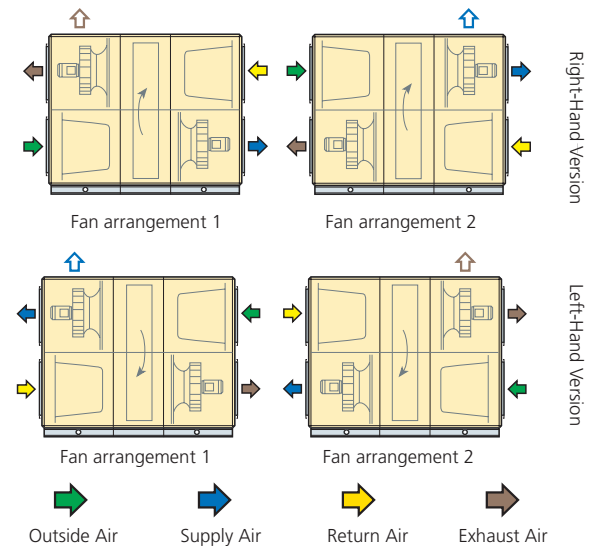

The air handling unit is supplied without end connection panel if a duct accessory housed in an insulated casing will be connected.

Supplied on 4 inch high support feet. They can be removed or kept as they are when the unit is in place. The unit has provision for fitting the adjustable support feet.

Size	A	B	D	E	F	G	H	I	J	K	L	Wgt (lbs)	Airflow ERV	Airflow CWC
RX 70	50.1	103.8	22.5	6	40	72	104	12	6	15.9	122.8	4540-4880	15800 cfm	15200 cfm*

*based on 550 fpm

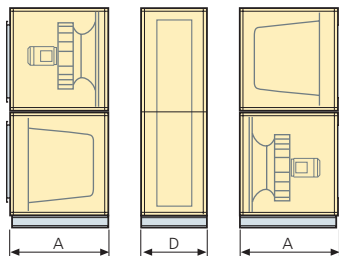

DIVISION INTO SECTIONS FOR TRANSPORT

The unit can be divided into three sections at the building site.

Dimensions: See A and D in the table above.

Weight: A = 1630–1800 lbs, D = 1280 lbs.

CLEAR SPACE FOR INSPECTION

A clear space of 44 inches should be provided in front of the unit.

Power Connection		
	460/3/60	575/3/60
FLA	42.1	33.9
MCA	44.5	35.7
RFS	50	40

Sizing, Installation, Dimensions and Weight

GOLD RX, rotary heat exchanger, size 80

DELIVERY AND TRANSPORT WITHIN THE SITE

The GOLD RX 80 is supplied as two units. The one unit consists of the centre section with heat exchanger and the fan/filter section where the fan is mounted in the upper level. The other unit consists of a fan/filter section in which the fan is placed in the lower level.

The air handling unit can be split into three sections to facilitate transporting it within the building site.

The three sections are joined together by bolts and the electrical and control cables have quick connectors.

The unit is supplied on 4 inch high support feet made of steel.

DUCT CONNECTION OPTIONS

A: Specify right-hand or left-hand version when ordering.

B: The arrangement of the functional sections can be vertically reversed. Specify this by selecting fan arrangement 1 or 2 when placing orders.

C: Specify upper fan outlet for upward air discharge when ordering. (not for units installed outdoors)

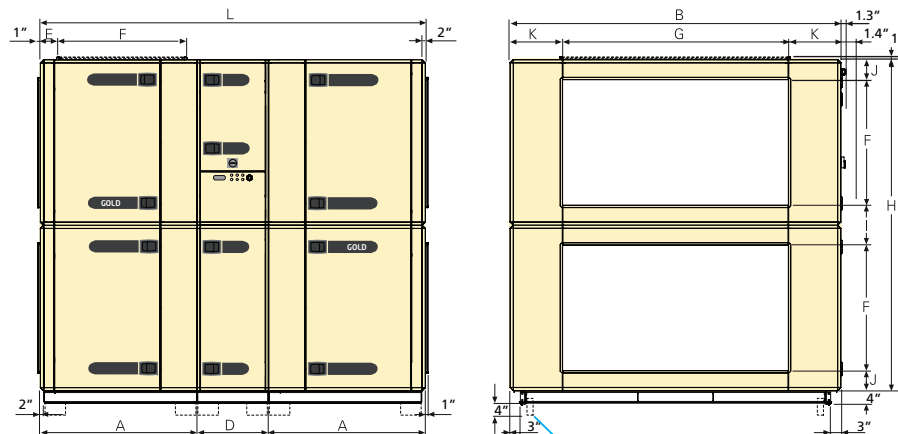
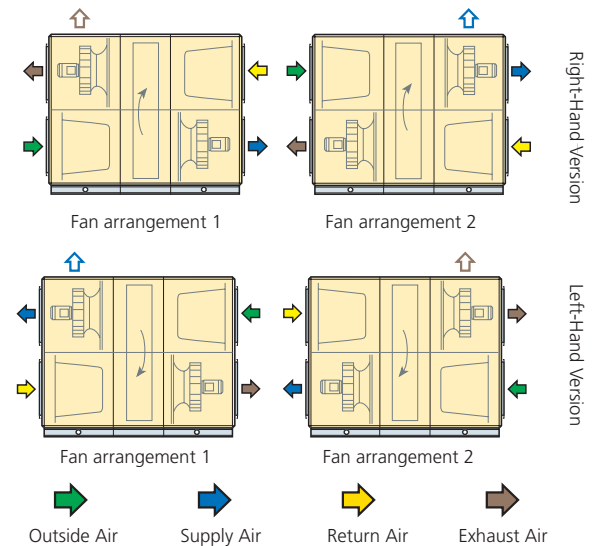

The air handling unit is supplied without end connection panel if a duct accessory housed in an insulated casing will be connected.

Supplied on 4 inch high support feet. They can be removed or kept as they are when the unit is in place. The unit has provision for fitting the adjustable support feet.

Size	A	B	D	E	F	G	H	I	J	K	L	Wgt (lbs)	Airflow ERV	Airflow CWC
RX 80	50.1	103.8	22.5	6	40	72	104	12	6	15.9	122.8	4540-4880	16300 cfm	15200 cfm*

*based on 550 fpm

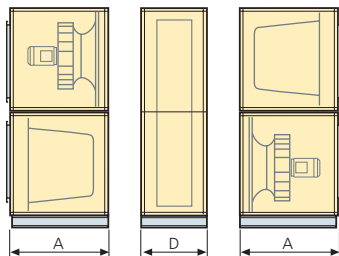

DIVISION INTO SECTIONS FOR TRANSPORT

The unit can be divided into three sections at the building site.

Dimensions: See A and D in the table above.

Weight: A = 1630–1800 lbs, D = 1280 lbs.

CLEAR SPACE FOR INSPECTION

A clear space of 44 inches should be provided in front of the unit.

Power Connection		
	460/3/60	575/3/60
FLA	42.1	33.9
MCA	44.5	35.7
RFS	50	40

Sizing, Installation, Dimensions and Weight

GOLD PX, plate heat exchanger, size 05

DELIVERY AND TRANSPORT WITHIN THE SITE

The GOLD PX 05 is produced in one single variant, in which all the components are arranged at their given physical locations inside the air handling unit.

The electrical cabinet and the drain pipe on the front of the air handling unit can be removed, if required, for transporting the unit within the building site.

The air handling unit is supplied on a wooden pallet.

The set of support legs, for mounting the base beams, is available as an accessory.

DUCT CONNECTION OPTIONS

A: Specify right-hand or left-hand version when ordering.

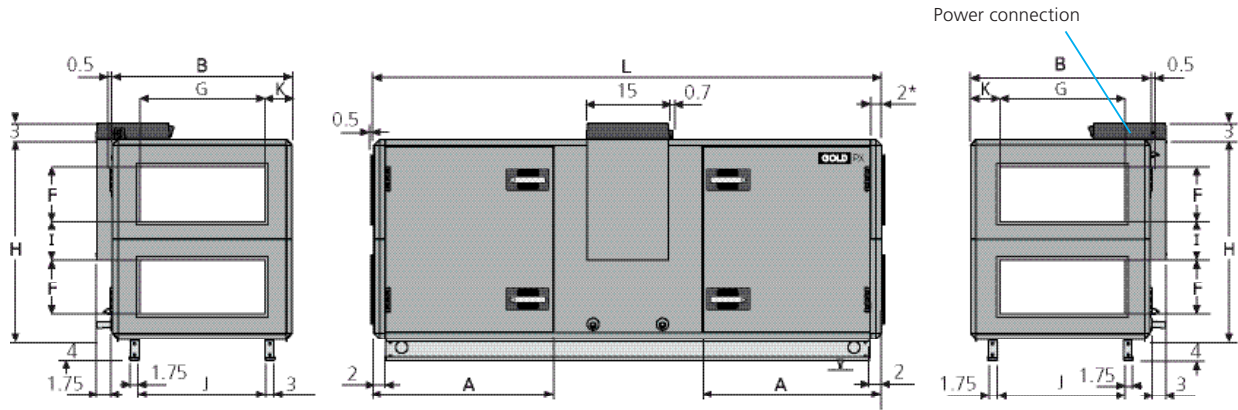
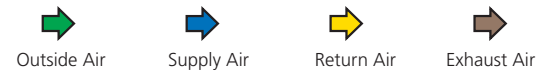
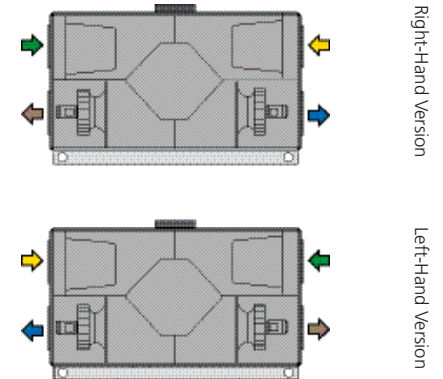

Size	A	B	F	G	H	I	J	K	L	Wgt (lb)	Airflow ERV	Airflow CWC
PX 05	32.4	32.5	12.0	18.0	36.2	6.1	22.8	7.2	91.9	768-851	1300 cfm	920 cfm*

*based on 550 fpm

CLEAR SPACE FOR INSPECTION

A clear space of 40 inches should be provided in front of the unit and at least 8 inches should be provided above the junction hood.

Power Connection	
	230/1/60
FLA	11.43
MCA	12.81
RFS	15

Sizing, Installation, Dimensions and Weight

GOLD PX, plate heat exchanger, size 07

DELIVERY AND TRANSPORT WITHIN THE SITE

The GOLD PX 07 is produced in one single variant, in which all the components are arranged at their given physical locations inside the air handling unit.

The electrical cabinet and the drain pipe on the front of the air handling unit can be removed, if required, for transporting the unit within the building site.

The air handling unit is supplied on a wooden pallet.

The set of support legs, for mounting the base beams, is available as an accessory.

DUCT CONNECTION OPTIONS

A: Specify right-hand or left-hand version when ordering.

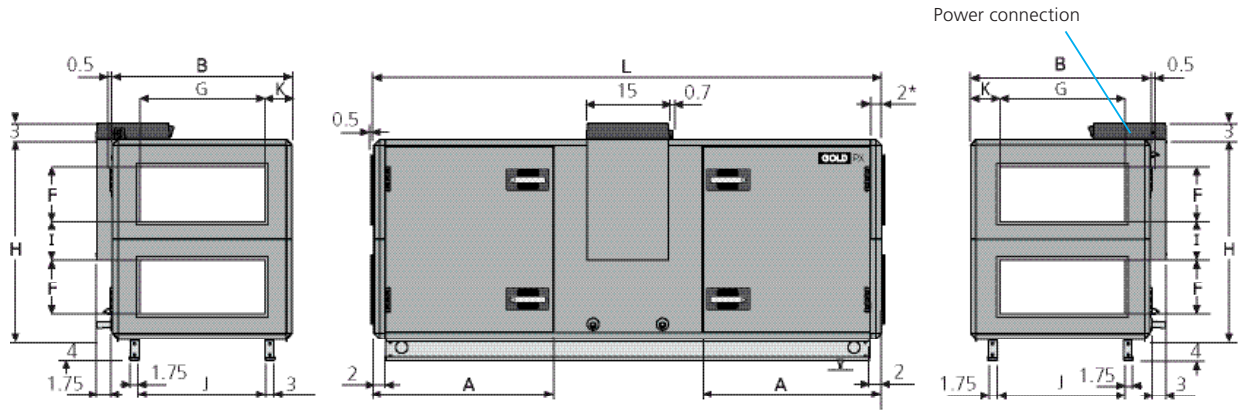
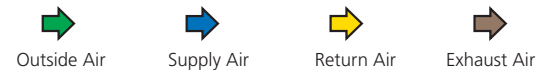
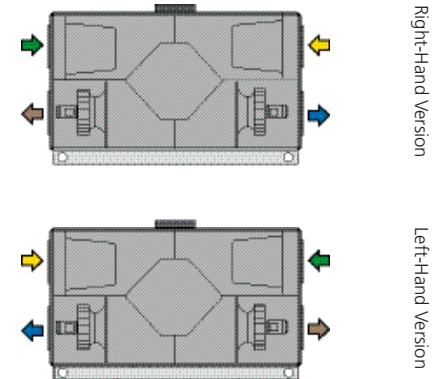

Size	A	B	F	G	H	I	J	K	L	Wgt (lb)	Airflow ERV	Airflow CWC
PX 07	35.9	39.2	14.0	24.0	42.7	7.4	29.5	7.6	98.5	957-1082	1500 cfm	1420 cfm*

*based on 550 fpm

CLEAR SPACE FOR INSPECTION

A clear space of 40 inches should be provided in front of the unit and at least 8 inches should be provided above the junction hood.

Power Connection	
	230/1/60
FLA	11.43
MCA	12.81
RFS	15

Sizing, Installation, Dimensions and Weight

GOLD PX, plate heat exchanger, size 08

DELIVERY AND TRANSPORT WITHIN THE SITE

The GOLD PX 08 is produced in one single variant, in which all the components are arranged at their given physical locations inside the air handling unit.

The electrical cabinet and the drain pipe on the front of the air handling unit can be removed, if required, for transporting the unit within the building site.

The air handling unit is supplied on a wooden pallet.

The set of support legs, for mounting the base beams, is available as an accessory.

DUCT CONNECTION OPTIONS

A: Specify right-hand or left-hand version when ordering.

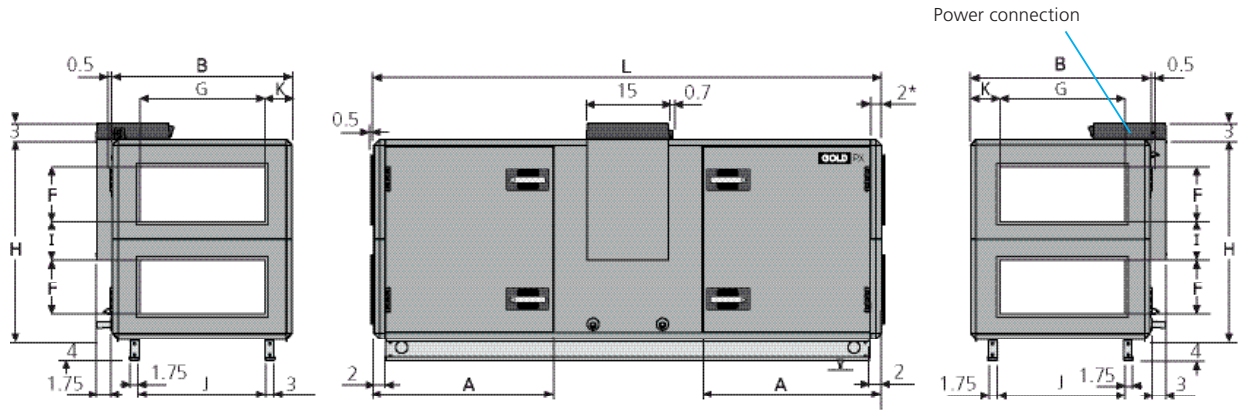
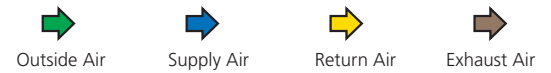
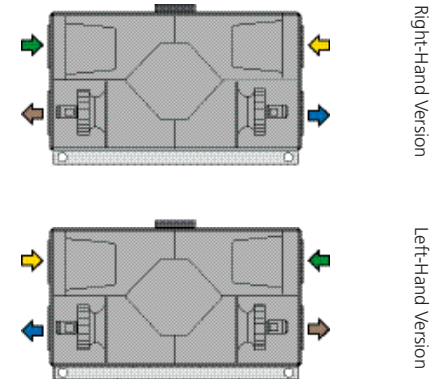

If a water trap (accessory) is fitted, the air handling unit must be raised at least 2 inches to provide space for the water trap. Support feet (accessories) can be used for this purpose. *The air handling unit is supplied without end connection panel if a duct accessory housed in an insulated casing will be connected.*

Size	A	B	F	G	H	I	J	K	L	Wgt (lb)	Airflow ERV	Airflow CWC
PX 08	35.9	39.2	14.0	24.0	42.7	7.4	29.5	7.6	98.5	988-1113	2000 cfm	1420 cfm*

*based on 550 fpm

CLEAR SPACE FOR INSPECTION

A clear space of 40 inches should be provided in front of the unit and at least 8 inches should be provided above the junction hood.

Power Connection	
	230/1/60
FLA	11.43
MCA	12.81
RFS	15

Sizing, Installation, Dimensions and Weight

GOLD PX, plate heat exchanger, size 11

DELIVERY AND TRANSPORT WITHIN THE SITE

The GOLD PX 11 is always supplied as one unit. The air handling unit can be split into multiple sections to facilitate transporting it within the building site.

The multiple sections are joined together by bolts and the electrical and control cables between the sections have quick-fit connectors. The air handling unit is delivered on wooden pallets.

The electrical cabinet and the drain pipe on the front of the air handling unit can be removed, if required, for transporting the unit within the building site.

A: Specify right-hand or left-hand version when ordering.

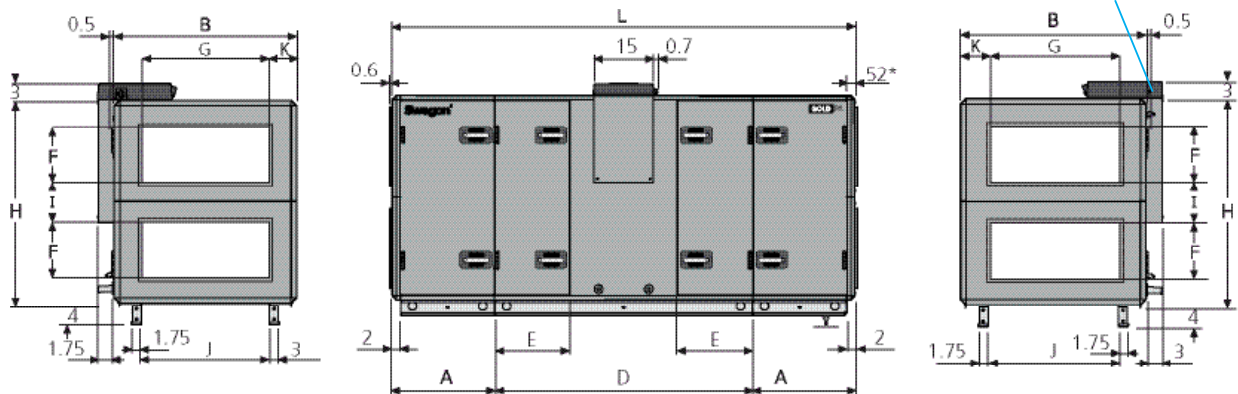
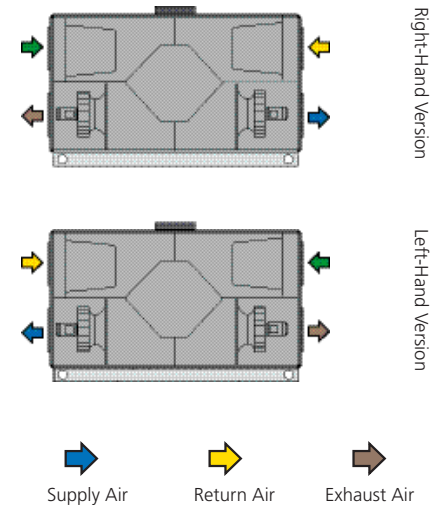

If a water trap (accessory) is fitted, the air handling unit must be raised at least 2 inches to provide space for the water trap. Support feet (accessories) can be used for this purpose. *The air handling unit is supplied without end connection panel if a duct accessory housed in an insulated casing will be connected.*

Size	A	B	D	E	F	G	H	I	J	K	L	Wgt (lb)	Airflow ERV	Airflow CWC
PX 11	25.5	47.2	64.2	18.5	18.0	32.0	51.0	7.5	37.5	7.6	115.2	1571-1769	2300 cfm	2300 cfm*

*based on 550 fpm

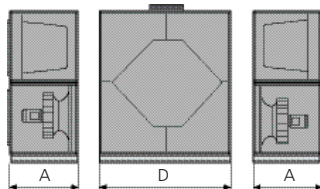

DIVISION INTO SECTIONS FOR TRANSPORT

The unit can be divided into three sections at the building site.

Dimensions: See A and D in the table above.

Weight: A = 297-385 lbs, D = 977-1518 lbs.

CLEAR SPACE FOR INSPECTION

A clear space of 36 inches should be provided in front of the unit and at least 8 inches should be provided above the junction hood.

Power Connection	
	230/1/60
FLA	11.43
MCA	12.81
RFS	15

Sizing, Installation, Dimensions and Weight

GOLD PX, plate heat exchanger, size 12

DELIVERY AND TRANSPORT WITHIN THE SITE

The GOLD PX 12 is always supplied as one unit. The air handling unit can be split into multiple sections to facilitate transporting it within the building site.

The multiple sections are joined together by bolts and the electrical and control cables between the sections have quick-fit connectors. The air handling unit is delivered on wooden pallets.

The electrical cabinet and the drain pipe on the front of the air handling unit can be removed, if required, for transporting the unit within the building site.

A: Specify right-hand or left-hand version when ordering.

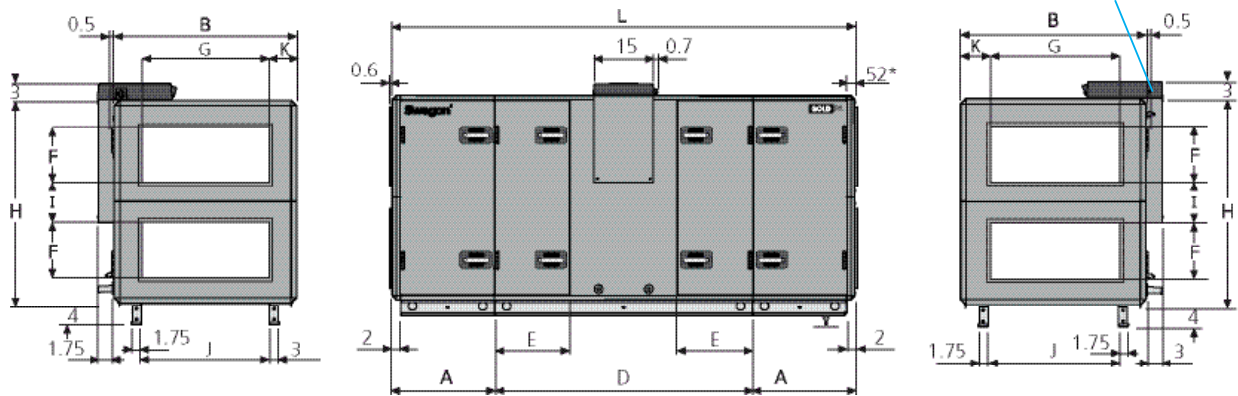
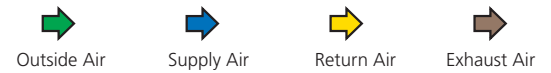
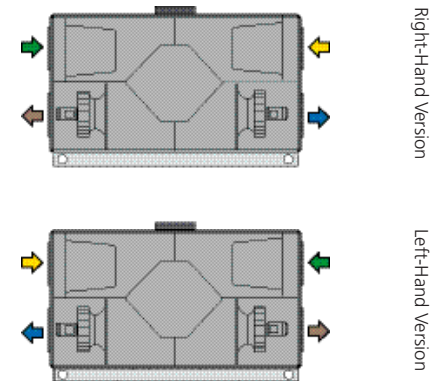

Size	A	B	D	E	F	G	H	I	J	K	L	Wgt (lb)	Airflow ERV	Airflow CWC
PX 12	25.5	47.2	47.2	18.5	18.5	32.0	51.0	7.5	37.5	7.6	115.2	1619-1830	2850 cfm	2480 cfm*

*based on 550 fpm

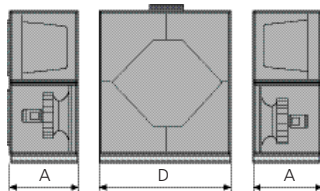

DIVISION INTO SECTIONS FOR TRANSPORT

The unit can be divided into three sections at the building site.

Dimensions: See A and D in the table above.

Weight: A = 322-416 lbs, D = 977-999 lbs.

CLEAR SPACE FOR INSPECTION

A clear space of 36 inches should be provided in front of the unit and at least 8 inches should be provided above the junction hood.

Power Connection		
	460/3/60	575/3/60
FLA	7.4	5.8
MCA	8.3	6.5
RFS	15	15

Sizing, Installation, Dimensions and Weight

GOLD PX, plate heat exchanger, size 14

DELIVERY AND TRANSPORT WITHIN THE SITE

The GOLD PX 14 is always supplied as one unit. The air handling unit can be split into multiple sections to facilitate transporting it within the building site.

The multiple sections are joined together by bolts and the electrical and control cables have quick connectors.

The air handling unit is delivered on wooden pallets.

The electrical equipment cubicle and the drain pipe on the front of the air handling unit can be removed, if required, for transporting the unit within the building site.

DUCT CONNECTION OPTIONS

A: Specify right-hand or left-hand version when ordering.

B: Specify whether the unit shall have an air intake from above for outdoor air and/or return air when placing orders (not for outdoor units).

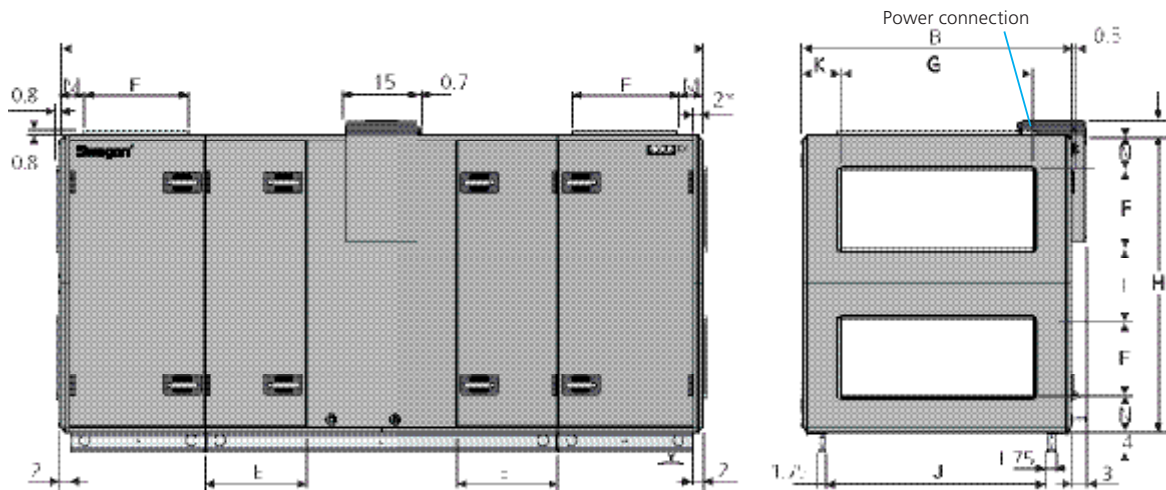
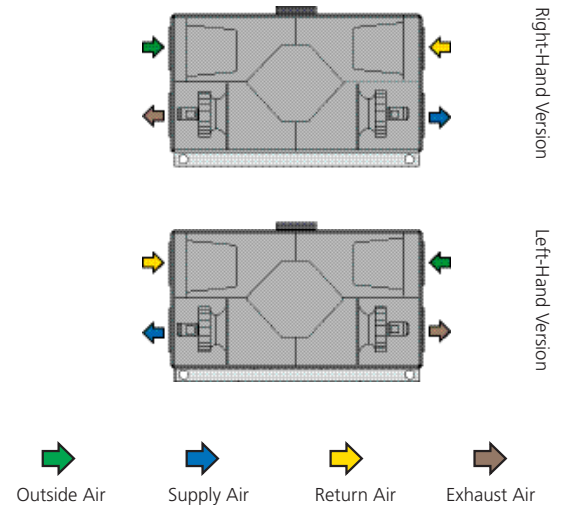

The air handling unit is supplied without end connection panel if a duct accessory housed in an insulated casing will be connected.

Size	A	B	D	E	F	G	H	I	J	K	L	M	N	Wgt (lb)	Airflow ERV	Airflow CWC
PX 14	29.8	55.1	72.3	20.8	16.0	40.0	61.1	17.9	45.4	7.6	131.9	8.1	7.4	2044-2308	3150 cfm	3150 cfm*

*based on 550 fpm

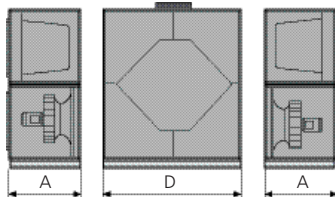

DIVISION INTO SECTIONS FOR TRANSPORT

The unit can be divided into three sections at the building site.

Dimensions: See A and D in the table above.

Weight: A = 48-537 lbs, D = 1208-1235 lbs.

CLEAR SPACE FOR INSPECTION

A clear space of 36 inches should be provided in front of the unit and at least 8 inches should be provided above the junction hood.

Power Connection		
	460/3/60	575/3/60
FLA	7.4	5.8
MCA	8.3	6.5
RFS	15	15

Sizing, Installation, Dimensions and Weight

GOLD PX, plate heat exchanger, size 20

DELIVERY AND TRANSPORT WITHIN THE SITE

The GOLD PX 20 is always supplied as one unit. The air handling unit can be split into multiple sections to facilitate transporting it within the building site.

The multiple sections are joined together by bolts and the electrical and control cables have quick connectors.

The air handling unit is delivered on wooden pallets.

The electrical equipment cubicle and the drain pipe on the front of the air handling unit can be removed, if required, for transporting the unit within the building site.

DUCT CONNECTION OPTIONS

A: Specify right-hand or left-hand version when ordering.

B: Specify whether the unit shall have an air intake from above for outdoor air and/or return air when placing orders (not for outdoor units).

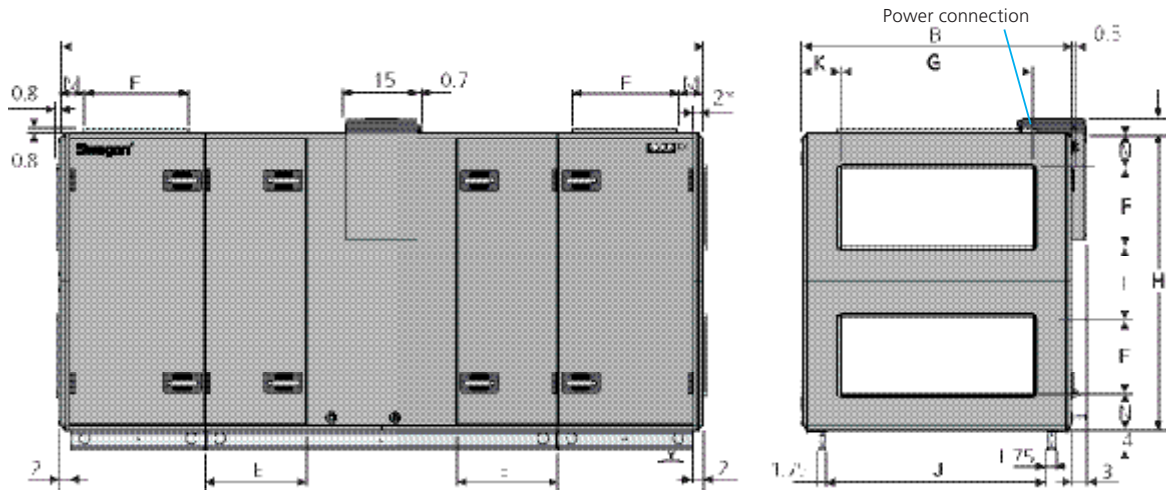
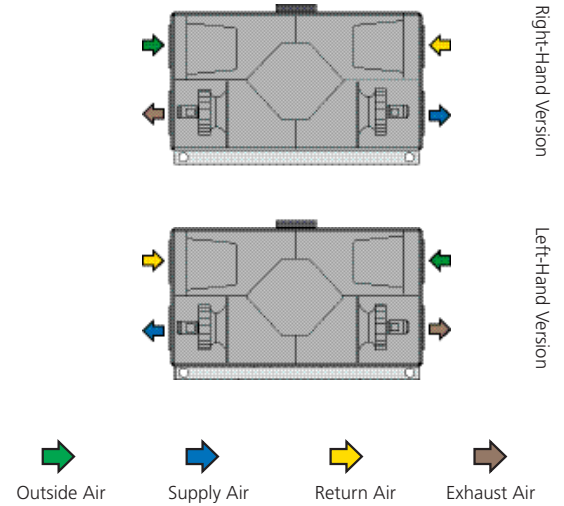

The air handling unit is supplied without end connection panel if a duct accessory housed in an insulated casing will be connected.

Size	A	B	D	E	F	G	H	I	J	K	L	M	N	Wgt (lb)	Airflow ERV	Airflow CWC
PX 20	29.8	55.1	72.3	20.8	16.0	40.0	61.1	17.9	45.4	7.6	131.9	8.1	7.4	2088-2396	4200 cfm	3700 cfm*

*based on 550 fpm

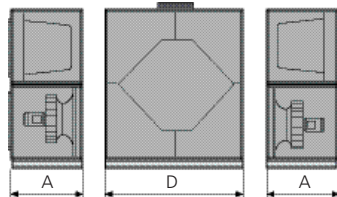

DIVISION INTO SECTIONS FOR TRANSPORT

The unit can be divided into three sections at the building site.

Dimensions: See A and D in the table above.

Weight: A = 440-581 lbs, D = 1208-1235 lbs.

CLEAR SPACE FOR INSPECTION

A clear space of 36 inches should be provided in front of the unit and at least 8 inches should be provided above the junction hood.

Power Connection		
	460/3/60	575/3/60
FLA	10.4	8.2
MCA	11.7	9.2
RFS	15	15

Sizing, Installation, Dimensions and Weight

GOLD PX, plate heat exchanger, size 25

DELIVERY AND TRANSPORT WITHIN THE SITE

The GOLD PX 25 is supplied as two units. The one unit consists of the centre section with heat exchanger and the fan/filter section to the right of the centre section (viewed from the inspection side). The other unit consists of a fan/filter section to the left of the centre section (viewed from the inspection side). The air handling unit can be split into multiple sections to facilitate transporting it within the building site. The multiple sections are joined together by bolts and the electrical and control cables have quick connectors.

The air handling unit is delivered on wooden pallets. The electrical equipment cubicle and the drain pipe on the front of the air handling unit can be removed, if required, for transporting the unit within the building site.

DUCT CONNECTION OPTIONS

A: Specify right-hand or left-hand version when ordering.

B: Specify whether the unit shall have an air intake from above for outdoor air and/or return air when placing orders (not for outdoor units).

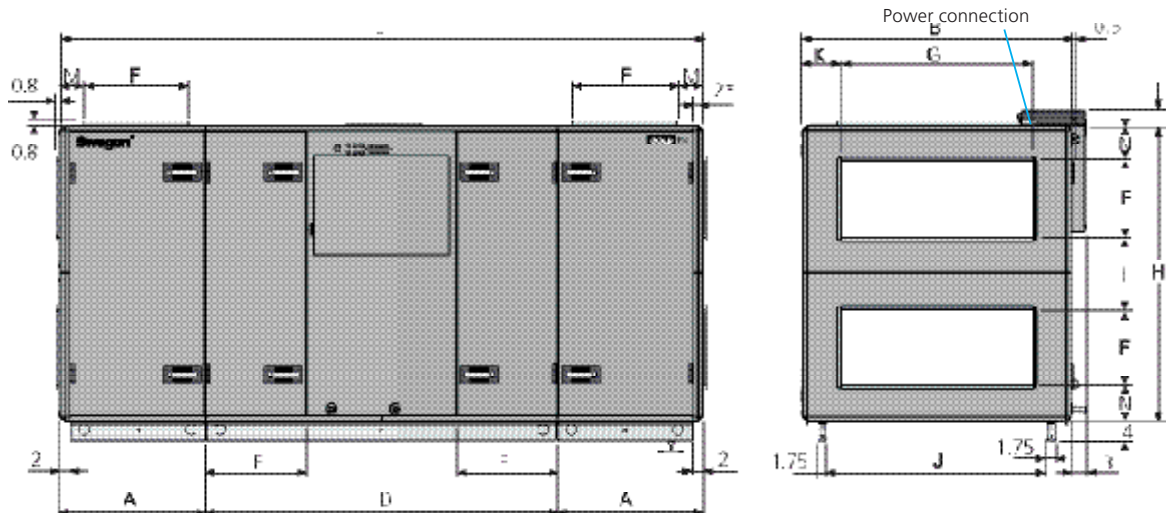
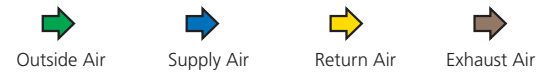
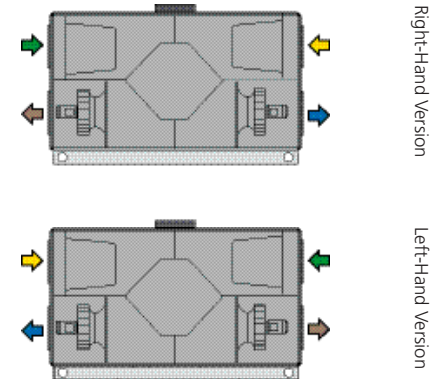

The air handling unit is supplied without end connection panel if a duct accessory housed in an insulated casing will be connected.

Size	A	B	D	E	F	G	H	I	J	K	L	M	N	Wgt (lb)	Airflow ERV	Airflow CWC
PX 25	33.4	63.0	83.9	26.6	20.0	48.0	71.3	20.2	53.3	7.5	150.6	7.9	8.0	2717-3139	4750 cfm	4750 cfm*

*based on 550 fpm

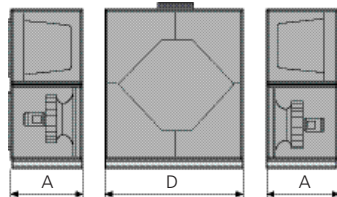

DIVISION INTO SECTIONS FOR TRANSPORT

The unit can be divided into three sections at the building site.

Dimensions: See A and D in the table above.

Weight: A = 548-733 lbs, D = 1622-1675 lbs.

CLEAR SPACE FOR INSPECTION

A clear space of 36 inches should be provided in front of the unit.

Power Connection		
	460/3/60	575/3/60
FLA	10.4	8.2
MCA	11.7	9.2
RFS	15	15

Sizing, Installation, Dimensions and Weight

GOLD PX, plate heat exchanger, size 30

DELIVERY AND TRANSPORT WITHIN THE SITE

The GOLD PX 30 is supplied as two units. The one unit consists of the centre section with heat exchanger and the fan/filter section to the right of the centre section (viewed from the inspection side). The other unit consists of a fan/filter section to the left of the centre section (viewed from the inspection side). The air handling unit can be split into multiple sections to facilitate transporting it within the building site. The multiple sections are joined together by bolts and the electrical and control cables have quick connectors.

The air handling unit is delivered on wooden pallets.

The electrical equipment cubicle and the drain pipe on the front of the air handling unit can be removed, if required, for transporting the unit within the building site.

DUCT CONNECTION OPTIONS

A: Specify right-hand or left-hand version when ordering.

B: Specify whether the unit shall have an air intake from above for outdoor air and/or return air when placing orders (not for outdoor units).

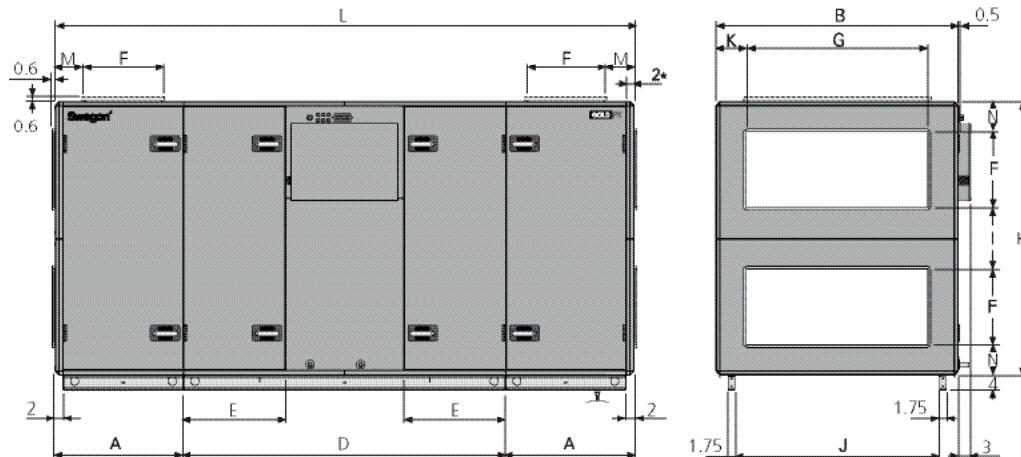
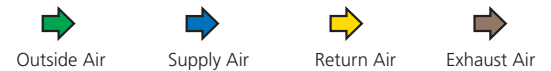
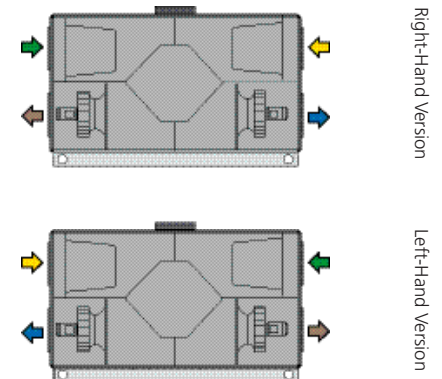

The air handling unit is supplied without end connection panel if a duct accessory housed in an insulated casing will be connected.

Size	A	B	D	E	F	G	H	I	J	K	L	M	N	Wgt (lb)	Airflow ERV	Airflow CWC
PX 30	33.4	63.0	83.9	26.6	20.0	48.0	71.3	20.2	53.3	7.5	150.6	7.9	8.0	2831-3192	5800 cfm	5260 cfm*

*based on 550 fpm

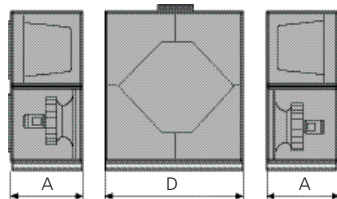

DIVISION INTO SECTIONS FOR TRANSPORT

The unit can be divided into three sections at the building site.

Dimensions: See A and D in the table above.

Weight: A = 605-759 lbs, D = 1622-1675 lbs.

CLEAR SPACE FOR INSPECTION

A clear space of 36 inches should be provided in front of the unit and at least 8 inches should be provided above the junction hood.

Power Connection		
	460/3/60	575/3/60
FLA	15.1	11.9
MCA	17	13.3
RFS	20	15

Sizing, Installation, Dimensions and Weight

GOLD PX, plate heat exchanger, size 35

DELIVERY AND TRANSPORT WITHIN THE SITE

The GOLD PX 35 is supplied as two units. The one unit consists of the centre section with heat exchanger and the fan/filter section to the right of the centre section (viewed from the inspection side). The other unit consists of a fan/filter section to the left of the centre section (viewed from the inspection side). The air handling unit can be split into three sections to facilitate transporting it within the building site. The three sections are joined together by bolts and the electrical and control cables have quick connectors.

The air handling unit is delivered on wooden pallets.

The electrical equipment cubicle and the drain pipe on the front of the air handling unit can be removed, if required, for transporting the unit within the building site.

DUCT CONNECTION OPTIONS

A: Specify right-hand or left-hand version when ordering.

B: Specify whether the unit shall have an air intake from above for outdoor air and/or return air when placing orders (not for outdoor units).

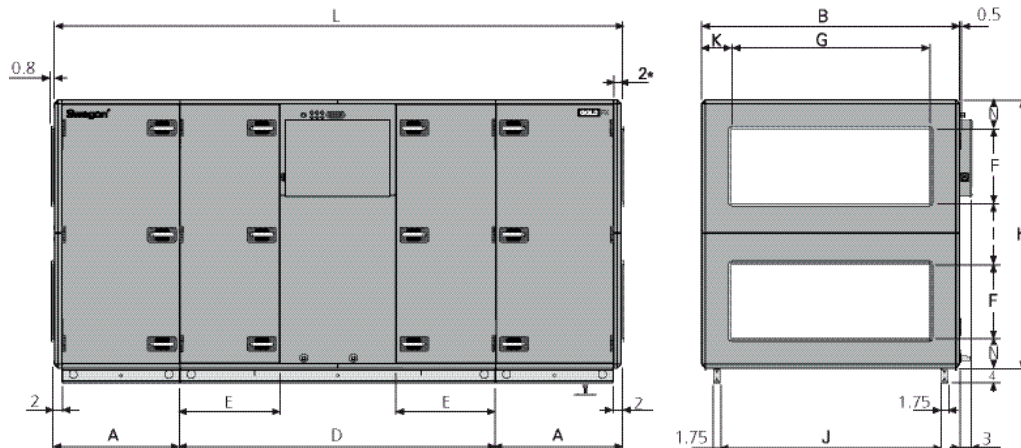
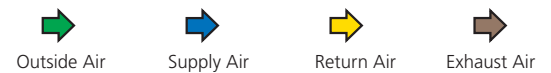
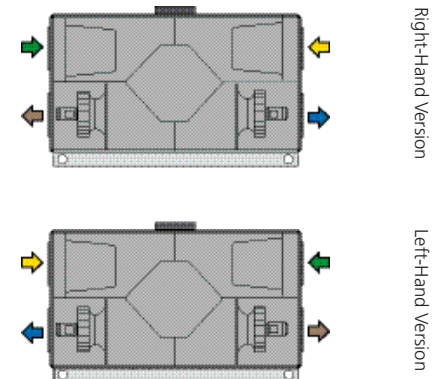

The air handling unit is supplied without end connection panel if a duct accessory housed in an insulated casing will be connected.

Size	A	B	D	E	F	G	H	I	J	K	L	N	Wgt (lb)	Airflow ERV	Airflow CWC
PX 35	40.9	78.3	94.5	31.7	24.0	56.0	85.0	22.3	68.7	11.2	176.3	9.4	3942-4484	7000 cfm	7000 cfm*

*based on 550 fpm

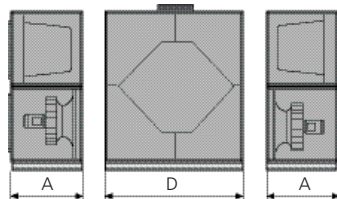

DIVISION INTO SECTIONS FOR TRANSPORT

The unit can be divided into three sections at the building site.

Dimensions: See A and D in the table above.

Weight: A = 830-1060 lbs, D = 2284-2363 lbs.

CLEAR SPACE FOR INSPECTION

A clear space of 44 inches should be provided in front of the unit.

Power Connection		
	460/3/60	575/3/60
FLA	15.1	11.9
MCA	17	13.3
RFS	20	15

Sizing, Installation, Dimensions and Weight

GOLD PX, plate heat exchanger, size 40

DELIVERY AND TRANSPORT WITHIN THE SITE

The GOLD PX 40 is supplied as two units. The one unit consists of the centre section with heat exchanger and the fan/filter section to the right of the centre section (viewed from the inspection side). The other unit consists of a fan/filter section to the left of the centre section (viewed from the inspection side). The air handling unit can be split into three sections to facilitate transporting it within the building site. The three sections are joined together by bolts and the electrical and control cables have quick connectors.

The air handling unit is delivered on wooden pallets.

The electrical equipment cubicle and the drain pipe on the front of the air handling unit can be removed, if required, for transporting the unit within the building site.

DUCT CONNECTION OPTIONS

A: Specify right-hand or left-hand version when ordering.

B: Specify whether the unit shall have an air intake from above for outdoor air and/or return air when placing orders (not for outdoor units).

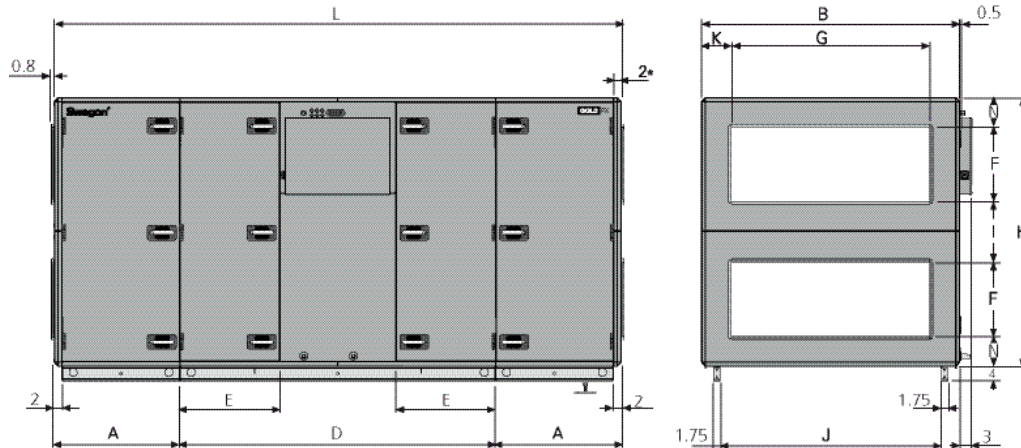
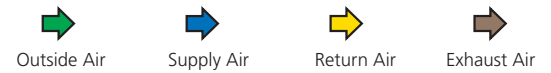
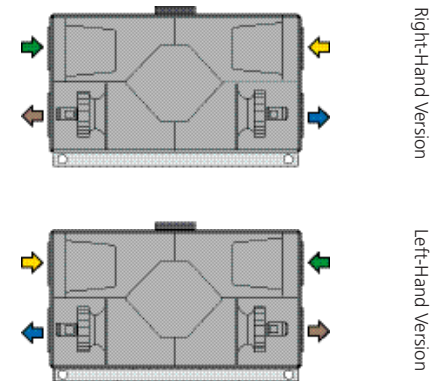

The air handling unit is supplied without end connection panel if a duct accessory housed in an insulated casing will be connected.

Size	A	B	D	E	F	G	H	I	J	K	L	N	Wgt (lb)	Airflow ERV	Airflow CWC
PX 40	40.9	78.3	94.5	31.7	24.0	56.0	85.0	22.3	68.7	11.2	176.3	9.4	4000-4541	8400 cfm	8400 cfm*

*based on 550 fpm

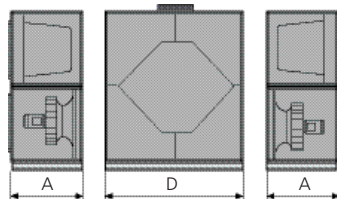

DIVISION INTO SECTIONS FOR TRANSPORT

The unit can be divided into three sections at the building site.

Dimensions: See A and D in the table above.

Weight: A = 858-1089 lbs, D = 2284-2363 lbs.

CLEAR SPACE FOR INSPECTION

A clear space of 44 inches should be provided in front of the unit.

Power Connection		
	460/3/60	575/3/60
FLA	15.1	11.9
MCA	17	13.3
RFS	20	15

GOLD SD, size 12

Sizing, Installation, Dimensions and Weight

GOLD SD, size 14

DELIVERY AND TRANSPORT WITHIN THE SITE

The GOLD SD 14 units are available in right-hand or left-hand version as a fan section, fan + filter or fan + filter + coil heat exchanger.

The unit is always supplied as one unit. The air handling unit can be split at the building site to facilitate transporting it within the site. The sections are jointed together by means of bolts.

The GOLD SD can be used as a supply air or an return air handling unit. If both supply air and return air handling units are used in a ventilation system, the supply air unit is fitted with a control unit and the return air unit is without. A communication cable is used to connect them to one another making it possible to control both units.

The air handling unit is delivered on wooden pallets.

DUCT CONNECTION OPTIONS

A: Specify right-hand or left-hand version when ordering!

B: Specify fan outlet for upward air discharge when placing orders (not applicable to outdoor units).

CLEAR SPACE FOR INSPECTION

A clear space of 36 inches should be provided in front of the unit.

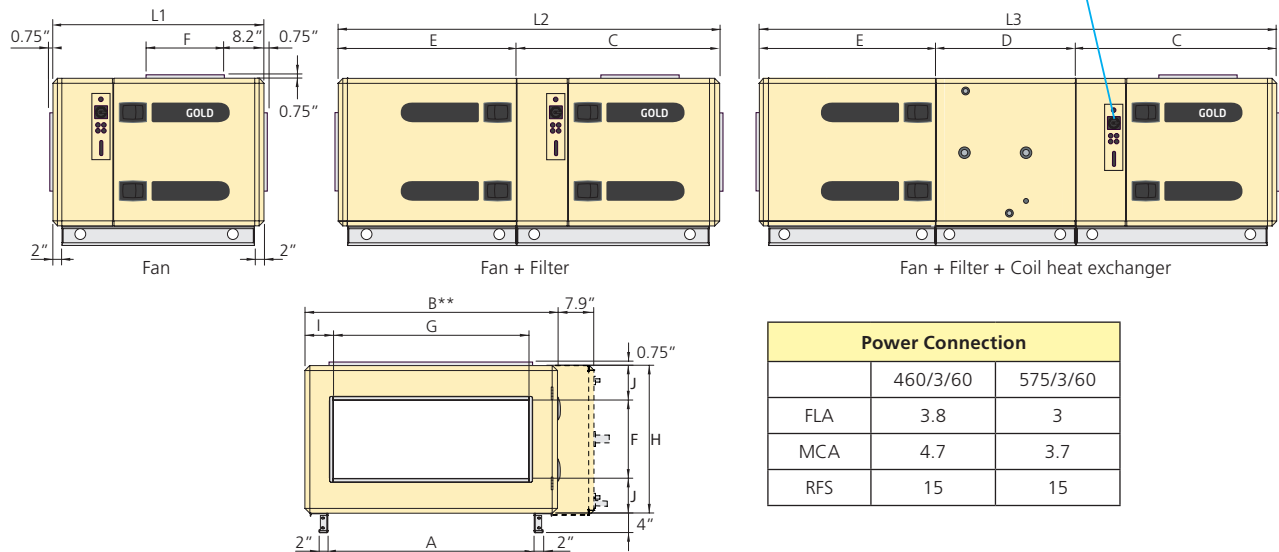
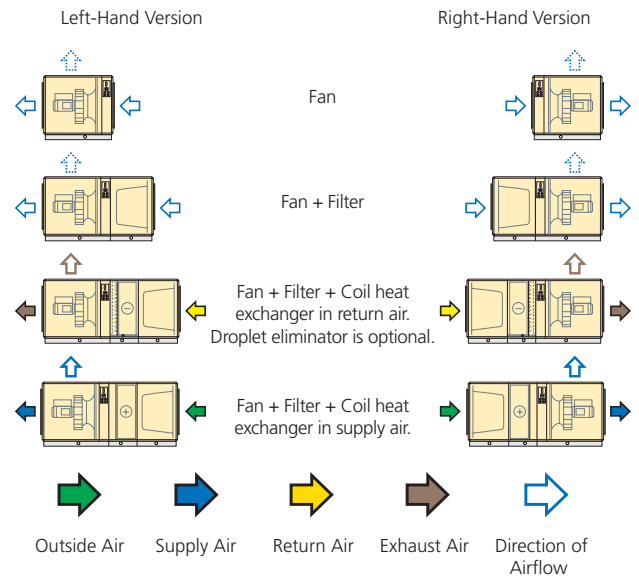

* The air handling unit is supplied without end connection panel if a duct accessory housed in an insulated casing will be connected.

** Width of coil heat exchanger (if required) = B + 7.9 inches.

Size	L1	L2	L3	B	H	A	C	D	E	F	G	I	J
SD14	40.9	73.8	102.9	55.1	31.7	44.7	38.9	29.1	34.9	16	40	7.6	5.85

Airflow ERV	Airflow CWC	Fan Wgt (lbs)	Fan + Filter Wgt (lbs)	Fan + Filter + Coil Wgt (lbs)
3600 cfm	3600 cfm (based on 550 fpm)	375–415	560–645	1060–1140

Sizing, Installation, Dimensions and Weight

GOLD SD, size 20

DELIVERY AND TRANSPORT WITHIN THE SITE

The GOLD SD 20 units are available in right-hand or left-hand version as a fan section, fan + filter or fan + filter + coil heat exchanger.

The unit is always supplied as one unit. The air handling unit can be split at the building site to facilitate transporting it within the site. The sections are jointed together by means of bolts.

The GOLD SD can be used as a supply air or an return air handling unit. If both supply air and return air handling units are used in a ventilation system, the supply air unit is fitted with a control unit and the return air unit is without. A communication cable is used to connect them to one another making it possible to control both units.

The air handling unit is delivered on wooden pallets.

DUCT CONNECTION OPTIONS

A: Specify right-hand or left-hand version when ordering!
B: Specify fan outlet for upward air discharge when placing orders (not applicable to outdoor units).

CLEAR SPACE FOR INSPECTION

A clear space of 36 inches should be provided in front of the unit.

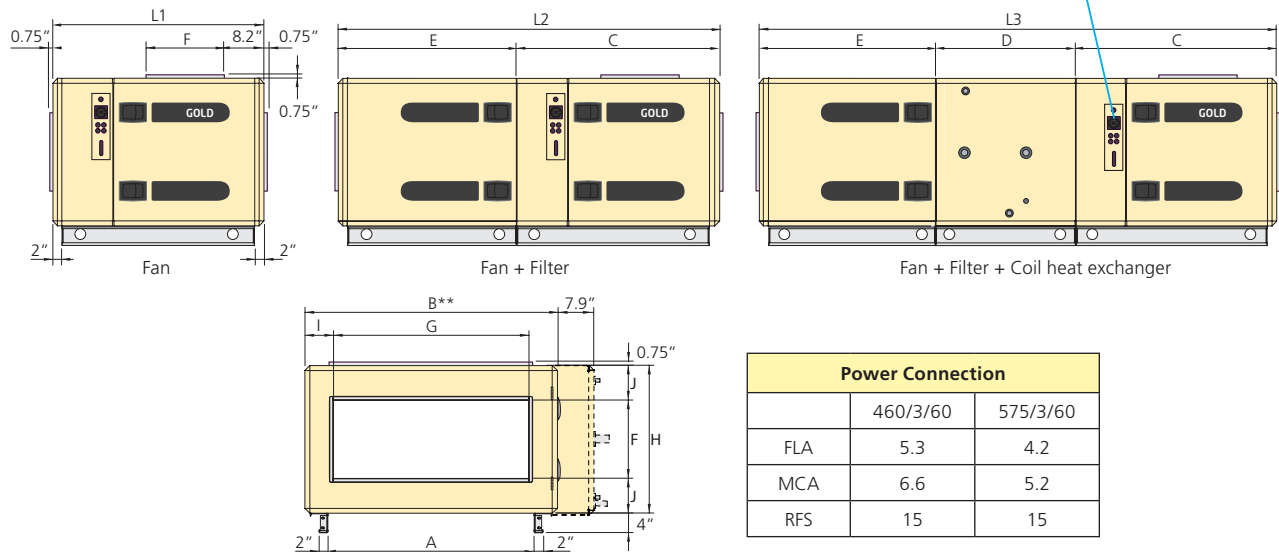
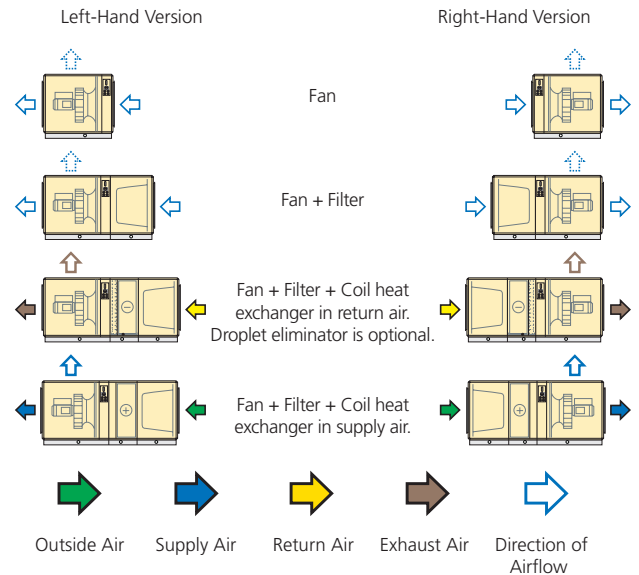

* The air handling unit is supplied without end connection panel if a duct accessory housed in an insulated casing will be connected.

** Width of coil heat exchanger (if required) = B + 7.9 inches.

Size	L1	L2	L3	B	H	A	C	D	E	F	G	I	J
SD 20	40.9	73.8	102.9	55.1	31.7	44.7	38.9	29.1	34.9	16	40	7.6	5.85

Airflow ERV	Airflow CWC	Fan Wgt (lbs)	Fan + Filter Wgt (lbs)	Fan + Filter + Coil Wgt (lbs)
5600 cfm	3700 cfm (based on 550 fpm)	415-455	600-685	1100-1180

Sizing, Installation, Dimensions and Weight

GOLD SD, size 25

DELIVERY AND TRANSPORT WITHIN THE SITE

The GOLD SD 25 units are available in right-hand or left-hand version as a fan section, fan + filter or fan + filter + coil heat exchanger.

The unit is always supplied as one unit. The air handling unit can be split at the building site to facilitate transporting it within the site. The sections are jointed together by means of bolts.

The GOLD SD can be used as a supply air or an return air handling unit. If both supply air and return air handling units are used in a ventilation system, the supply air unit is fitted with a control unit and the return air unit is without. A communication cable is used to connect them to one another making it possible to control both units.

The air handling unit is delivered on wooden pallets.

DUCT CONNECTION OPTIONS

A: Specify right-hand or left-hand version when ordering!

B: Specify fan outlet for upward air discharge when placing orders (not applicable to outdoor units).

CLEAR SPACE FOR INSPECTION

A clear space of 36 inches should be provided in front of the unit.

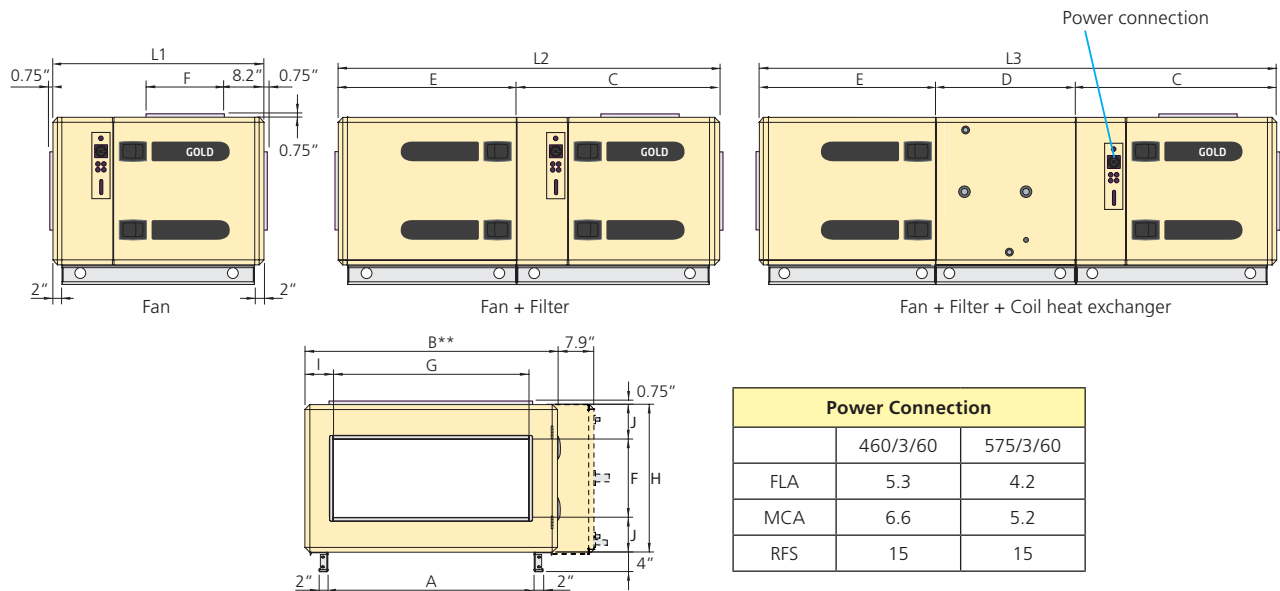
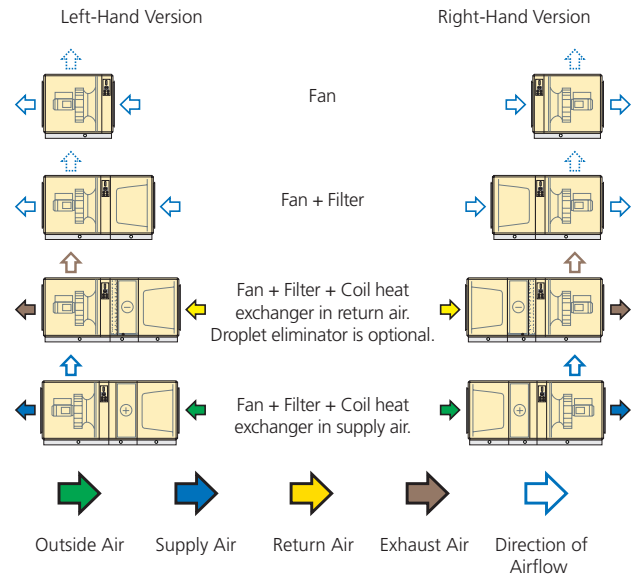

* The air handling unit is supplied without end connection panel if a duct accessory housed in an insulated casing will be connected.

** Width of coil heat exchanger (if required) = B + 7.9 inches.

Size	L1	L2	L3	B	H	A	C	D	E	F	G	I	J
SD 25	45.1	77.9	107	63	40.4	52.6	43	29.1	34.9	20	48	7.5	10.2

Airflow ERV	Airflow CWC	Fan Wgt (lbs)	Fan + Filter Wgt (lbs)	Fan + Filter + Coil Wgt (lbs)
5600 cfm	5260 cfm (based on 550 fpm)	530–590	726–840	1380–1500

Sizing, Installation, Dimensions and Weight

GOLD SD, size 30

DELIVERY AND TRANSPORT WITHIN THE SITE

The GOLD SD 30 units are available in right-hand or left-hand version as a fan section, fan + filter or fan + filter + coil heat exchanger.

The unit is always supplied as one unit. The air handling unit can be split at the building site to facilitate transporting it within the site. The sections are jointed together by means of bolts.

The GOLD SD can be used as a supply air or an return air handling unit. If both supply air and return air handling units are used in a ventilation system, the supply air unit is fitted with a control unit and the return air unit is without. A communication cable is used to connect them to one another making it possible to control both units.

The air handling unit is delivered on wooden pallets.

DUCT CONNECTION OPTIONS

A: Specify right-hand or left-hand version when ordering!

B: Specify fan outlet for upward air discharge when placing orders (not applicable to outdoor units).

CLEAR SPACE FOR INSPECTION

A clear space of 36 inches should be provided in front of the unit.

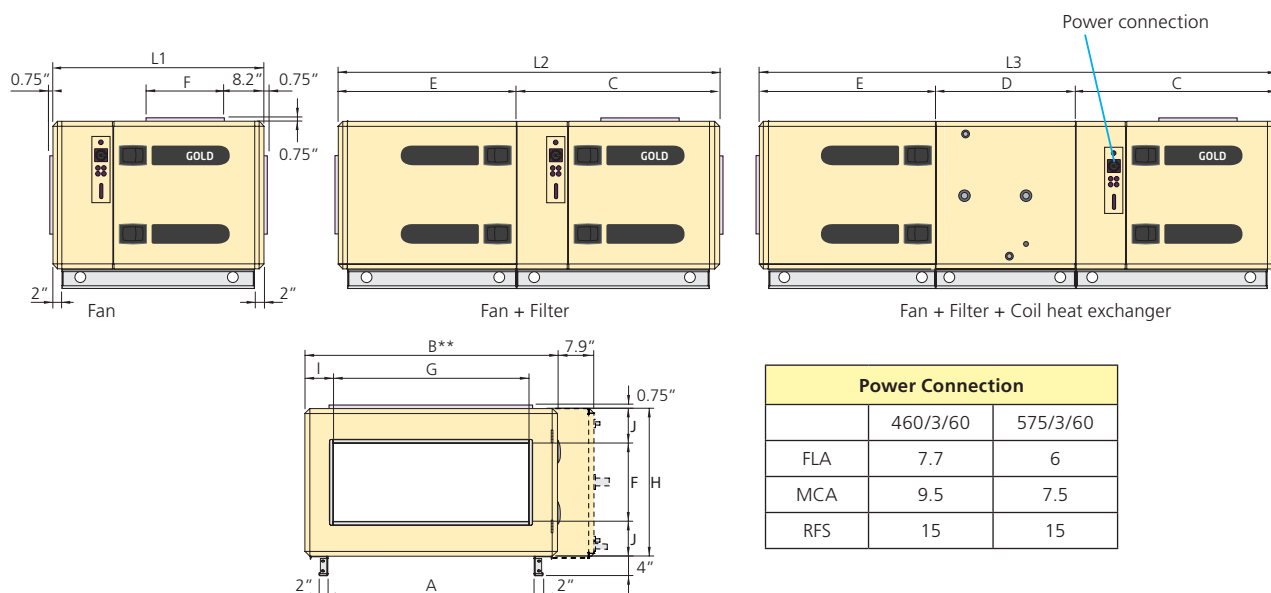
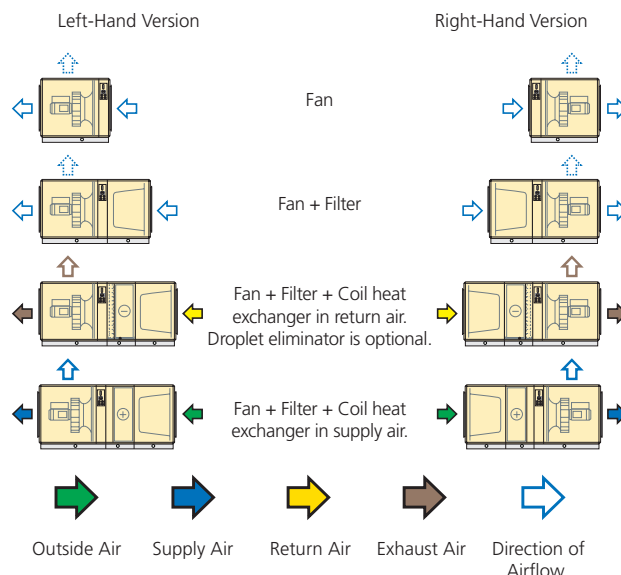

* The air handling unit is supplied without end connection panel if a duct accessory housed in an insulated casing will be connected.

** Width of coil heat exchanger (if required) = B + 7.9 inches.

Size	L1	L2	L3	B	H	A	C	D	E	F	G	I	J
SD 30	45.1	77.9	107	63	40.4	52.6	43	29.1	34.9	20	48	7.5	10.2

Airflow ERV	Airflow CWC	Fan Wgt (lbs)	Fan + Filter Wgt (lbs)	Fan + Filter + Coil Wgt (lbs)
8200 cfm	5260 cfm (based on 550 fpm)	575–635	770–885	1425–1540

Sizing, Installation, Dimensions and Weight

GOLD SD, size 35

DELIVERY AND TRANSPORT WITHIN THE SITE

The GOLD SD 35 units are available in right-hand or left-hand version as a fan section, fan + filter or fan + filter + coil heat exchanger.

The unit is always supplied as one unit. The air handling unit can be split at the building site to facilitate transporting it within the site. The sections are joined together by means of bolts.

The GOLD SD can be used as a supply air or an return air handling unit. If both supply air and return air handling units are used in a ventilation system, the supply air unit is fitted with a control unit and the return air unit is without. A communication cable is used to connect them to one another making it possible to control both units.

The air handling unit is delivered on wooden pallets.

Duct connection options

A: Specify right-hand or left-hand version when ordering!

B: Specify fan outlet for upward air discharge when placing orders (not applicable to outdoor units).

CLEAR SPACE FOR INSPECTION

A clear space of 36 inches should be provided in front of the unit.

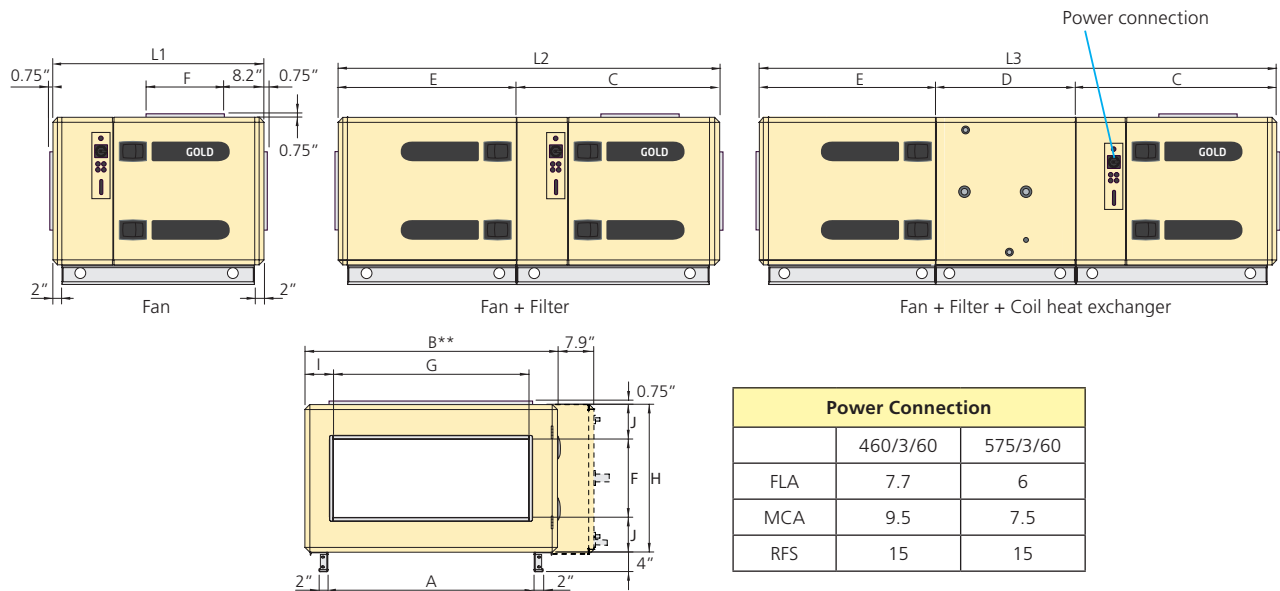
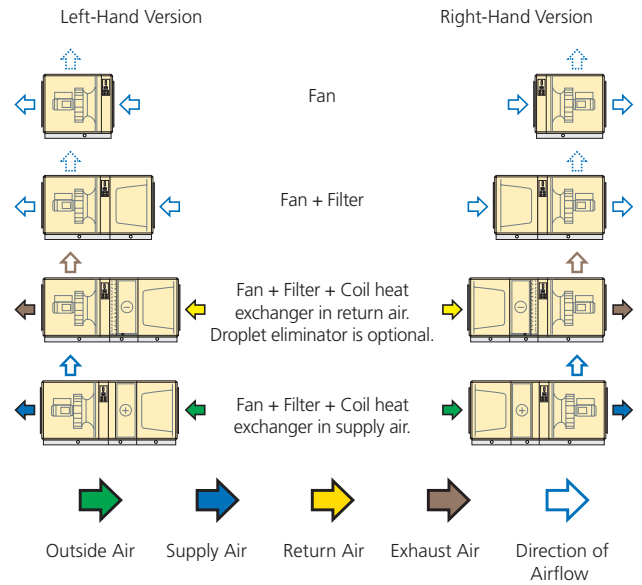

* The air handling unit is supplied without end connection panel if a duct accessory housed in an insulated casing will be connected.

** Width of coil heat exchanger (if required) = B + 7.9 inches.

Size	L1	L2	L3	B	H	A	C	D	E	F	G	I	J
SD 35	45.1	77.9	107	78.4	44.3	68	43	29.1	34.9	24	56	11.2	10.15

Airflow ERV	Airflow CWC	Fan Wgt (lbs)	Fan + Filter Wgt (lbs)	Fan + Filter + Coil Wgt (lbs)
8200 cfm	8200 cfm (based on 550 fpm)	695-770	920-1070	1750-1895

Sizing, Installation, Dimensions and Weight

GOLD SD, size 40

DELIVERY AND TRANSPORT WITHIN THE SITE

The GOLD SD 40 units are available in right-hand or left-hand version as a fan section, fan + filter or fan + filter + coil heat exchanger.

The unit is always supplied as one unit. The air handling unit can be split at the building site to facilitate transporting it within the site. The sections are joined together by means of bolts.

The GOLD SD can be used as a supply air or an return air handling unit. If both supply air and return air handling units are used in a ventilation system, the supply air unit is fitted with a control unit and the return air unit is without. A communication cable is used to connect them to one another making it possible to control both units.

The air handling unit is delivered on wooden pallets.

DUCT CONNECTION OPTIONS

- A:** Specify right-hand or left-hand version when ordering!
B: Specify fan outlet for upward air discharge when placing orders (not applicable to outdoor units).

CLEAR SPACE FOR INSPECTION

A clear space of 36 inches should be provided in front of the unit.

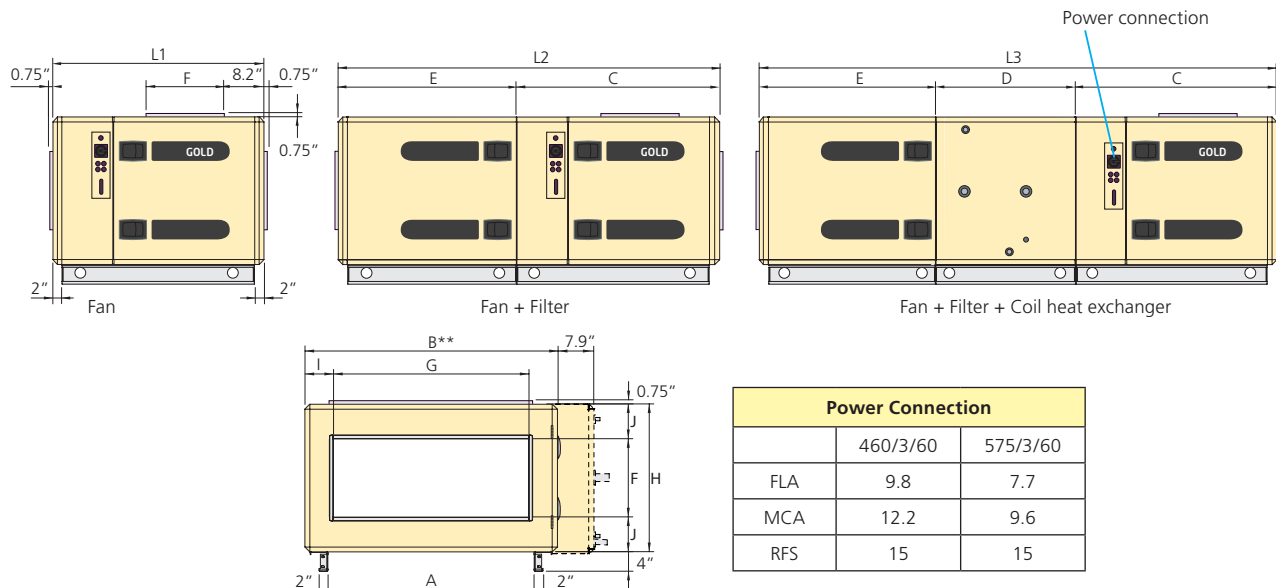
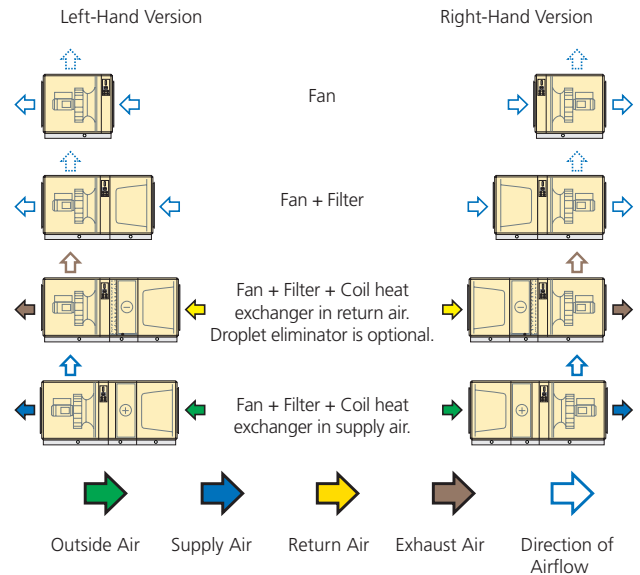

* The air handling unit is supplied without end connection panel if a duct accessory housed in an insulated casing will be connected.

** Width of coil heat exchanger (if required) = B + 7.9 inches.

Size	L1	L2	L3	B	H	A	C	D	E	F	G	I	J
SD 40	45.1	77.9	107	78.4	44.3	68	43	29.1	34.9	24	56	11.2	10.15

Airflow ERV	Airflow CWC	Fan Wgt (lbs)	Fan + Filter Wgt (lbs)	Fan + Filter + Coil Wgt (lbs)
10,200 cfm	8400 cfm (based on 550 fpm)	750–825	975–1125	1800–1950

Sizing, Installation, Dimensions and Weight

GOLD SD, size 50

DELIVERY AND TRANSPORT WITHIN THE SITE

The GOLD SD 50 units are available in right-hand or left-hand version as a fan section, fan + filter or fan + filter + coil heat exchanger.

The unit is always supplied as one unit. The air handling unit can be split at the building site to facilitate transporting it within the site. The sections are joined together by means of bolts.

The GOLD SD can be used as a supply air or an return air handling unit. If both supply air and return air handling units are used in a ventilation system, the supply air unit is fitted with a control unit and the return air unit is without. A communication cable is used to connect them to one another making it possible to control both units.

The unit is supplied on 4 inch high support feet made of steel.

DUCT CONNECTION OPTIONS

A: Specify right-hand or left-hand version when ordering!

B: Specify fan outlet for upward air discharge when placing orders (not applicable to outdoor units).

CLEAR SPACE FOR INSPECTION

A clear space of 44 inches should be provided in front of the unit.

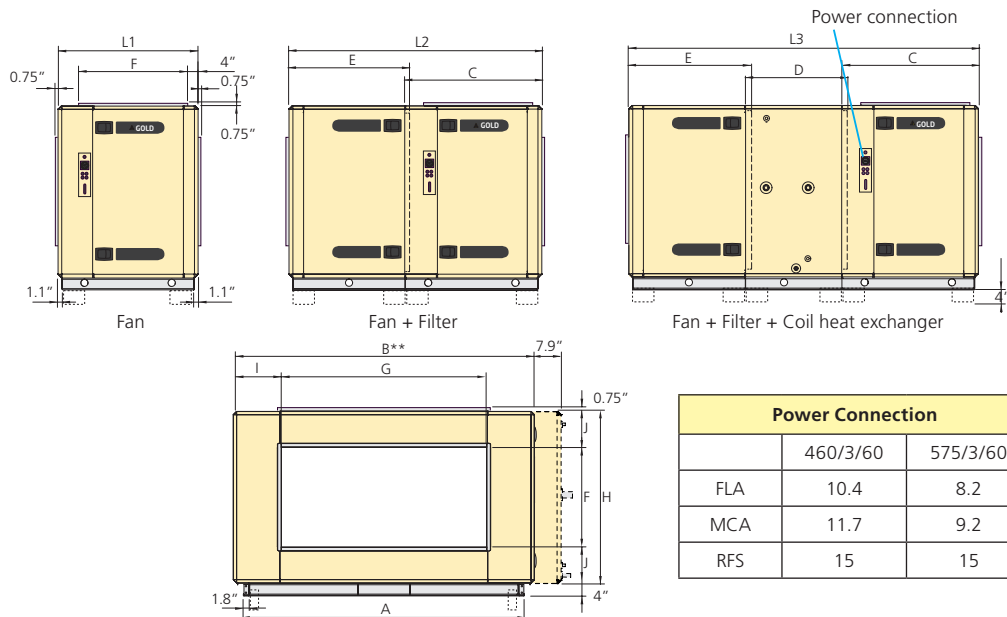
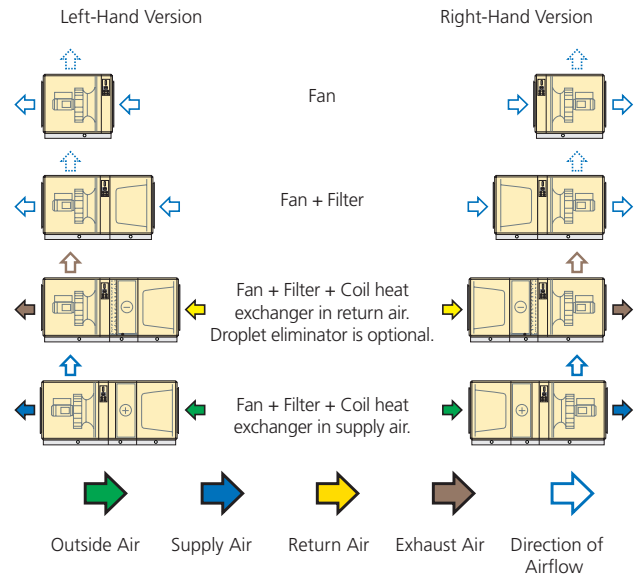

* The air handling unit is supplied without end connection panel if a duct accessory housed in an insulated casing will be connected.

** Width of coil heat exchanger (if required) = B + 7.9 inches.

Size	L1	L2	L3	B	H	A	C	D	E	F	G	I	J
SD 50	42.2	76.6	105.8	85.3	91.3	52	41.3	30	36.2	32	64	13.65	4.65

Airflow ERV	Airflow CWC	Fan Wgt (lbs)	Fan + Filter Wgt (lbs)	Fan + Filter + Coil Wgt (lbs)
11,000 cfm	10,800 cfm (based on 550 fpm)	835-825	975-1125	1800-1950

Sizing, Installation, Dimensions and Weight

GOLD SD, size 60

DELIVERY AND TRANSPORT WITHIN THE SITE

The GOLD SD 60 units are available in right-hand or left-hand version as a fan section, fan + filter or fan + filter + coil heat exchanger.

The unit is always supplied as one unit. The air handling unit can be split at the building site to facilitate transporting it within the site. The sections are jointed together by means of bolts.

The GOLD SD can be used as a supply air or an return air handling unit. If both supply air and return air handling units are used in a ventilation system, the supply air unit is fitted with a control unit and the return air unit is without. A communication cable is used to connect them to one another making it possible to control both units.

The unit is supplied on 4 inch high support feet made of steel.

DUCT CONNECTION OPTIONS

A: Specify right-hand or left-hand version when ordering!

B: Specify fan outlet for upward air discharge when placing orders (not applicable to outdoor units).

CLEAR SPACE FOR INSPECTION

A clear space of 44 inches should be provided in front of the unit.

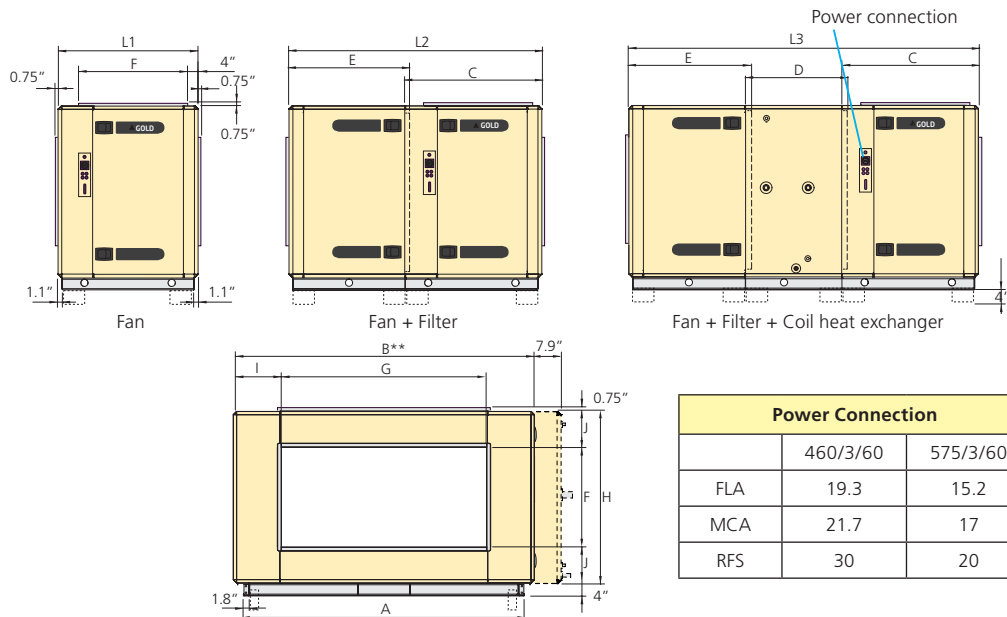
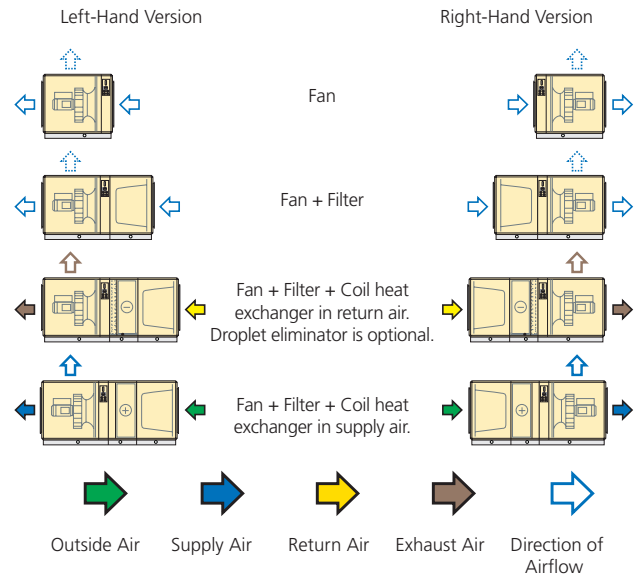

* The air handling unit is supplied without end connection panel if a duct accessory housed in an insulated casing will be connected.

** Width of coil heat exchanger (if required) = B + 7.9 inches.

Size	L1	L2	L3	B	H	A	C	D	E	F	G	I	J
SD 60	42.2	76.6	105.8	85.3	52	52	41.3	30	36.2	32	64	13.65	4.65

Airflow ERV	Airflow CWC	Fan Wgt (lbs)	Fan + Filter Wgt (lbs)	Fan + Filter + Coil Wgt (lbs)
16,250 cfm	10,800 cfm (based on 550 fpm)	925-990	1300-1455	2495-2630

Sizing, Installation, Dimensions and Weight

GOLD SD, size 70

DELIVERY AND TRANSPORT WITHIN THE SITE

The GOLD SD 70 units are available in right-hand or left-hand version as a fan section, fan + filter or fan + filter + coil heat exchanger.

The air handling units are supplied as one unit if they each consist of a fan or fan+filter. If the unit consists of a fan + filter + coil heat exchanger, it is supplied as two units. The one unit then consists of a fan + coil heat exchanger and the other unit consists of a filter.

The sections are jointed together by means of bolts.

The GOLD SD can be used as a supply air or an return air handling unit. If both supply air and return air handling units are used in a ventilation system, the supply air unit is fitted with a control unit and the return air unit is without. A communication cable is used to connect them to one another making it possible to control both units.

The unit is supplied on 4 inch high support feet made of steel.

DUCT CONNECTION OPTIONS

A: Specify right-hand or left-hand version when ordering!

B: Specify fan outlet for upward air discharge when placing orders (not applicable to outdoor units).

CLEAR SPACE FOR INSPECTION

A clear space of 44 inches should be provided in front of the unit.

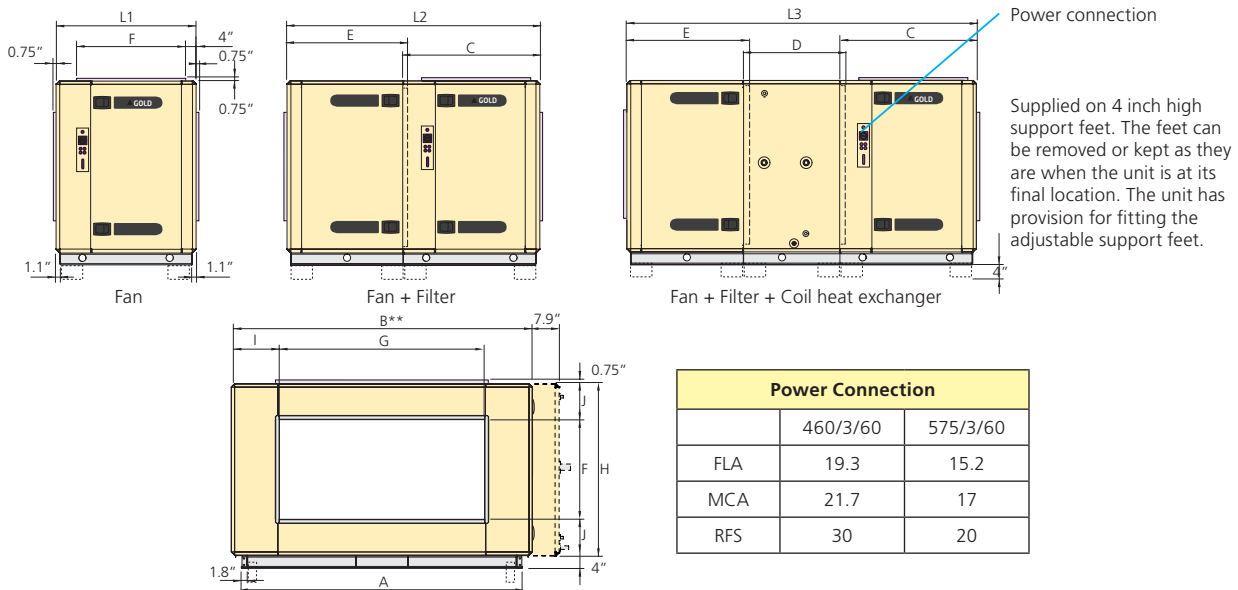
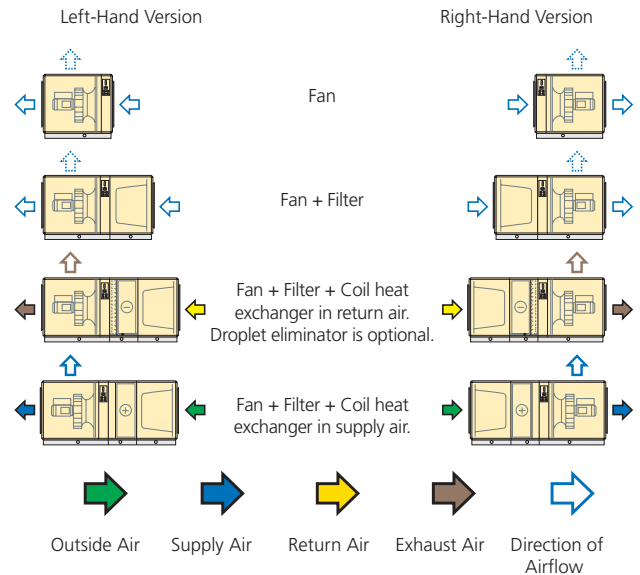

* The air handling unit is supplied without end connection panel if a duct accessory housed in an insulated casing will be connected.

** Width of coil heat exchanger (if required) = B + 7.9 inches.

Size	L1	L2	L3	B	H	A	C	D	E	F	G	I	J
SD 70	52.2	100.4	135.9	97.8	103.8	52	50.2	35.5	50.2	40	72	15.9	6

Airflow ERV	Airflow CWC	Fan Wgt (lbs)	Fan + Filter Wgt (lbs)	Fan + Filter + Coil Wgt (lbs)
16,200 cfm	15,200 cfm (based on 550 fpm)	1215-1300	1725-1890	3440-3610

Sizing, Installation, Dimensions and Weight

GOLD SD, size 80

DELIVERY AND TRANSPORT WITHIN THE SITE

The GOLD SD 80 units are available in right-hand or left-hand version as a fan section, fan + filter or fan + filter + coil heat exchanger.

The air handling units are supplied as one unit if they each consist of a fan or fan+filter. If the unit consists of a fan + filter + coil heat exchanger, it is supplied as two units. The one unit then consists of a fan + coil heat exchanger and the other unit consists of a filter. The air handling unit can be split at the building site to facilitate transporting it within the site.

The sections are jointed together by means of bolts.

The GOLD SD can be used as a supply air or an return air handling unit. If both supply air and return air handling units are used in a ventilation system, the supply air unit is fitted with a control unit and the return air unit is without. A communication cable is used to connect them to one another making it possible to control both units. The unit is supplied on 4 inch high support feet made of steel.

DUCT CONNECTION OPTIONS

A: Specify right-hand or left-hand version when ordering!

B: Specify fan outlet for upward air discharge when placing orders (not applicable to outdoor units).

CLEAR SPACE FOR INSPECTION

A clear space of 44 inches should be provided in front of the unit.

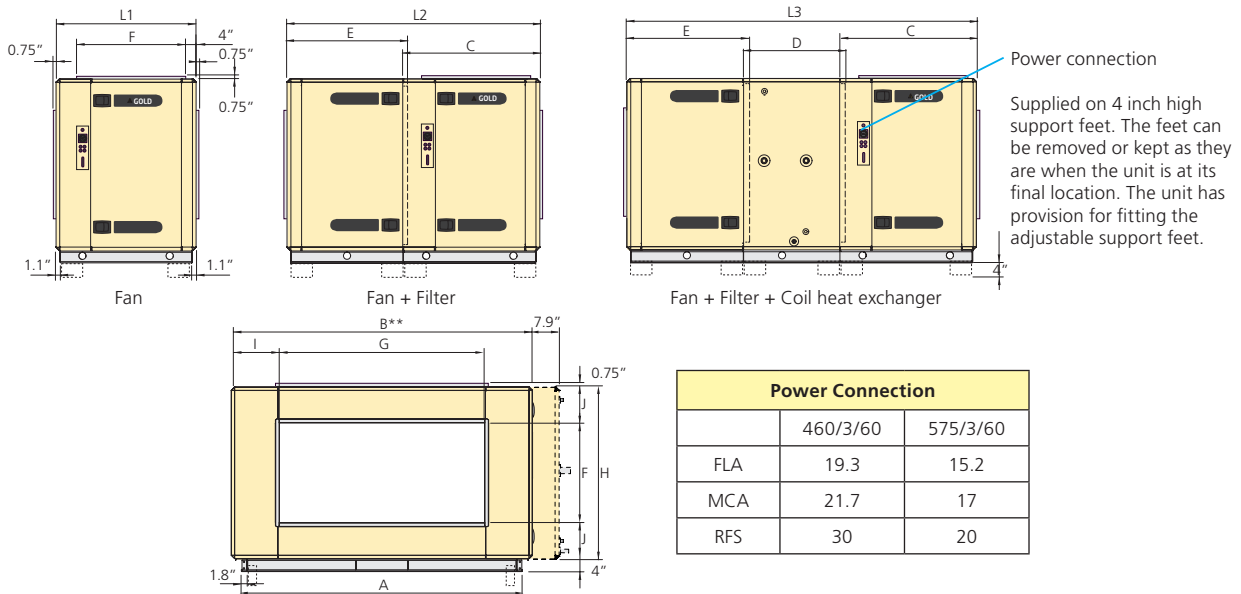
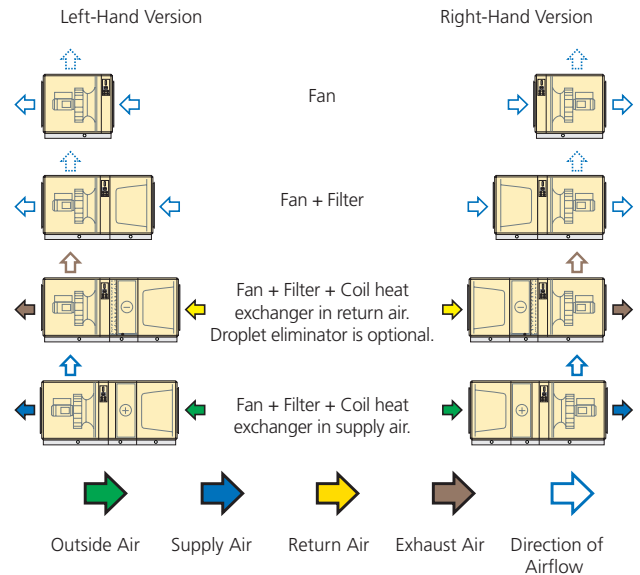

* The air handling unit is supplied without end connection panel if a duct accessory housed in an insulated casing will be connected.

** Width of coil heat exchanger (if required) = B + 7.9 inches.

Size	L1	L2	L3	B	H	A	C	D	E	F	G	I	J
SD 80	52.2	100.4	135.9	97.8	103.8	52	50.2	35.5	50.2	40	72	15.9	6

Airflow ERV	Airflow CWC	Fan Wgt (lbs)	Fan + Filter Wgt (lbs)	Fan + Filter + Coil Wgt (lbs)
23,500 cfm	15,200 cfm (based on 550 fpm)	1325-1410	1835-2000	3550-3720

GOLD NA

Frequently Asked Questions

Is the GOLD AHU a new product?

Swegon has been producing GOLD for over 25 years and produces over 8000 units per years.

Where is the GOLD built and shipped from?

GOLD is produced in North America and Europe.

Do you stock parts for the unit in North America?

Yes. We can get parts to customers in 24 hours.

Do you have Passive House Certified units?

Yes, Certain RX models can be Passive House certified.

Is the enthalpy wheel AHRI 1060 certified?

Yes.

Are the coils AHRI 410 certified?

Yes. All coils are sourced in North America and will be AHRI 410 certified where applicable.

Are the fans AMCA certified?

No. GOLD fans were designed by Swegon R and D to be used in the GOLD cabinet. They are only available in Swegon GOLD units so a general fan performance listing is not available. The GOLD units are Eurovent certified with fan data based on the fans installed in the cabinet. This is better as the fan tests are based on how the fans are actually applied.

Are GOLD units UL certified?

Yes. GOLD ERV units are UL 1812 certified and GOLD units with coils are UL 1995 certified.

Is electric heat available?

Yes, consult factory.

Is gas heat available?

No. A 0-10Vdc signal can be provided to operate gas heat duct furnace by others.

Is integral DX available?

No. GOLD units can include a DX coil for field installation to a VRF or condensing unit.

Do you offer enthalpy plates?

No. GOLD PX units have two efficiency levels of sensible aluminium plate HX.

Can the GOLD be mounted outdoors?

Can it be mounted on a curb?

Yes, the GOLD unit has an outdoor kit that allows outdoor installation. It is not designed to sit on a curb and does not have downshot air connections.

What voltages are available?

GOLD units from 14 to 80 are available in 460/3/60 and 575/3/60. Size 11 and under are available in 220/1/60. 208/3/60 requires a field transformer.

Where can I find what cfm ranges you offer?

Refer to GOLD Selling Qualifications.

What is the maximum E.S.P. GOLD can handle?

The GOLD unit can develop about 2 in. w.c. Ext. Static pressure depending on the internal pressure drop. Consult factory for a specific selection.

Can I get side-by-side air paths?

GOLD units are over-under only so all the service can be done from one side.

Can the SD unit be supplied with a mixing box and economizer controls?

No. The SD is only for 100% outdoor air applications.

Is the GOLD unit casing foam injected?

No. GOLD units use double wall construction with roxul insulation for optimized acoustical performance.

Do you have cabinet leakage rating?

Current available data is based on Eurovent standard. Consult factory.

Can I get a unit with no controls?

No. All GOLD units ship with controls.

Can I use other filter types?

Yes, as long as they fit securely in the filter rack.

Why do you use a stepper motor instead of VFD for wheel?

Stepper motors allow the rotor to operate down to 1 rpm for precise energy transfer control.

Does the rotor have a VFD?

Yes, the GOLD IQLogic controller modulates the rotor speed for optimum energy performance and to minimize frosting in cold weather.

Do the fans have VFD's?

Yes. The fans are direct drive mixed flow plenum type with permanent magnet synchronous (EC) motors.

What are your capabilities for frost control?

GOLD RX units can control on either exhaust air drybulb or exhaust air dewpoint.

What communication protocols do you offer?

BACnet (BTL Certified), Lonmark, Modbus, Johnson N2.

How long does it take to start-up a GOLD unit?

GOLD units include a commissioning tool and can usually be commissioned in 2 hours.

Can the fans be easily serviced?

Yes. The fans have quick disconnect electrical and mechanical hardware. A fan can be removed in minutes.

